

COMPONENTS

ILLUSTRATION

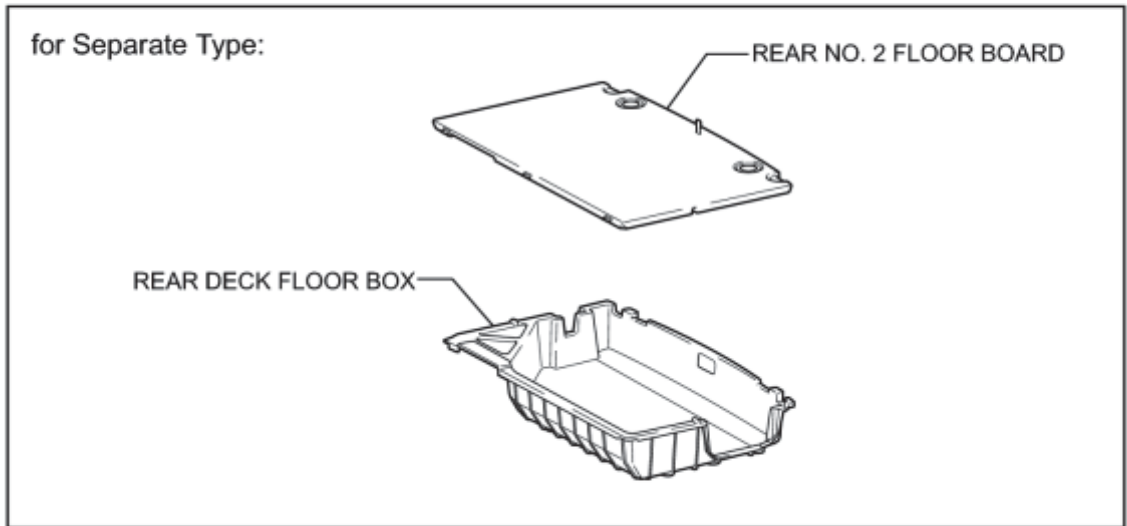
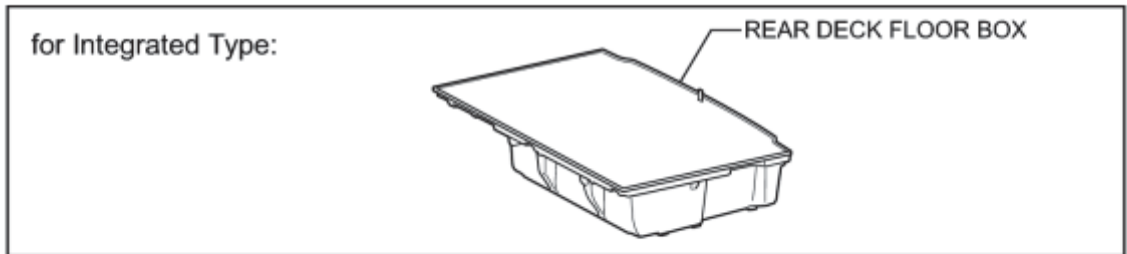

P

ILLUSTRATION

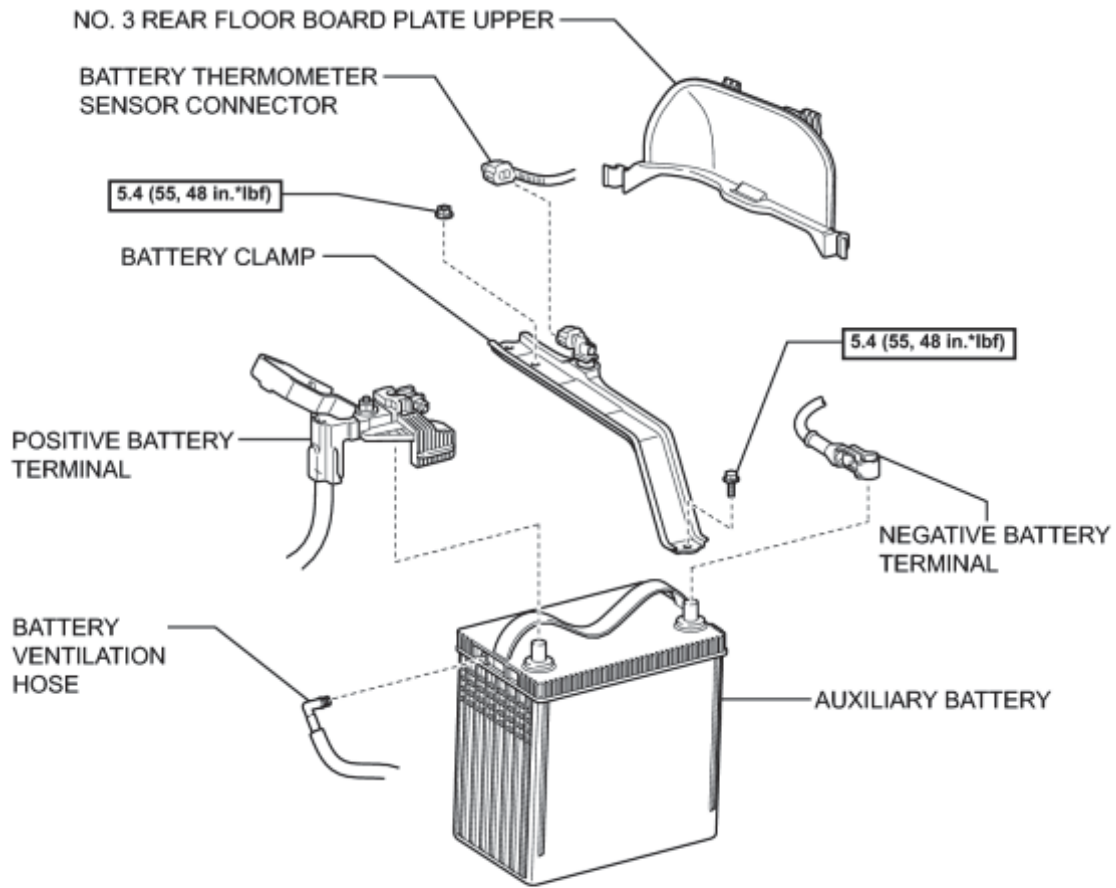

N*m (kgf*cm, ft.*lbf): Specified torque

c

ON-VEHICLE INSPECTION

1. CHECK AUXILIARY BATTERY VOLTAGE

NOTICE:

If the battery is fully depleted or "READY" does not light up, recharge the battery. Check the battery again before the vehicle is returned to the customer.

(a) Check the battery for damage and deformation. If severe damage, deformation or leakage is found, replace the battery.

(b) Check the voltage.

(1) Turn the power switch off and turn on the headlights for 20 to 30 seconds. This will remove the surface charge from the battery.

(2) Measure the battery voltage according to the value(s) in the table below.

Standard Voltage:

Tester Connection	Condition	Specified Condition
Positive (+) terminal - Negative (-) terminal	20°C (68°F)	12.5 to 12.9 V

If the voltage is not as specified, charge the battery.

2. CHECK BATTERY TERMINAL

(a) Check that the battery terminals are not loose or corroded.

If the terminals are corroded, clean them.

3. CHECK FUSES

(a) Measure the resistance of each fuse for the auxiliary battery charging system.

Standard resistance:

Below 1 Ω

- If any of the results is not as specified, replace the fuse(s) as necessary.

4. CHECK AUXILIARY BATTERY VENTILATION HOSE

(a) Make sure that the hose is not kinked.

REMOVAL

1. REMOVE REAR NO. 2 FLOOR BOARD (for Separate Type) INFO

2. REMOVE REAR DECK FLOOR BOX INFO

3. REMOVE REAR NO. 3 FLOOR BOARD INFO

4. DISCONNECT CABLE FROM NEGATIVE BATTERY TERMINAL

NOTICE:

When disconnecting the cable, some systems need to be initialized after the cable is reconnected INFO.

5. REMOVE AUXILIARY BATTERY



(a) Disengage the 2 claws and remove the No. 3 rear floor board plate upper.

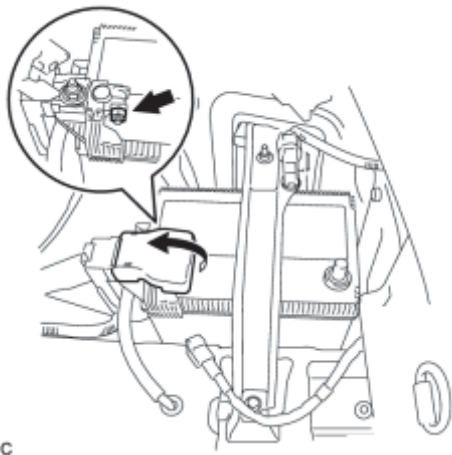

(b) Open the battery terminal cap.

(c) Loosen the nut, and disconnect the positive (+) battery terminal.

(d) Remove the nut and bolt.

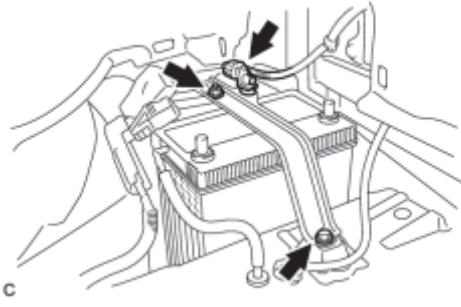

(e) Remove the battery thermometer sensor connector.

(f) Remove the battery clamp.

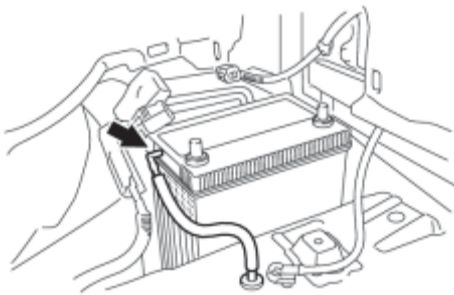

(g) Disconnect the battery ventilation hose.

(h) Remove the battery.

INSTALLATION

1. INSTALL AUXILIARY BATTERY

(a) Install the battery.

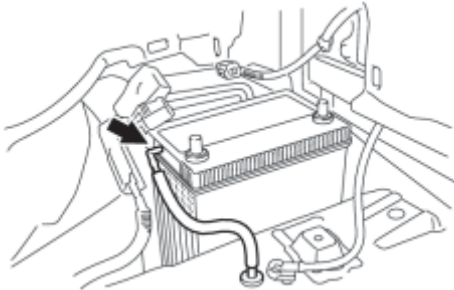

(b) Connect the battery ventilation hose to the battery without kinking it.

HINT:

Push in the battery ventilation hose to the battery until a click sound is heard.

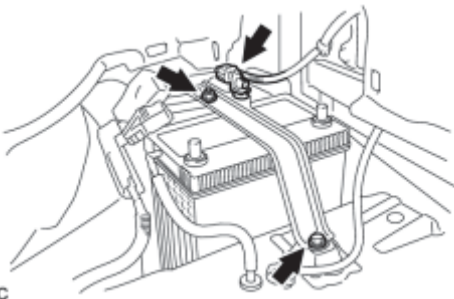

(c) Install the battery clamp with the bolt and nut.

Nut - Torque: **5.4 N·m (55 kgf·cm, 48in·lbf)**

Bolt - Torque: **5.4 N·m (55 kgf·cm, 48in·lbf)**

c

(d) Install the battery thermometer sensor connector

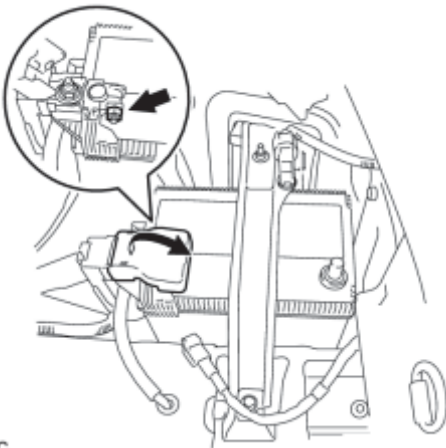

(e) Connect the positive (+) battery terminal with the nut.

c

(f) Install the battery terminal cap.

(g) Engage the 2 claws to install the No. 3 rear floor board plate upper.



2. CONNECT CABLE TO NEGATIVE BATTERY TERMINAL

NOTICE:

When disconnecting the cable, some systems need to be initialized after the cable is reconnected INFO.

3. INSTALL REAR NO. 3 FLOOR BOARD INFO

4. INSTALL REAR DECK FLOOR BOX INFO

5. INSTALL REAR NO. 2 FLOOR BOARD (for Separate Type) INFO