

Part Number: PT948-47160-02

Kit Contents

| Item # | Quantity Reqd. | Description |
|--------|----------------|---------------------------|
| 1 | 1 | Console Applique |
| 2 | 1 | Front Face Cover Applique |
| 3 | | |
| | | |

Hardware Bag Contents

| Item # | Quantity Reqd. | Description |
|--------|----------------|-------------|
| 1 | | |
| 2 | | |
| 3 | | |
| | | |

Additional Items Required For Installation

| Item # | Quantity Reqd. | Description |
|--------|----------------|-------------|
| 1 | | |
| 2 | | |
| 3 | | |
| | | |

Conflicts

| |
|--------------------------------------|
| Vehicles without Qi Wireless Charger |
|--------------------------------------|

Recommended Tools

| Personal & Vehicle Protection | Notes |
|--|---------------------------------------|
| | |
| | |
| | |
| | |
| Special Tools | Notes |
| Surface Thermometer | Infrared Non-contact |
| Heat Gun | Master Heat Gun HG-301A or equivalent |
| | |
| Installation Tools | Notes |
| Heat source | If Needed |
| Lint-free scratch resistant cloth | |
| Scissors | |
| | |
| Special Chemicals | Notes |
| Cleaner | VDC Approved cleaner |
| | |
| | |

General Applicability

| |
|--|
| 2016 and newer Toyota Prius with Qi Wireless Charger |
|--|

Recommended Sequence of Application







| Item # | Accessory |
|--------|----------------------------|
| 1 | Console Applique* |
| 2 | Front Face Cover Applique* |
| | |
| | |

*Mandatory

Vehicle Service Parts (may be required for reassembly)

| Item # | Quantity Reqd. | Description |
|--------|----------------|-------------|
| 1 | | |
| 2 | | |
| 3 | | |
| | | |

Legend

| | |
|---|--|
|  | STOP: Damage to the vehicle may occur. Do not proceed until process has been complied with. |
|  | OPERATOR SAFETY: Use caution to avoid risk of injury. |
|  | CAUTION: A process that must be carefully observed in order to reduce the risk of damage to the accessory/vehicle and to ensure a quality installation. |
|  | TOOLS & EQUIPMENT: Used in Figures calls out the specific tools and equipment recommended for this process. |
|  | REVISION MARK: This mark highlights a change in installation with respect to previous issue. |
|  | SAFETY TORQUE: This mark indicates that torque is related to safety. |

Care must be taken when installing this accessory to ensure damage does not occur to the vehicle. The installation of this accessory should follow approved guidelines to ensure a quality installation.

These guidelines can be found in the "Accessory Installation Practices" document.

This document covers such items as:-

- Vehicle Protection (use of covers and blankets, cleaning chemicals, etc.).
- Safety (eye protection, rechecking torque procedure, etc.).
- Vehicle Disassembly/Reassembly (panel removal, part storage, etc.).
- Electrical Component Disassembly/Reassembly (battery disconnection, connector removal, etc.).

Please see your Toyota dealer for a copy of this document.

1. Prepare for the Installation.

-  (a) Inspect the kit for contents and damage (Fig. 1-1).

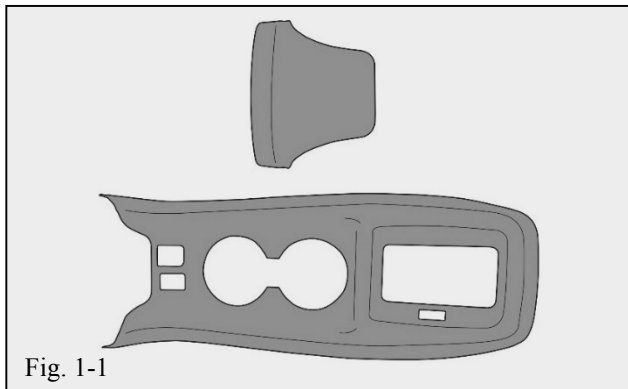

- (b) Open the arm rest door.
- (c) Remove the upper console panel sub-assembly (Fig. 1-2).

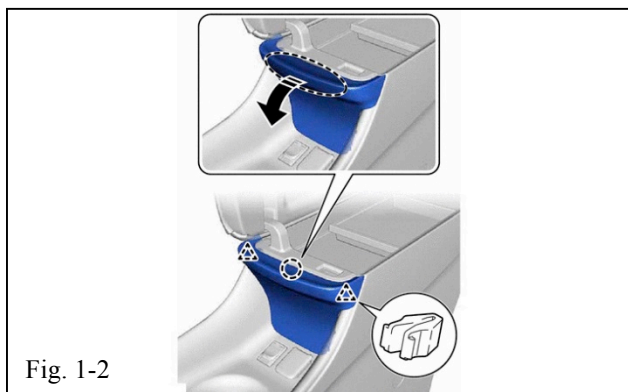

- (d) Use a molding remover to disengage the 12 clips and 2 guides (Fig. 1-3).

-  **NOTE:** Do not unplug any connectors or remove the part from the vehicle. Perform the following steps seated in the vehicle.

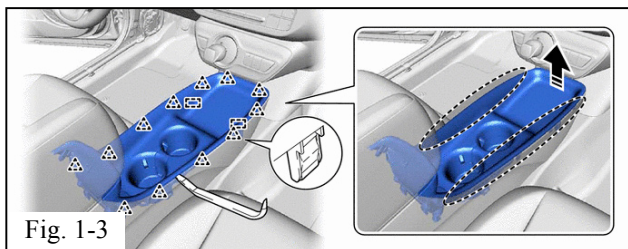

- (e) Place a cloth over the opening.

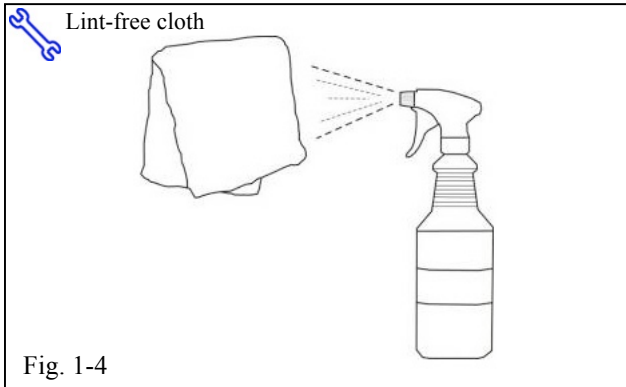



Fig. 1-4

- ⚠ (f) Thoroughly clean all installation surfaces.
 - (1) Always use a clean lint-free scratch resistant cloth.
 - (2) Shake the VDC approved cleaner well.
- (g) Apply VDC approved cleaner directly to the cloth. Do not spray cleaning solutions directly onto the part (Fig. 1-4).
- (h) Clean the surface thoroughly and wipe dry immediately with a clean cloth. Do not allow the cleaner to air dry.
- ⚠ (i) Apply water to a clean cloth. Clean the surface thoroughly to ensure any VDC approved cleaner is completely removed. Wipe dry with a clean cloth.
- ⚠ (j) The vehicle **installation surface and applique** must be between **70°F (21°C) and 110°F (43°C)** at the time of installation.
- ⚠ **NOTE:** A heat source may be used to reach minimum temperature if necessary.
- ⚠ (k) Before removing any adhesive liner on the back of the parts, align each part and confirm that the fit is correct.

2. Install the Console Applique.

 (a) Prepare the tape liner pull-tabs.

- (1) Prepare, but do not remove, the three outside perimeter tape liner pull-tabs by folding them over the outside perimeter and create a crease in the fold.
- (2) Use masking tape to temporarily hold the tape liner pull-tabs to the top side of the part (Fig. 2-1).
- (3) Prepare, but do not remove, the three pull-tabs surrounding the wireless charging area by folding over and positioning the pull tabs through the main wireless charging hole and create a crease in the fold.
- (4) Use masking tape to temporarily hold the tape liner pull tabs to the top side of the part (Fig. 2-2).

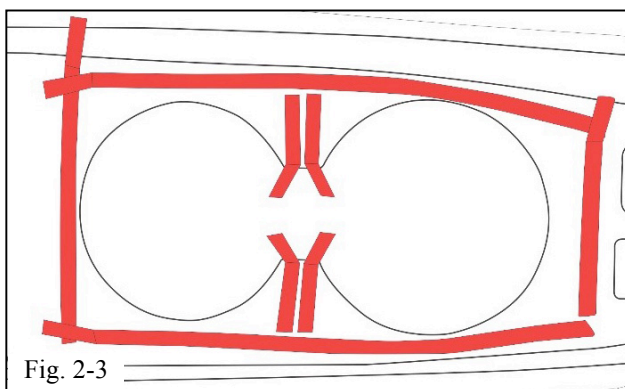
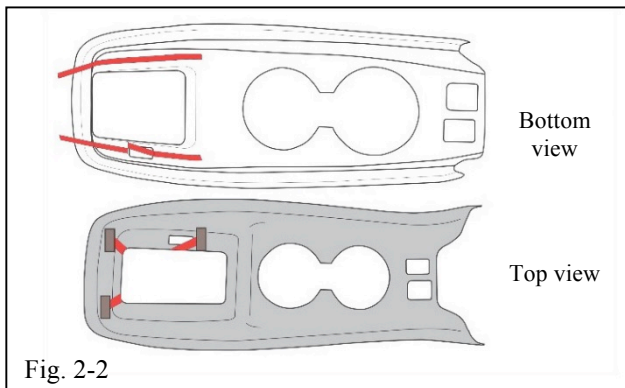
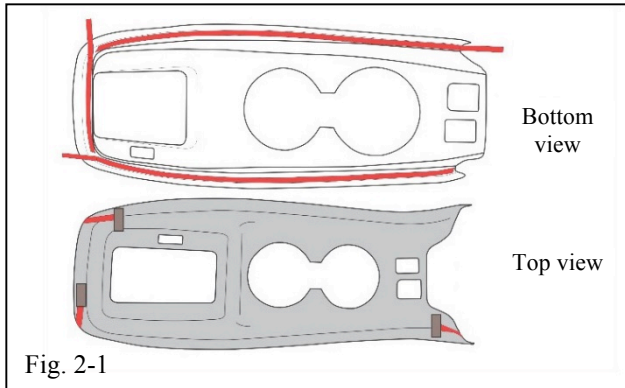

- (b) Prior to installation, remove the adhesive liner on the back of the part that surrounds the cup holder area (Fig. 2-3).

 **NOTE:** Be sure not to touch any of the adhesive backing.

- (c) Open the “12v/120w” door and position the door through the corresponding hole on the applique. **Gently pull the applique rearward** toward the arm rest to align the “USB” and “12v/120w” plug.

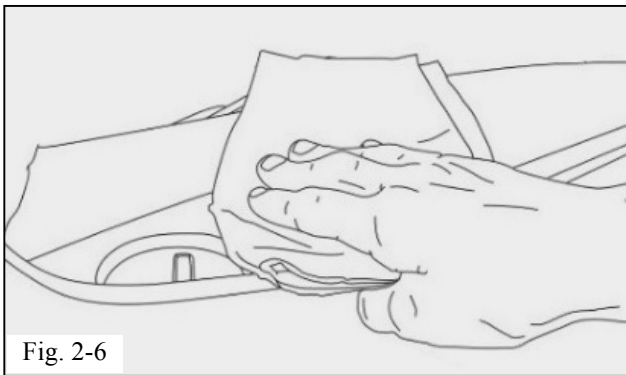
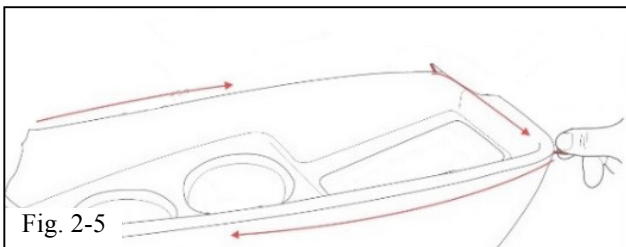
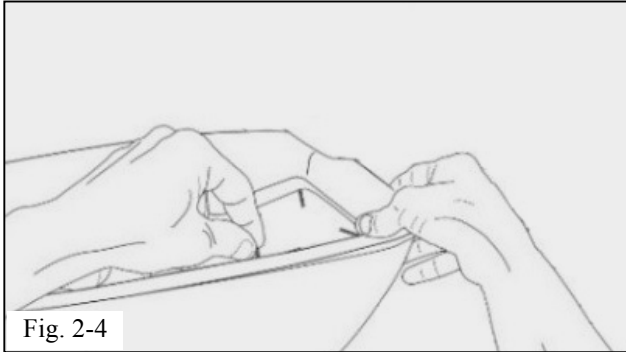

(d) Confirm the “USB” and “12v/120w” doors and the cup holders are aligned, then adhere the tape surrounding the cup holder by pressing lightly, while positioning rearward.

 (e) Hold the front of the part off of the console and carefully pull the pull-tabs through the wireless charging hole to remove the three tape liners and masking tape from the wireless charging area (Fig. 2-4).

(f) Align the left, right, front and back sides of the charger and charging power button and adhere the newly exposed tape by pressing the applique lightly to the console.

 (g) Carefully pull the three outside perimeter tape liner pull tabs and masking tape (shown in Fig. 2-1) and press firmly with a clean, dry cloth to adhere the outside perimeter tape (Fig. 2-5 & Fig. 2-6).

(h) Confirm that all holes are aligned and that the 12v/120w & USB doors function properly.

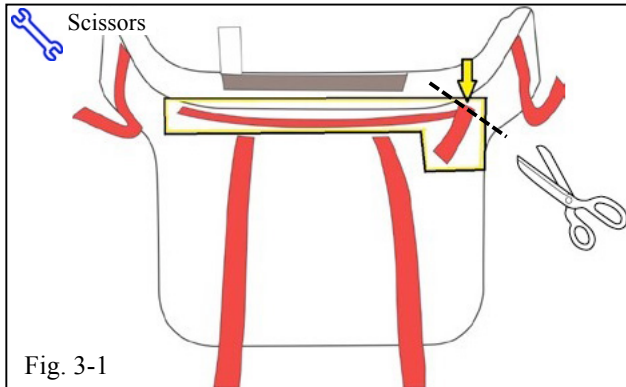

Fig. 3-1

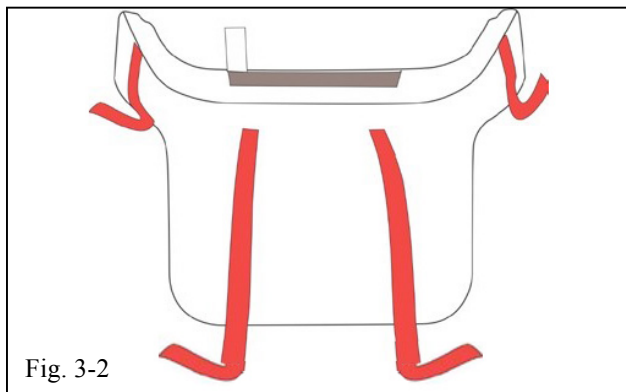

Fig. 3-2

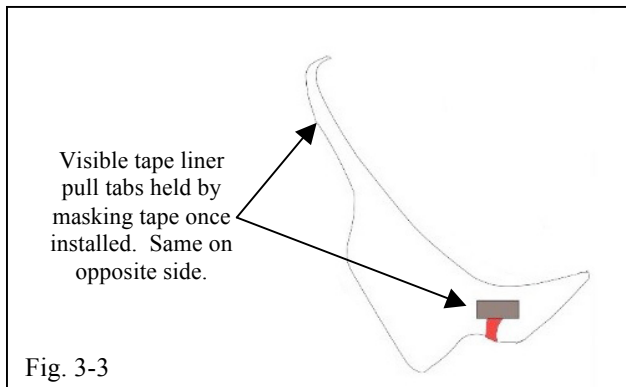

Fig. 3-3

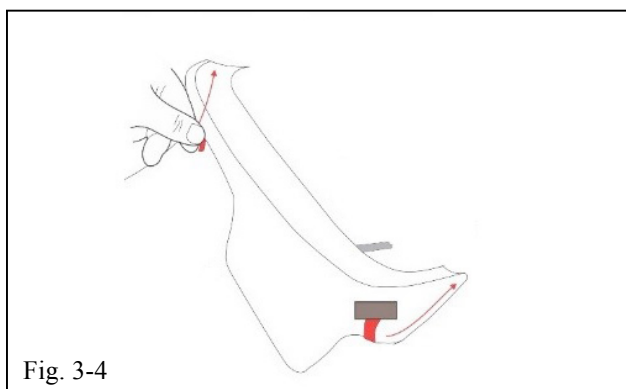

Fig. 3-4

3. Install the Front Face Cover Applique.

- (a) Determine if the Front Face Cover Applique has the horizontal piece of tape highlighted in Fig. 3-1. If the tape is not applied the part will look like Fig. 3-2.
- (b) If the tape is present, use a pair of scissors to carefully cut the adhesive **pull tab** to remove it. This tape liner will not be removed during the installation.



- (c) Prepare the tape liner pull-tabs.
 - (1) Prepare, but do not remove, the tape liner pull-tabs of the part by folding over the outside of the part and creating a crease in the fold.

- (2) Use masking tape to temporarily hold the tape liner pull-tabs to the front side of the part (Fig. 3-3 & Fig. 3-4).



- (d) Align the top portion of the applique by pressing down and rearward while holding the lower portion off of the core part to prevent premature adhesion.
- (e) While pressing down and rearward, carefully remove the two outer tape liners and masking tape, then press the areas lightly to adhere the part (Fig. 3-4).
- (f) Carefully remove the two inner tape liners, then press the areas lightly to adhere the part.

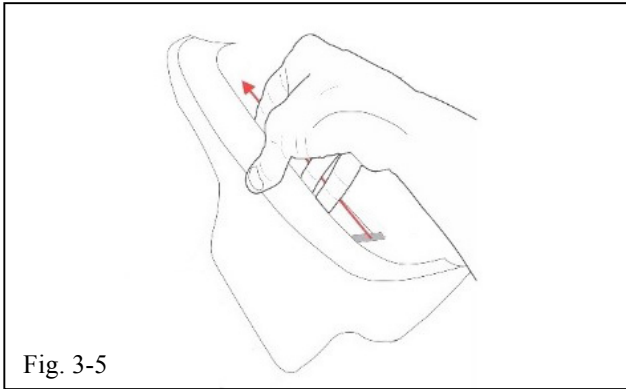

Fig. 3-5

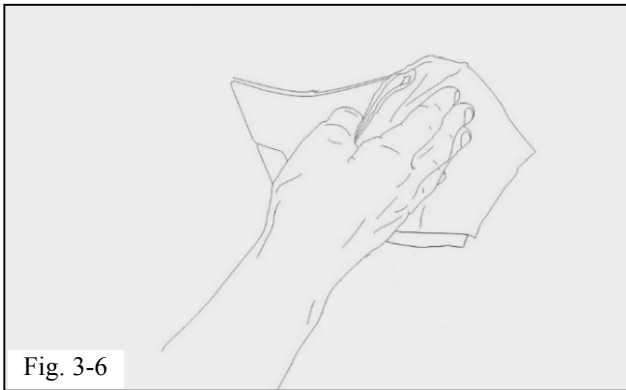



Fig. 3-6

- (g)  Carefully remove the tape liner on the top portion of the applique by pressing down on the front edge and pulling the rear edge up to gain access to the hidden liner. Once the liner is removed, press the area to adhere the part (Fig. 3-5).

- (h) Confirm all areas of applique are aligned, then press firmly with a clean, dry cloth to all areas to ensure the tape adhesion areas are making full contact (Fig. 3-6).

4. Finish the Installation.

- (a) Engage the 2 guides and 12 clips to reinstall the upper console panel sub-assembly (Fig. 4-1).

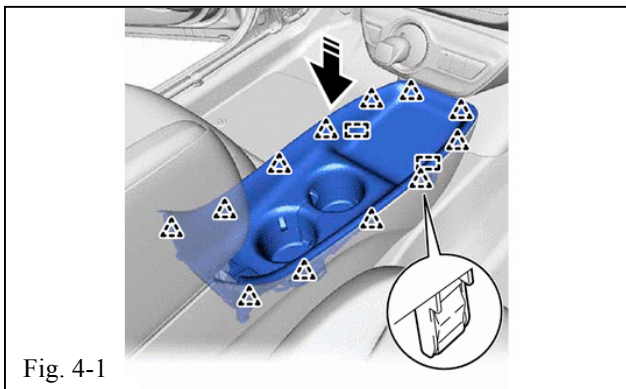
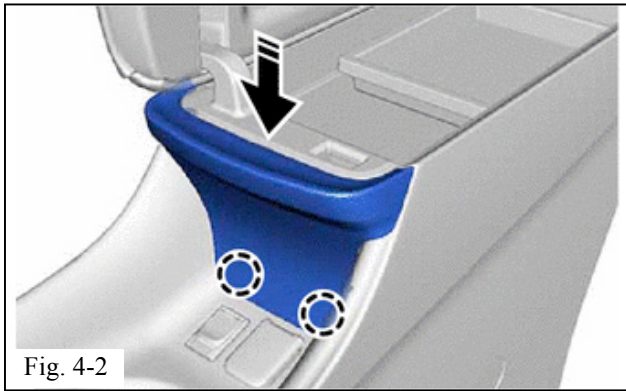
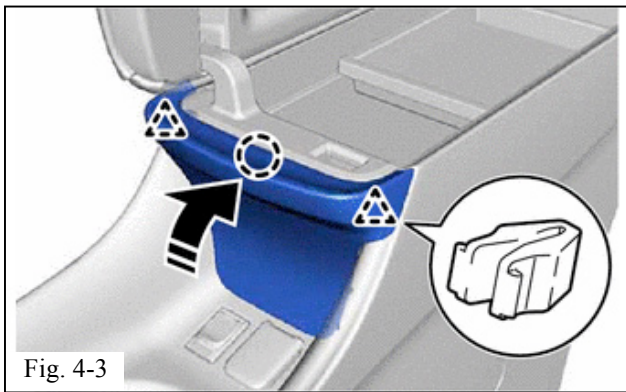

Fig. 4-1



(b) Engage the 2 clips and claw to reinstall the No. 1 upper box plate (Fig. 4-2 & Fig. 4-3).



TOYOTA PRIUS 2016 - CONSOLE APPLIQUES
Checklist - these points **MUST** be checked to ensure a quality installation.

| <u>Check:</u> | <u>Look For:</u> |
|---|--|
| <p><u>Accessory Function Checks</u></p> <ul style="list-style-type: none"><input type="checkbox"/> Console applique – Adhesive<input type="checkbox"/> Front face cover applique – Adhesive<input type="checkbox"/> Console applique - Alignment<input type="checkbox"/> Front face cover applique - Alignment | <p>Appliques should be securely adhered to the factory part.</p> <p>Edges of appliques should be flush to edges of factory part, +/- 2mm and interior spacing between applique and factory part should be uniform.</p> |
| <p><u>Vehicle Function Checks</u></p> <ul style="list-style-type: none"><input type="checkbox"/> 12v/120w & USB Door operation<input type="checkbox"/> Arm rest door closes properly | <p>Applique should not interfere with the movement of any doors.</p> |
| <p><u>Vehicle Appearance Check</u></p> <ul style="list-style-type: none"><input type="checkbox"/> After accessory installation, perform a visual inspection. | <p>Ensure no damage (including scuffs and scratches) was caused during the installation process. (For PPO installations, refer to TMS Accessory Quality Shipping Standard.)</p> |