

|  |                     |                                      |
|--|---------------------|--------------------------------------|
| <b>Last Modified:</b> 10-24-2016   | 6.6 A               | <b>Doc ID:</b> RM100000000RSPA       |
| <b>Model Year Start:</b> 2016  | <b>Model:</b> Prius | <b>Prod Date Range:</b> [11/2015 - ] |
| <b>Title:</b> LIGHTING (INT): PERSONAL LIGHT: REMOVAL; 2016 - 2017 MY Prius [11/2015 - ] |                     |                                      |

## **REMOVAL**

### **PROCEDURE**

#### **1. REMOVE ROOF CONSOLE BOX ASSEMBLY**

(a) w/o Sliding Roof:

(1) Using a moulding remover, disengage the 4 clips.

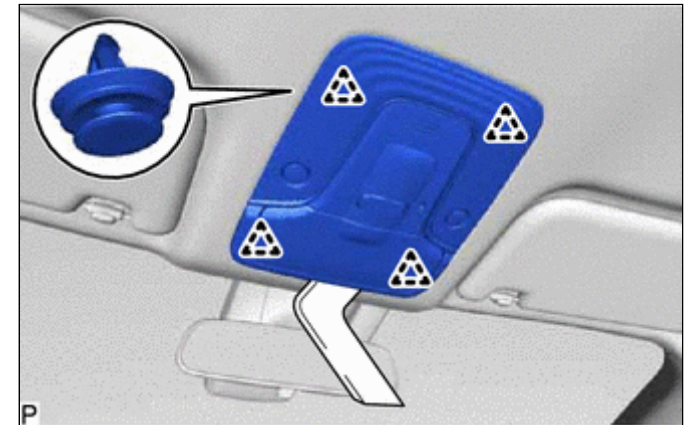

(b) w/ Sliding Roof:

(1) Using a moulding remover, disengage the 4 clips.

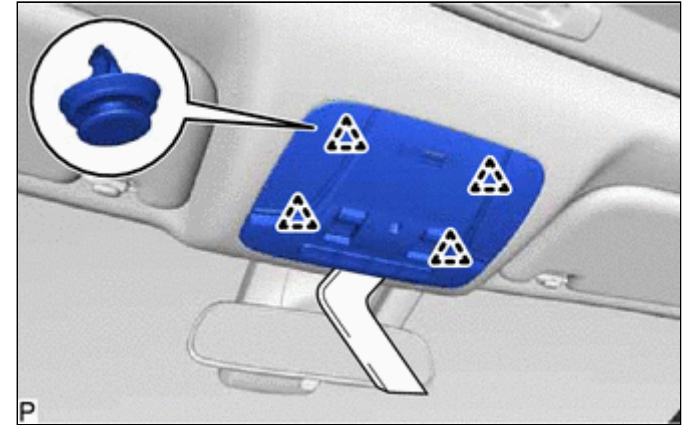

(c) Disconnect each connector to remove the roof console box assembly.

