

WATER PUMP COMPONENTS

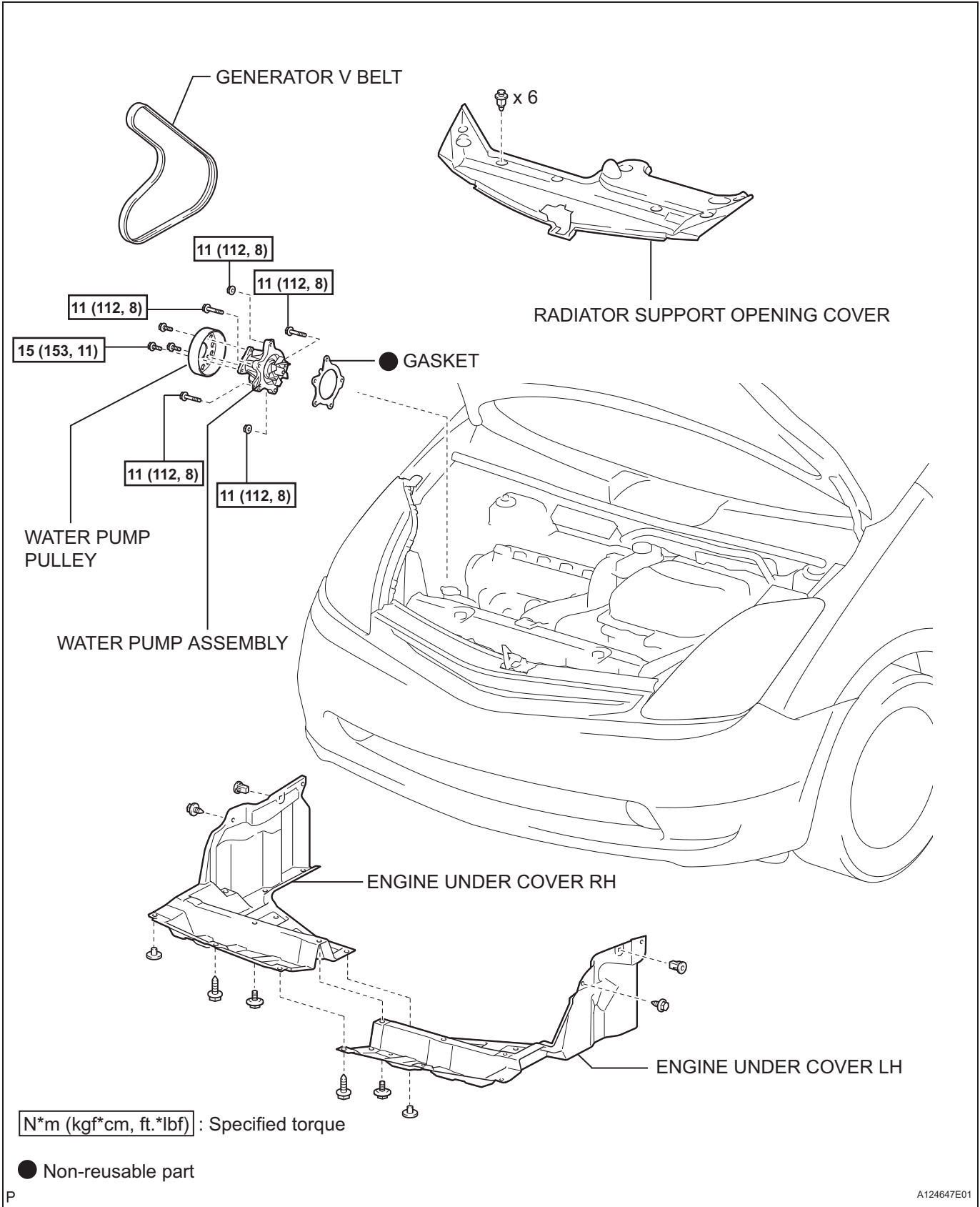

REMOVAL

1. REMOVE RADIATOR SUPPORT OPENING COVER (See page CO-6)
2. REMOVE ENGINE UNDER COVER LH
3. REMOVE ENGINE UNDER COVER RH
4. DRAIN ENGINE COOLANT (See page CO-6)
5. REMOVE GENERATOR V BELT (See page EM-6)
6. REMOVE ENGINE MOUNTING INSULATOR SUB-ASSEMBLY RH (See page EM-32)
7. REMOVE WATER PUMP PULLEY
 - (a) Using SST, hold the pump pulley.
SST 09960-10010 (09962-01000, 09963-00600)
 - (b) Remove the 3 bolts and pump pulley.

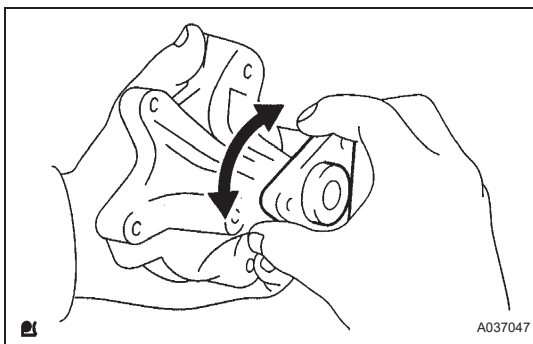
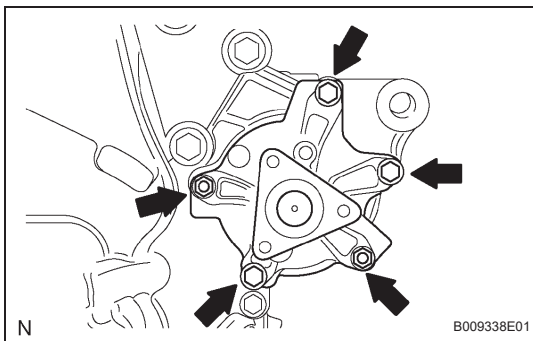
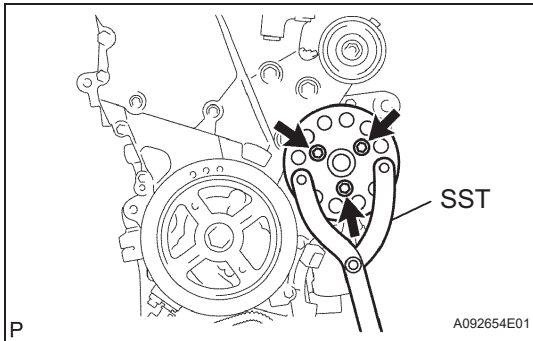

8. REMOVE WATER PUMP ASSEMBLY
 - (a) Remove the 3 bolts and 2 nuts.
 - (b) Remove the water pump and gasket.

INSPECTION

1. INSPECT WATER PUMP ASSEMBLY
 - (a) Visually check the water hole and air hole for coolant leakage.
If leakage is found, replace the water pump assembly.
 - (b) Turn the pulley, and check that the pump bearing moves smoothly and quietly.
If it moves roughly or noisily, replace the water pump assembly.

INSTALLATION

1. INSTALL WATER PUMP ASSEMBLY
 - (a) Install a new gasket and the water pump with the 3 bolts and 2 nuts.
Torque: 11 N*m (112 kgf*cm, 8 ft.*lbf)
2. INSTALL WATER PUMP PULLEY
 - (a) Using SST, install the pump pulley with the 3 bolts.
SST 09960-10010 (09962-01000, 09963-00600)
Torque: 15 N*m (153 kgf*cm, 11 ft.*lbf)

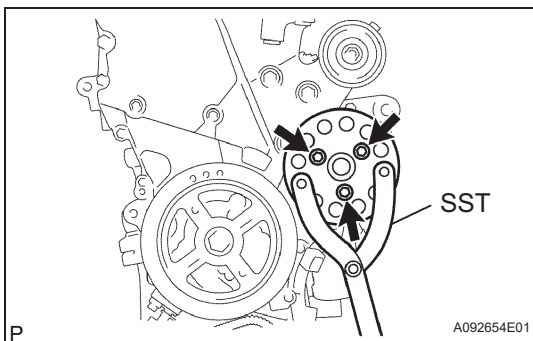

3. **INSTALL ENGINE MOUNTING INSULATOR SUB-ASSEMBLY RH** (See page [EM-38](#))
4. **INSTALL GENERATOR V BELT** (See page [EM-6](#))
5. **ADJUST GENERATOR V BELT** (See page [EM-6](#))
6. **ADD ENGINE COOLANT** (See page [CO-7](#))
7. **CHECK FOR ENGINE COOLANT LEAKS** (See page [CO-9](#))
8. **INSTALL ENGINE UNDER COVER RH**
9. **INSTALL ENGINE UNDER COVER LH**
10. **INSTALL RADIATOR SUPPORT OPENING COVER** (See page [CO-9](#))