

HOOD COMPONENTS

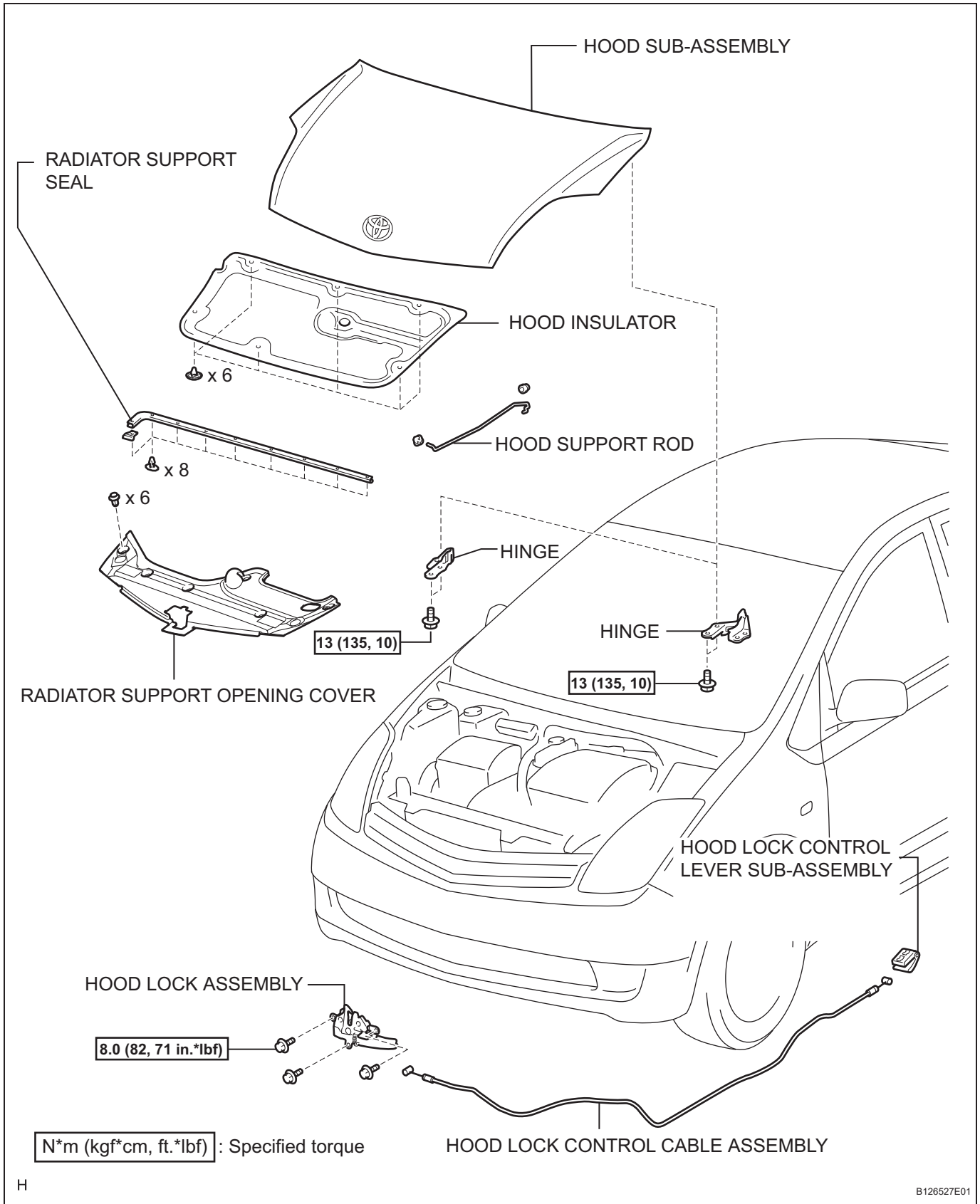

ED

ON-VEHICLE INSPECTION

1. INSPECT HOOD SUB-ASSEMBLY

- (a) Check that the clearance measurements of areas A to D are within the standard range.

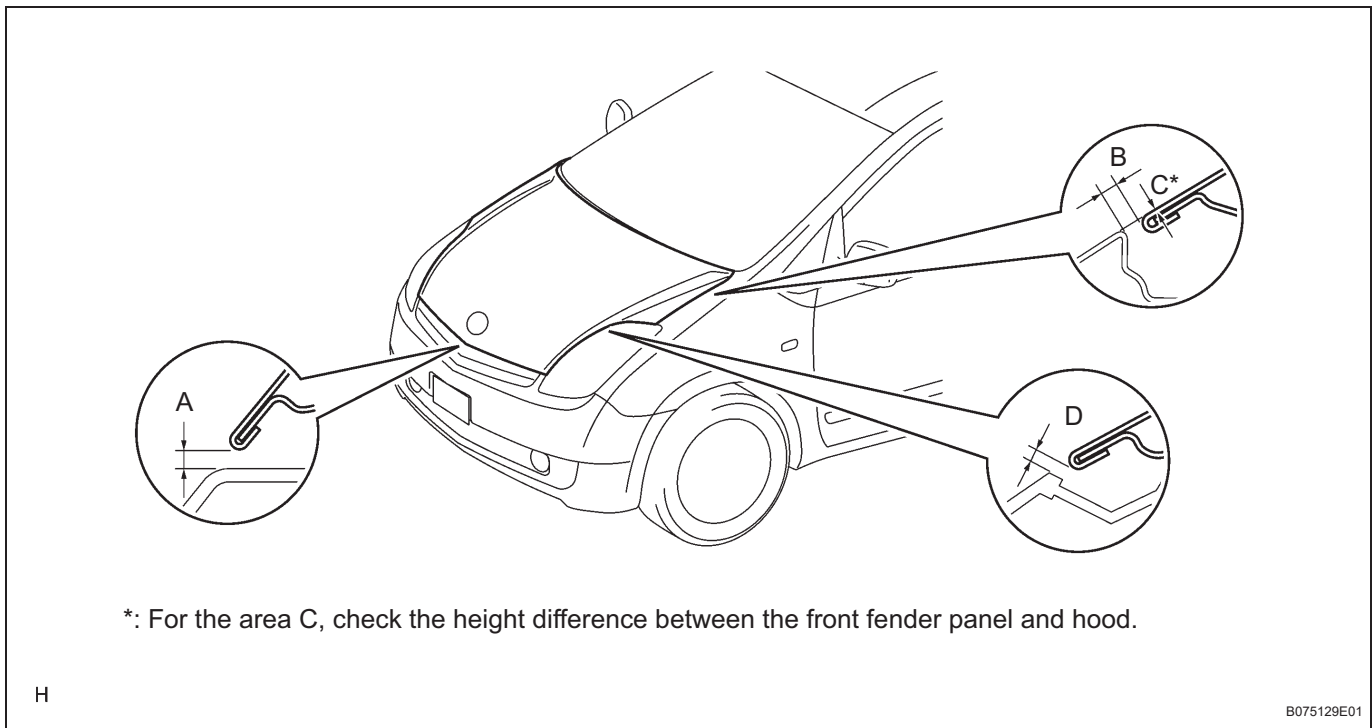

Standard measurement

Area	Specified Condition	Area	Specified Condition
A	4.3 +1.5 mm (0.146 +0.059 in.)	C	0.0 +1.5 mm (0.000 +0.059 in.)
B	3.7 +1.5 mm (0.146 +0.059 in.)	D	3.3 +1.5 mm (0.130 +0.059 in.)

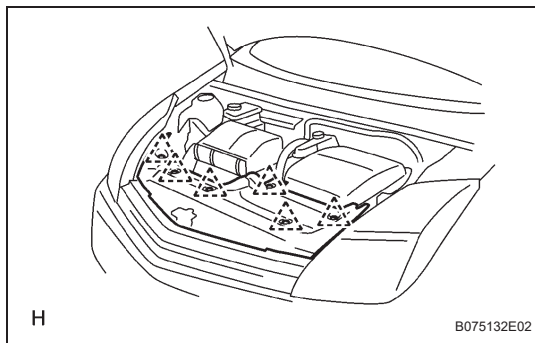

REMOVAL

1. REMOVE RADIATOR SUPPORT OPENING COVER

- (a) Remove the 6 clips and radiator support opening cover.

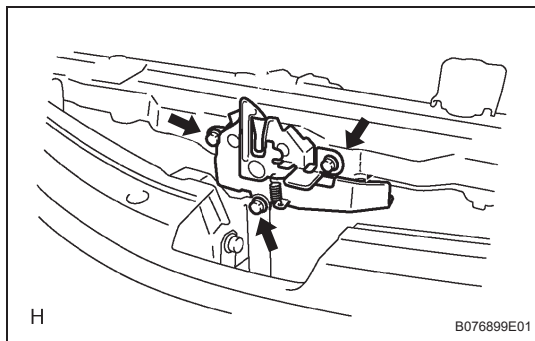

2. REMOVE HOOD LOCK ASSEMBLY

- (a) Remove the 3 bolts and hood lock.
 (b) Disconnect the lock control cable.

3. REMOVE HOOD SUPPORT ROD

- (a) Remove the rod.
 (b) Using a clip remover, remove the holder and retainer.

4. REMOVE HOOD INSULATOR

- (a) Using a clip remover, remove the 6 clips and insulator.

5. REMOVE HOOD LOCK CONTROL CABLE ASSEMBLY

- (a) Remove the front bumper cover (see page ET-3).
- (b) Remove the front fender liner (see page ET-3).
- (c) Using a screwdriver, disconnect the cable clamps as shown in the illustration.

HINT:

Tape the screwdriver tip before use.

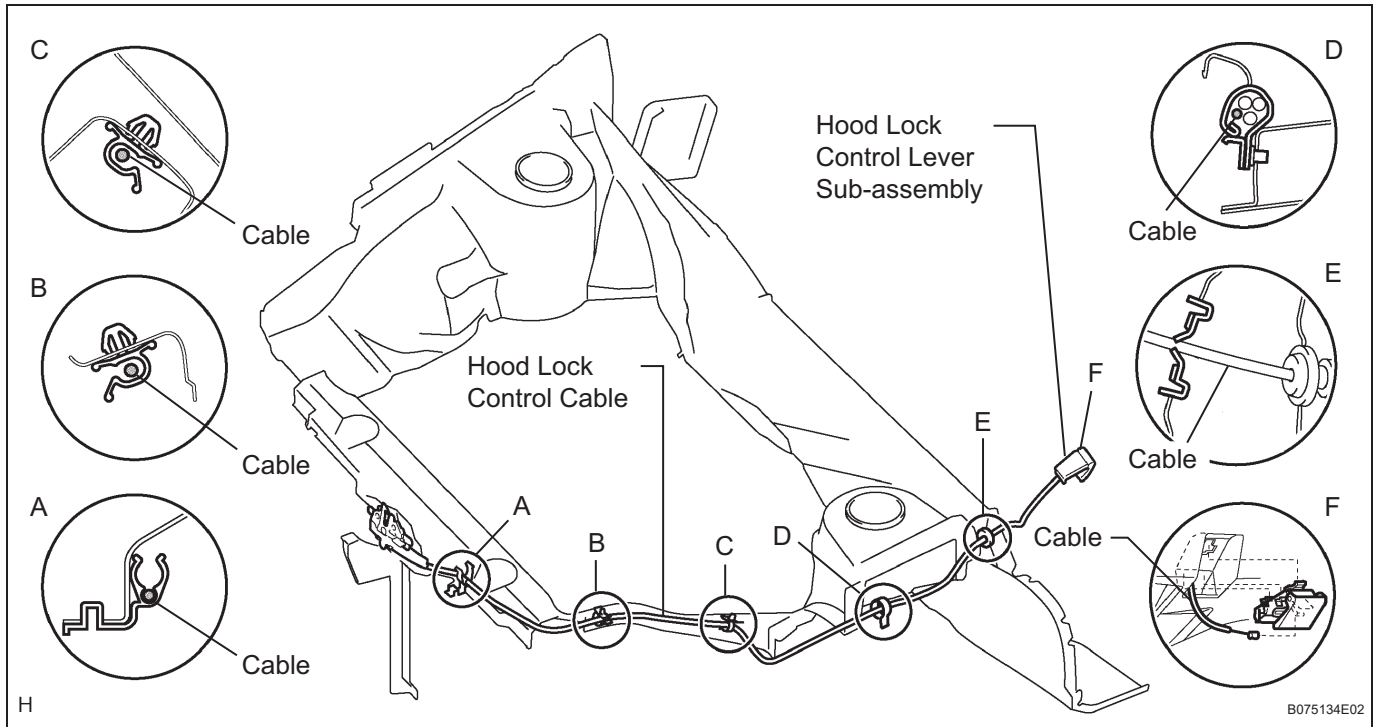

- (d) Remove the cable.

ADJUSTMENT

HINT:

- Use the same procedure for the RH side and LH side.
- The procedures listed below are for the LH side.
- Centering bolts are used to mount the hood hinge and hood lock. The hood and hood lock cannot be adjusted with the centering bolts on. Substitute the centering bolts with standard bolts (with washers) when making adjustments.
- A bolt without a torque specification is shown in the standard bolt chart (see page [SS-2](#)).

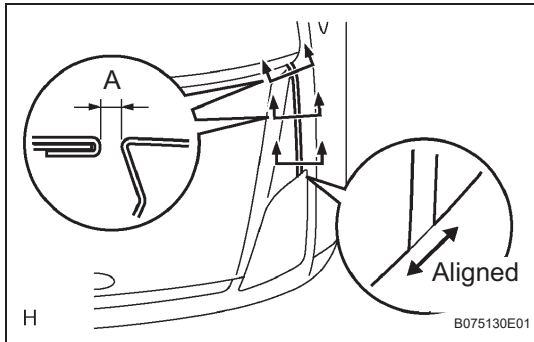
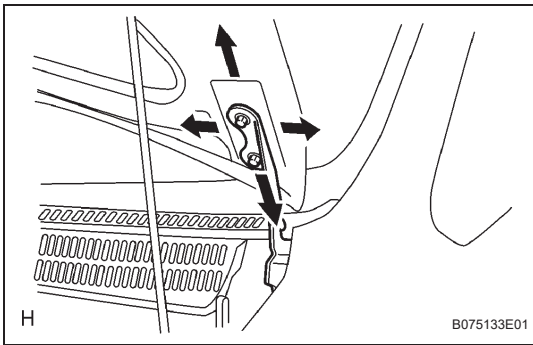
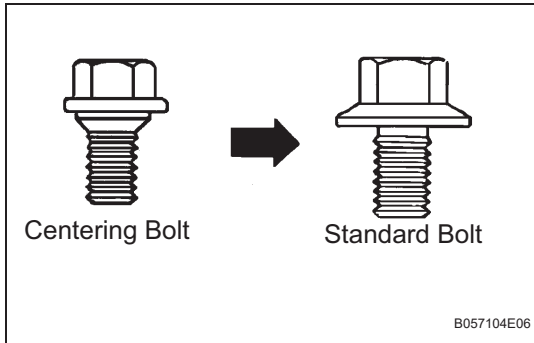

1. ADJUST HOOD SUB-ASSEMBLY

(a) Adjust the hood's position.

- (1) Loosen the 4 hinge bolts on the hood side.

- (2) Move the hood and adjust the clearance between the hood and front fender. Make sure that the clearance is within the standard range.

Standard measurement (A):

3.7 + -1.5 mm (0.146 + -0.059 in.)

- (3) Tighten the hood's hinge bolts after the adjustment.

Torque: 13 N*m (133 kgf*cm, 10 ft.*lbf)

- (b) Adjust the cushion rubber so that the height of the hood and the fender are aligned.

HINT:

Raise or lower the cushion rubber by turning it.

Standard measurement:

3.3 + -1.5 mm (0.130 + -0.059 in.)

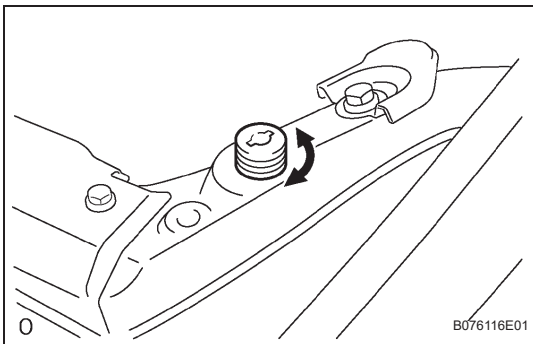

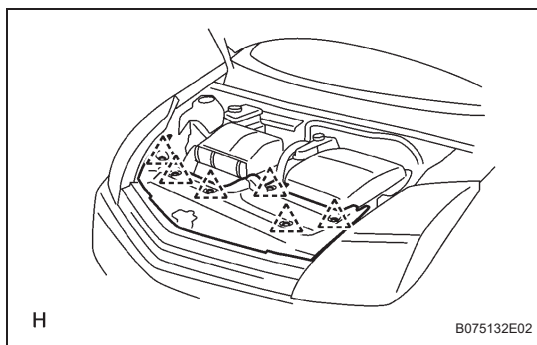

- (c) Adjust the hood lock.
- (1) Remove the 6 clips and radiator support opening cover.

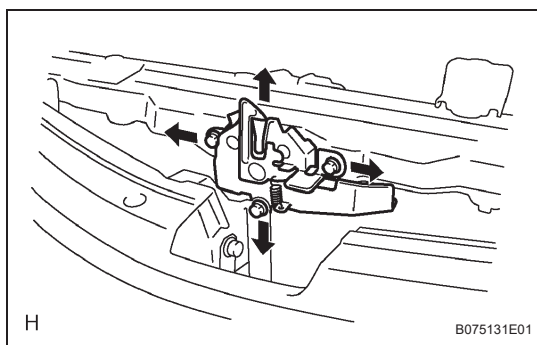

- (2) Loosen the 3 bolts.
- (3) Adjust the hood lock position so that the striker can enter it smoothly.
- (4) Tighten the bolts and nut after the adjustment.
Torque: 8.0 N*m (82 kgf*cm, 71 in.*lbf)

INSTALLATION

HINT:

A bolt without a torque specification is shown in the standard bolt chart (see page [SS-2](#)).

1. INSTALL HOOD LOCK CONTROL CABLE ASSEMBLY

- (a) Install the cable.
- (b) Connect the cable clamps as shown in the illustration.

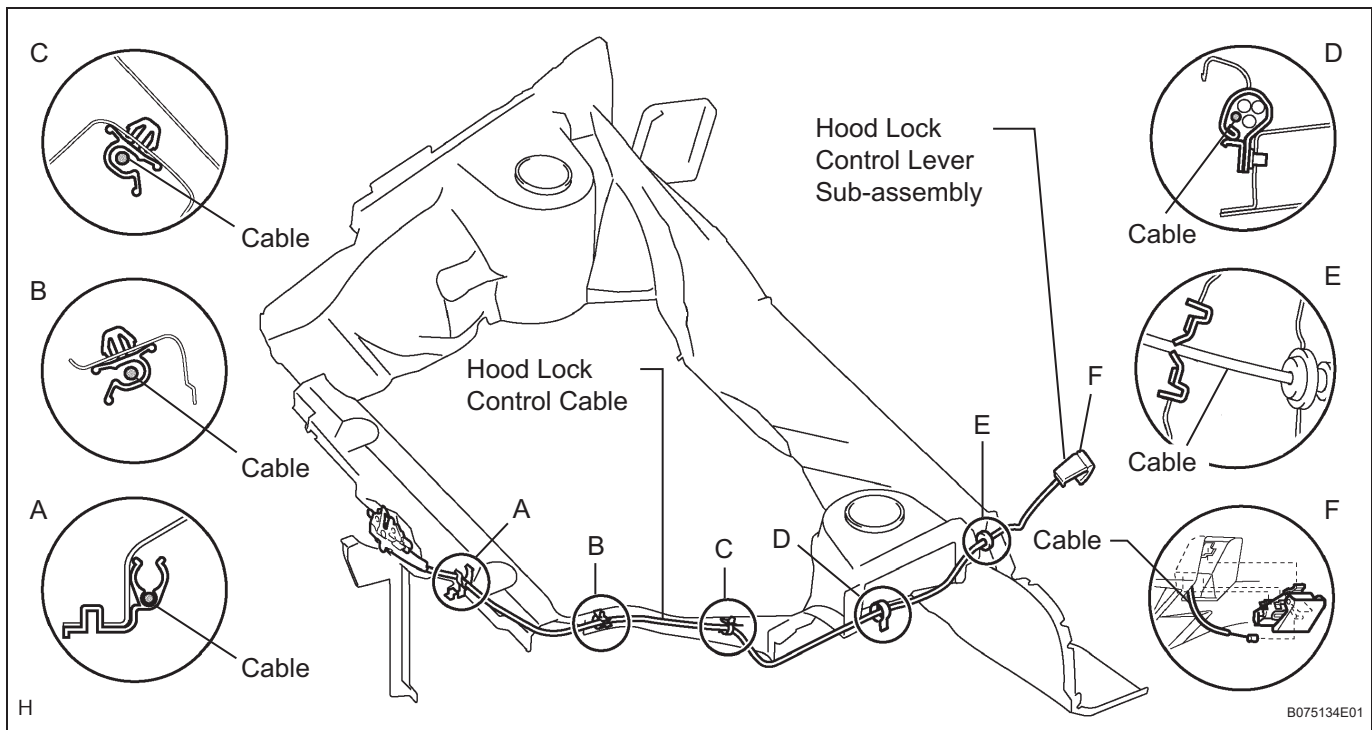

- (c) Install the front fender liner (see page [ET-6](#)).
- (d) Remove the front bumper cover (see page [ET-6](#)).

2. INSTALL HOOD INSULATOR

- (a) Install the insulator with the 6 clips.

3. INSTALL HOOD SUPPORT ROD

- (a) Install the retainer and holder.
- (b) Install the rod.

4. INSTALL HOOD LOCK ASSEMBLY

- (a) Connect the hood lock control cable.
- (b) Install the lock with the 3 bolts.
Torque: 8.0 N*m (82 kgf*cm, 71 in.*lbf)
- (c) Adjust the hood lock (see page [ED-3](#)).

ED

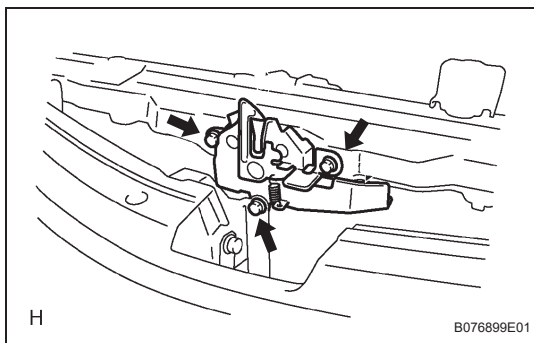

SPECIFIED TORQUE FOR STANDARD BOLTS

Class	Diameter (mm)	Pitch (mm)	Specified torque					
			Hexagon head bolt			Hexagon flange bolt		
			N*m	kgf*cm	ft.*lbf	N*m	kgf*cm	ft.*lbf
4T	6	1	5	55	48 in.*lbf	6	60	52 in.*lbf
	8	1.25	12.5	130	9	14	145	10
	10	1.25	26	260	19	29	290	21
	12	1.25	47	480	35	53	540	39
	14	1.5	74	760	55	84	850	61
	16	1.5	115	1,150	83	-	-	-
5T	6	1	6.5	65	56 in.*lbf	7.5	75	65 in.*lbf
	8	1.25	15.5	160	12	17.5	175	13
	10	1.25	32	330	24	36	360	26
	12	1.25	59	600	43	65	670	48
	14	1.5	91	930	67	100	1,050	76
	16	1.5	140	1,400	101	-	-	-
6T	6	1	8	80	69 in.*lbf	9	90	78 in.*lbf
	8	1.25	19	195	14	21	210	15
	10	1.25	39	400	29	44	440	32
	12	1.25	71	730	53	80	810	59
	14	1.5	110	1,100	80	125	1,250	90
	16	1.5	170	1,750	127	-	-	-
7T	6	1	10.5	110	8	12	120	9
	8	1.25	25	260	19	28	290	21
	10	1.25	52	530	38	58	590	43
	12	1.25	95	970	70	105	1,050	76
	14	1.5	145	1,500	108	165	1,700	123
	16	1.5	230	2,300	166	-	-	-
8T	8	1.25	29	300	22	33	330	24
	10	1.25	61	620	45	68	690	50
	12	1.25	110	1,100	80	120	1,250	90
9T	8	1.25	34	340	25	37	380	27
	10	1.25	70	710	51	78	790	57
	12	1.25	125	1,300	94	140	1,450	105
10T	8	1.25	38	390	28	42	430	31
	10	1.25	78	800	58	88	890	64
	12	1.25	140	1,450	105	155	1,600	116
11T	8	1.25	42	430	31	47	480	35
	10	1.25	87	890	64	97	990	72
	12	1.25	155	1,600	116	175	1,800	130

SS