

# REAR SEAT OUTER BELT ASSEMBLY

## COMPONENTS

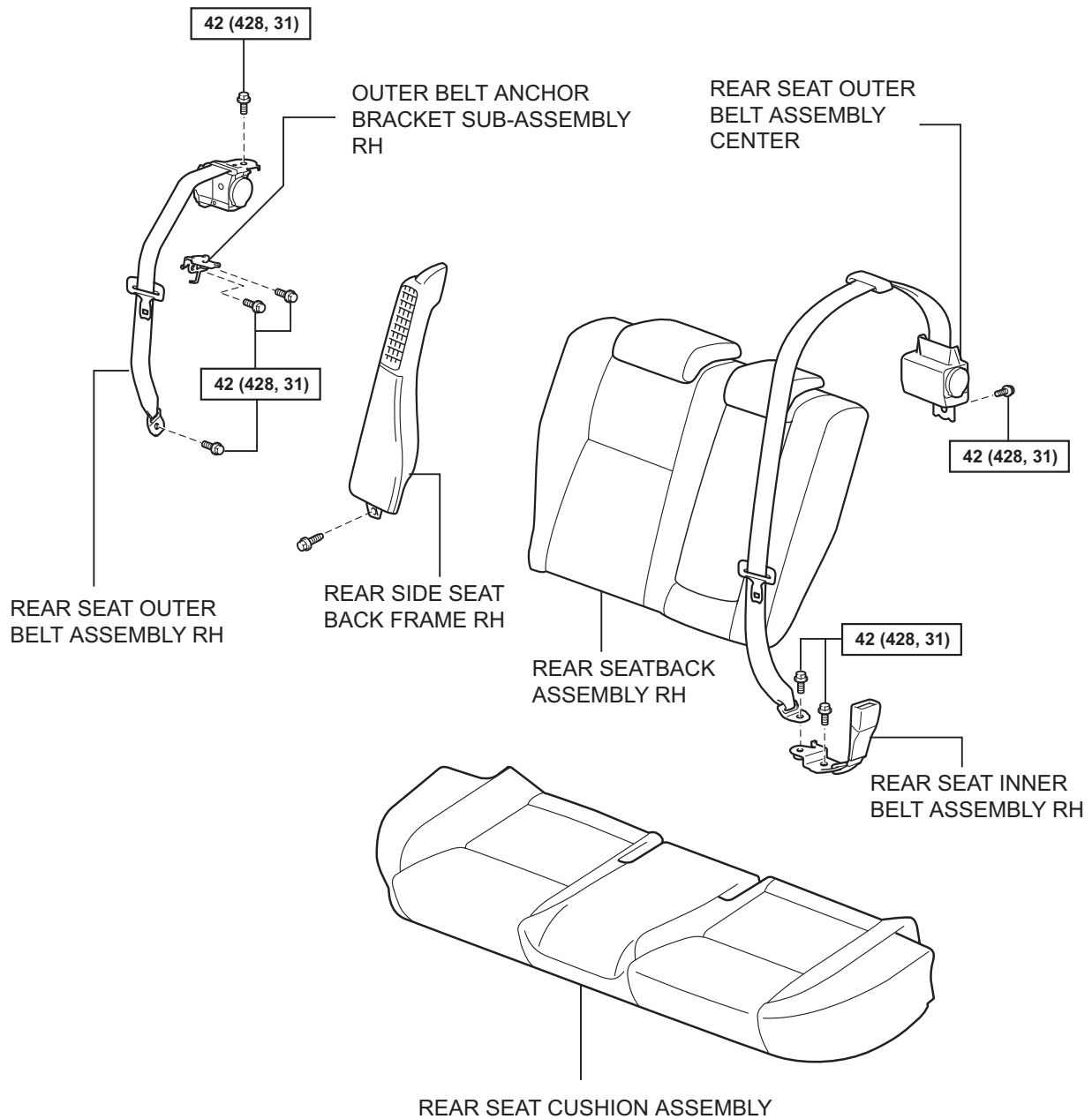

**N\*m (kgf\*cm, ft.\*lbf)** : Specified torque

SB

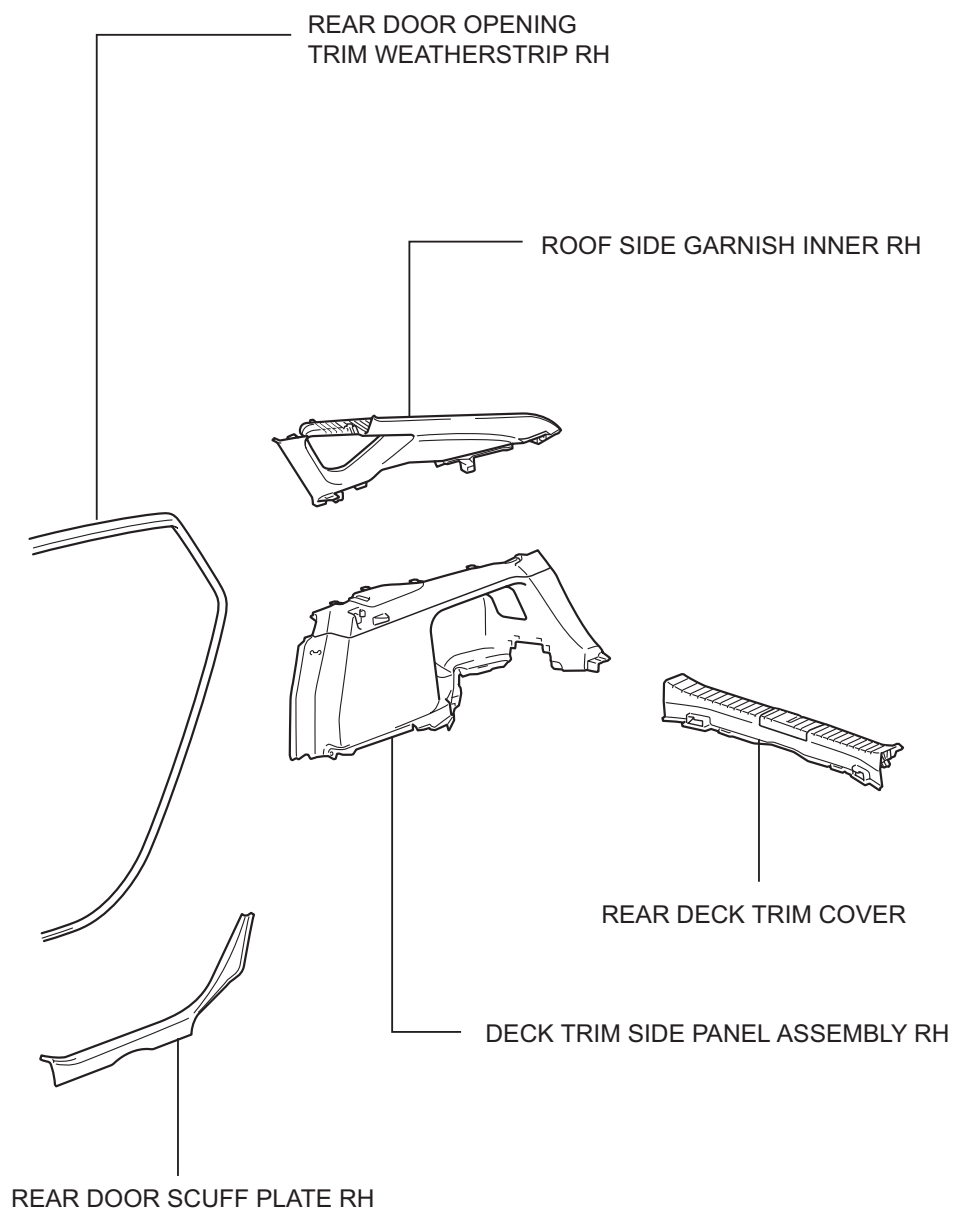

SB

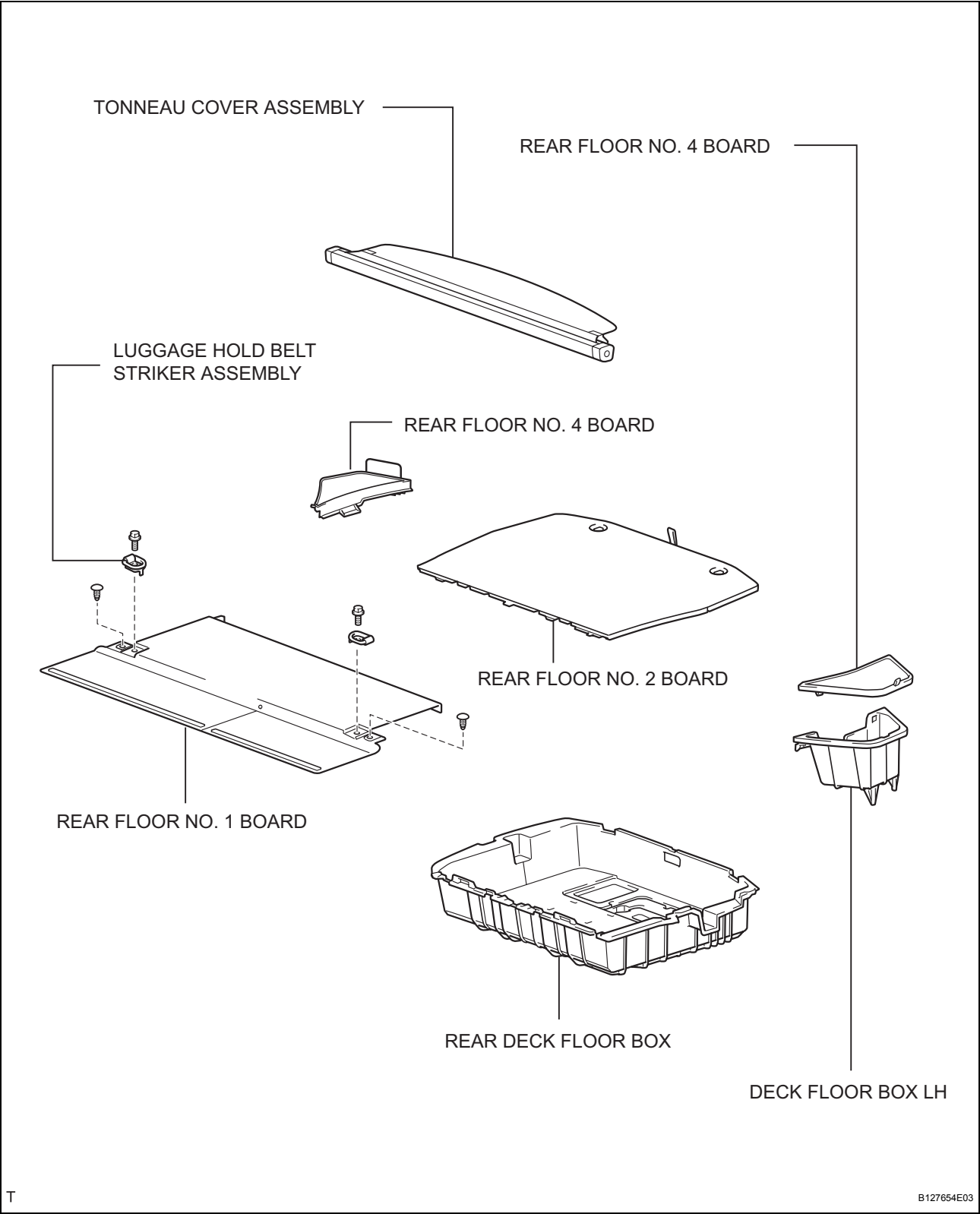

## REMOVAL

### HINT:

- Use the same procedures for the RH side and LH side.
- The procedures listed below are for the RH side.

### 1. DISCONNECT CABLE FROM NEGATIVE BATTERY TERMINAL

#### CAUTION:

Wait at least 90 seconds after disconnecting the cable from the negative (-) battery terminal to prevent airbag and seat belt pretensioner activation.

2. REMOVE REAR SEAT CUSHION ASSEMBLY (See page [SE-15](#))
3. REMOVE REAR DOOR SCUFF PLATE RH (See page [IR-9](#))
4. REMOVE REAR SIDE SEAT BACK FRAME RH (See page [SE-15](#))
5. REMOVE REAR DOOR OPENING TRIM WEATHERSTRIP RH
6. REMOVE REAR SEAT BACK ASSEMBLY RH (See page [SE-15](#))
7. REMOVE REAR SEAT BACK ASSEMBLY RH (See page [SE-15](#))
8. REMOVE TONNEAU COVER ASSEMBLY
9. REMOVE REAR FLOOR NO. 2 BOARD
10. REMOVE REAR FLOOR NO. 1 BOARD
11. REMOVE REAR FLOOR NO. 4 BOARD
12. REMOVE DECK FLOOR BOX LH
13. REMOVE REAR DECK FLOOR BOX
14. REMOVE REAR DECK TRIM COVER (See page [IR-10](#))
15. REMOVE DECK TRIM SIDE PANEL ASSEMBLY RH (See page [IR-11](#))
16. REMOVE ROOF SIDE GARNISH INNER RH (See page [IR-11](#))
17. REMOVE REAR SEAT OUTER BELT ASSEMBLY RH
  - (a) Remove the 2 bolts and outer belt.
  - (b) Remove the 2 bolts and belt outer anchor bracket RH.
18. REMOVE REAR SEAT OUTER BELT ASSEMBLY CENTER

### HINT:

RH side only.

- (a) Remove the bolt and disconnect the floor anchor.

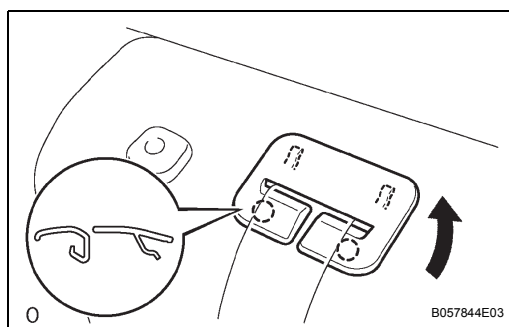

- (b) Using a screwdriver, detach the 4 claws and remove the cover.

HINT:

Tape the screwdriver tip before use.

- (c) Remove the rear seat headrest RH (see page [SE-16](#)).
- (d) Remove the rear seat center headrest (see page [SE-16](#)).
- (e) Remove the rear seat back cover RH (see page [SE-17](#)).
- (f) Remove the bolt on the retractor side and belt.

## INSPECTION

### 1. INSPECT REAR SEAT OUTER BELT ASSEMBLY CENTER

**NOTICE:**

**Do not disassemble the retractor.**

- (a) When the inclination of the retractor is  $15^\circ$  or less, check that the belt can be pulled from the retractor. When the inclination of the retractor is over  $45^\circ$ , check that the belt locks. If the operation is not as specified, replace the belt.

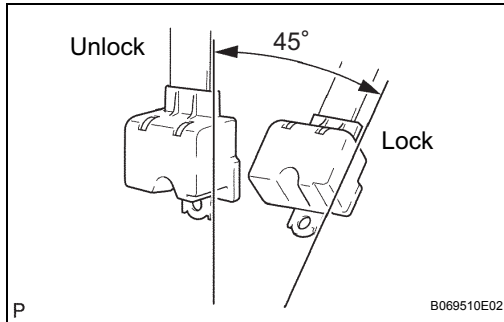

### 2. INSPECT REAR SEAT OUTER BELT ASSEMBLY

**NOTICE:**

**Do not disassemble the retractor.**

- (a) When the inclination of the retractor is  $15^\circ$  or less, check that the belt can be pulled from the retractor. When the inclination of the retractor is over  $45^\circ$ , check that the belt locks. If the operation is not as specified, replace the belt.

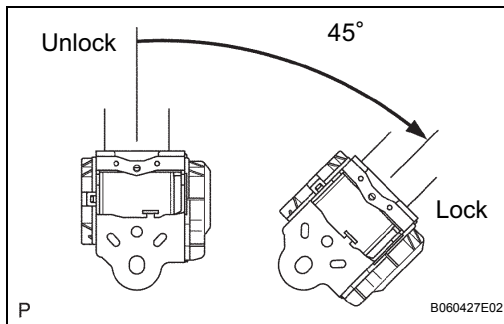

## INSTALLATION

### HINT:

- Use the same procedures for the RH side and LH side.
- The procedures listed below are for the LH side.
- A bolt without a torque specification is shown in the standard bolt chart (see page [SS-2](#)).

### 1. INSTALL REAR SEAT OUTER BELT ASSEMBLY CENTER

- Install the belt with the bolt on the retractor side.  
**Torque: 42 N\*m (428 kgf\*cm, 31 ft.\*lbf)**
- Install the rear seatback cover RH (see page [SE-20](#)).
- Install the rear seat headrest RH (see page [SE-21](#)).
- Install the rear seat center headrest (see page [SE-21](#)).
- Attach the 4 claws to install the cover (see page [SE-22](#)).
- Connect the floor anchor of the belt with the bolt, as shown in the illustration.  
**Torque: 42 N\*m (428 kgf\*cm, 31 ft.\*lbf)**  
**NOTICE:**  
**Make sure that the anchor part does not run onto the protruding part.**

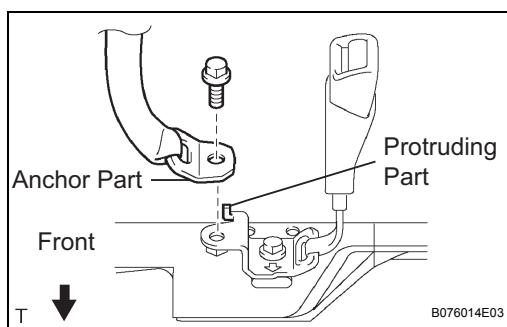

### 2. INSTALL REAR SEAT OUTER BELT ASSEMBLY RH

- Install the belt on the retractor side with the bolt.  
**Torque: 42 N\*m (428 kgf\*cm, 31 ft.\*lbf)**  
**NOTICE:**  
**Make sure that the anchor part does not run onto the protruding part of the side panel.**
- Install the belt on the floor anchor side with the bolt.  
**Torque: 42 N\*m (428 kgf\*cm, 31 ft.\*lbf)**
- With the belt installed, check that the belt locks when it is pulled out quickly.  
**NOTICE:**  
**The check should be performed with the outer belt installed.**  
If the operation is not as specified, replace the belt.

### 3. INSTALL ROOF SIDE GARNISH INNER RH (See page [IR-15](#))

### 4. INSTALL DECK TRIM SIDE PANEL ASSEMBLY RH

- Install the deck trim side panel RH (see page [IR-16](#)).
- Install the rear seat outer belt RH with the bolt on the floor anchor side.  
**Torque: 42 N\*m (428 kgf\*cm, 31 ft.\*lbf)**

### 5. INSTALL REAR DECK TRIM COVER (See page [IR-16](#))

### 6. INSTALL REAR DECK FLOOR BOX

### 7. INSTALL DECK FLOOR BOX LH

### 8. INSTALL REAR FLOOR NO. 4 BOARD

### 9. INSTALL REAR FLOOR NO. 1 BOARD

**SB**

10. INSTALL REAR FLOOR NO. 2 BOARD
11. INSTALL TONNEAU COVER ASSEMBLY
12. INSTALL REAR SEAT BACK ASSEMBLY RH (See page [SE-23](#))
13. INSTALL REAR DOOR OPENING TRIM WEATHERSTRIP RH
14. INSTALL REAR SIDE SEAT BACK FRAME RH
15. INSTALL REAR DOOR SCUFF PLATE RH
16. INSTALL REAR SEAT CUSHION ASSEMBLY (See page [SE-23](#))
17. CONNECT CABLE TO NEGATIVE BATTERY TERMINAL
18. PERFORM INITIALIZATION
  - (a) Perform initialization (see page [IN-32](#)).  
**NOTICE:**  
Certain systems need to be initialized after disconnecting and reconnecting the cable from the negative (-) battery terminal.