

21. REMOVE NO. 1 CHAIN TENSIONER ASSEMBLY_

INFO

22. REMOVE TIMING CHAIN COVER SUB-ASSEMBLY



(a) Remove the 3 bolts and engine mounting bracket RH.

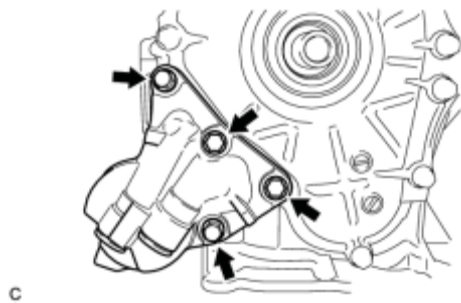

(b) Remove the 4 bolts and oil filter bracket.



(c) Remove the 2 O-rings.

(d) Remove the 18 bolts and seal washer.

Text in Illustration

*1	Seal Washer
----	-------------

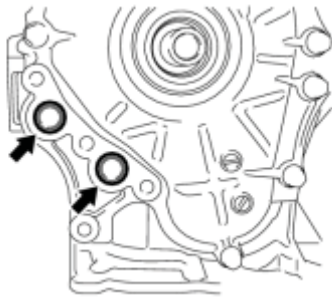

c

(i) Temporarily tighten the oil filter bracket with the 4 bolts.

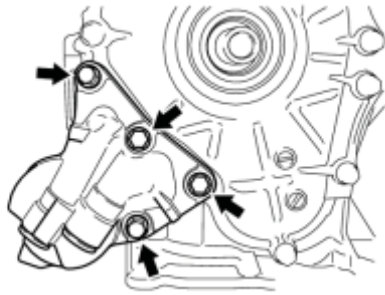

c

- Install the oil filter bracket within 10 minutes after installing the chain cover.
- Do not start the engine for at least 2 hours after installation.

Bolt Length:

Item	Length
Bolt	35 mm (1.38 in.)

(j) Install the timing chain cover with the 25 bolts and seal washer as shown in the illustration.

Torque:

Bolt Torque Order:

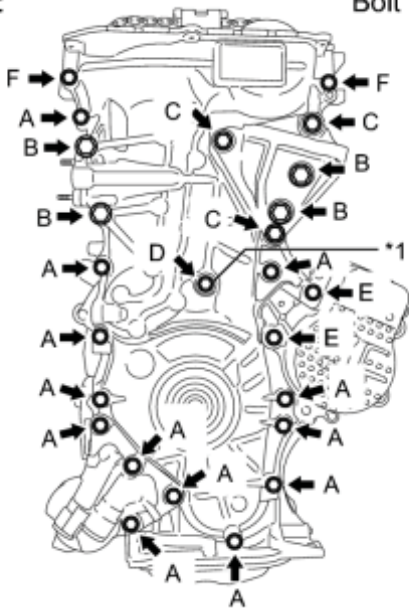

c

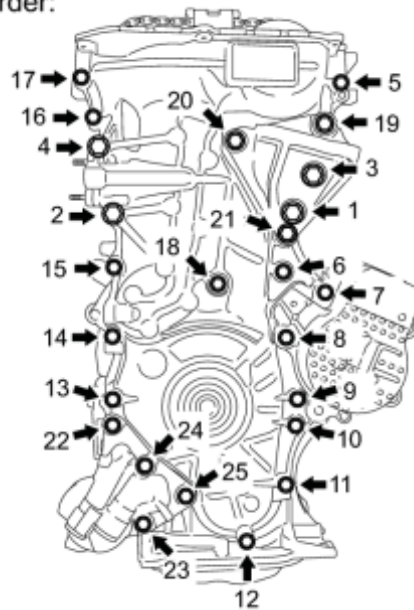

Text in Illustration

*1	Seal Washer	-	-
----	-------------	---	---

Bolt A, E, F - Torque: **26 N·m (260 kgf·cm, 19ft·lbf)**

Bolt B, C - Torque: **51 N·m (520 kgf·cm, 38ft·lbf)**