

COMPONENTS

ILLUSTRATION

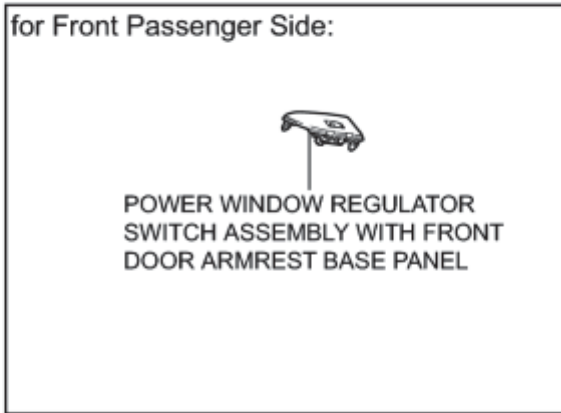
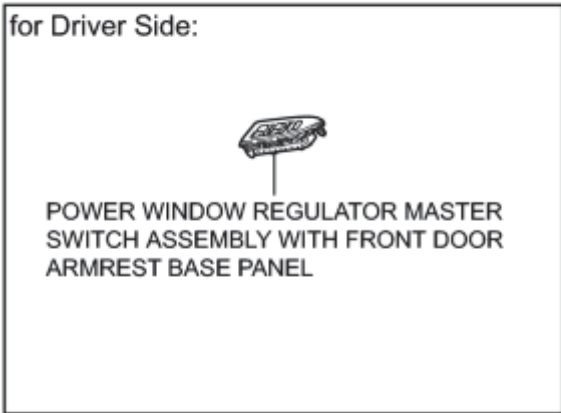
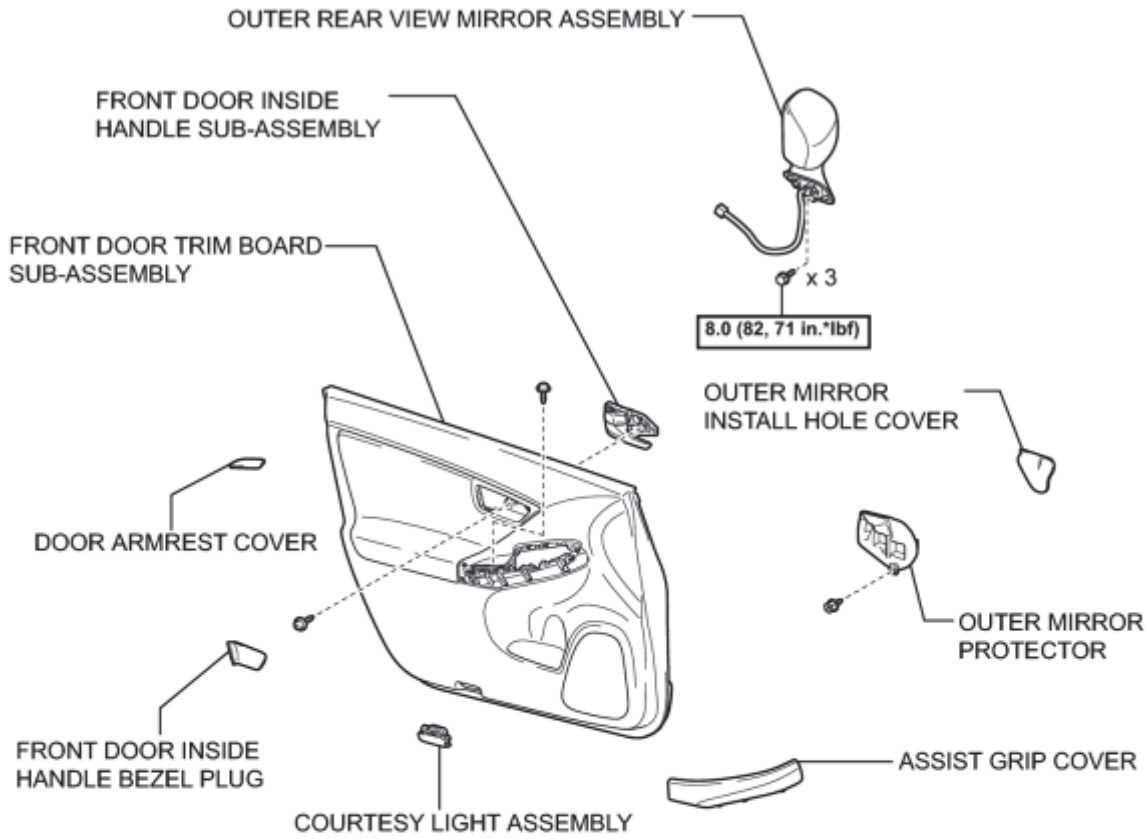

P

ILLUSTRATION

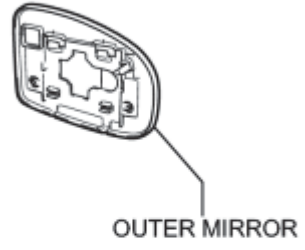
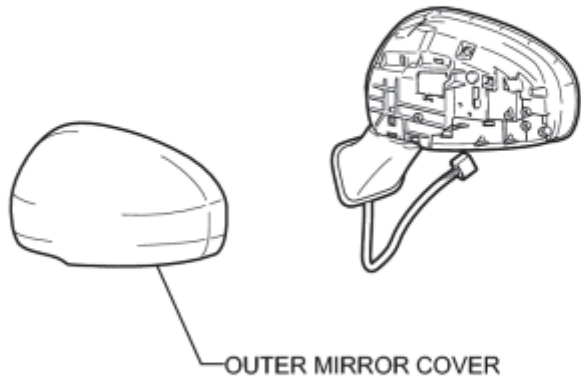

P

REMOVAL

1. REMOVE FRONT DOOR INSIDE HANDLE BEZEL PLUG_ INFO
2. REMOVE ASSIST GRIP COVER_ INFO
3. REMOVE DOOR ARMREST COVER_ INFO
4. REMOVE POWER WINDOW REGULATOR MASTER SWITCH ASSEMBLY WITH FRONT DOOR ARMREST BASE PANEL (for Driver Side)_ INFO
5. REMOVE POWER WINDOW REGULATOR SWITCH ASSEMBLY WITH FRONT DOOR ARMREST BASE PANEL (for Front Passenger Side)_ INFO
6. REMOVE COURTESY LIGHT ASSEMBLY_ INFO
7. REMOVE FRONT DOOR TRIM BOARD SUB-ASSEMBLY_ INFO
8. REMOVE FRONT DOOR INSIDE HANDLE SUB-ASSEMBLY_ INFO
9. REMOVE OUTER MIRROR PROTECTOR

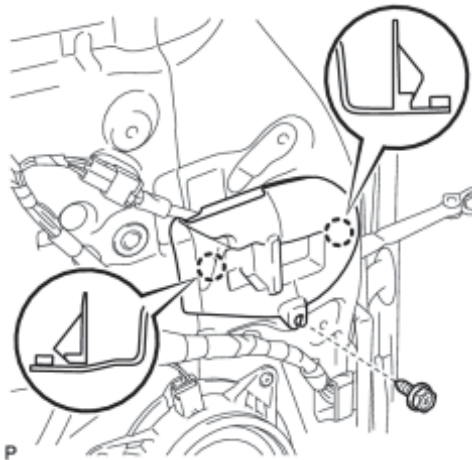

(a) Remove the screw.

(b) Disengage the 2 claws and remove the outer mirror protector.

10. REMOVE OUTER MIRROR INSTALL HOLE COVER

(a) Disengage the 2 claws and guide, remove the outer mirror install hole cover.



11. REMOVE OUTER REAR VIEW MIRROR ASSEMBLY

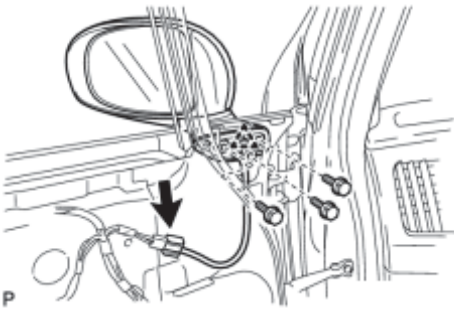

(a) Disconnect the connector.

(b) Remove the 3 bolts.

(c) Disengage the clip and remove the outer rear view mirror assembly.

12. REMOVE OUTER MIRROR INFO

13. REMOVE OUTER MIRROR COVER

(a) Disengage the 5 claws.

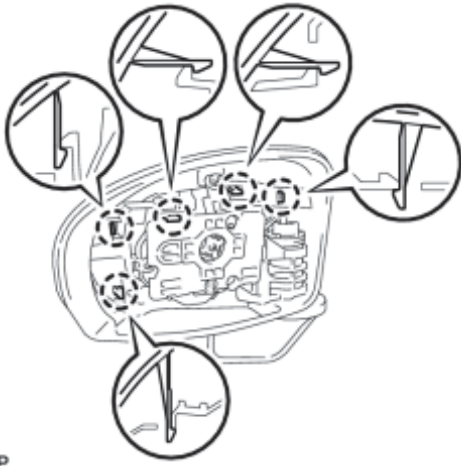

P



P

(b) Disengage the 3 claws and remove the outer mirror cover as shown in the illustration.

INSPECTION

1. INSPECT OUTER REAR VIEW MIRROR ASSEMBLY LH

(a) Inspect outer mirror motor operation.

(1) Apply battery voltage and check the operation of the mirror face, as shown in the table and illustration.

OK:

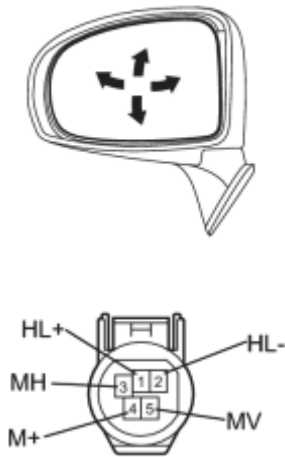

Connection	Result
Battery positive (+) → Terminal 5 (MV)	Turns upward
Battery negative (-) → Terminal 4 (M+)	
Battery positive (+) → Terminal 4 (M+)	Turns downward
Battery negative (-) → Terminal 5 (MV)	
Battery positive (+) → Terminal 3 (MH)	Turns left
Battery negative (-) → Terminal 4 (M+)	
Battery positive (+) → Terminal 4 (M+)	Turns right
Battery negative (-) → Terminal 3 (MH)	

Text in Illustration

*1	Front view of wire harness connector (to Outer Rear View Mirror Assembly LH)
----	---

If the result is not specified, replace the outer rear view mirror assembly.

(b) Check the mirror heater (w/ Mirror heater).

(1) Measure the resistance according to the value(s) in the table below.

Standard Resistance:

Tester Connection	Condition	Specified Condition
Terminal 1 (HL+) - Terminal 2 (HL-)	25°C (77°F)	7.6 to 11.4 Ω

If the result is not specified, replace the outer rear view mirror assembly.

2. INSPECT OUTER REAR VIEW MIRROR ASSEMBLY RH

(a) Inspect outer mirror motor operation.

(1) Apply battery voltage and check the operation of the mirror face, as shown in the table and illustration.

OK:

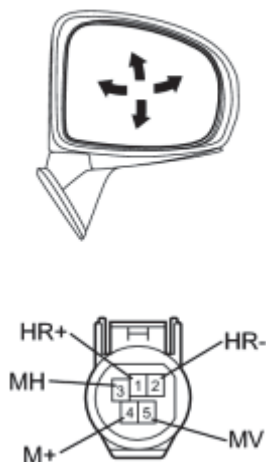

Connection	Result
Battery positive (+) → Terminal 5 (MV)	Turns upward
Battery negative (-) → Terminal 4 (M+)	
Battery positive (+) → Terminal 4 (M+)	Turns downward
Battery negative (-) → Terminal 5 (MV)	
Battery positive (+) → Terminal 3 (MH)	Turns left
Battery negative (-) → Terminal 4 (M+)	
Battery positive (+) → Terminal 4 (M+)	Turns right
Battery negative (-) → Terminal 3 (MH)	

Text in Illustration

*1	Front view of wire harness connector (to Outer Rear View Mirror Assembly RH)
----	---

If the result is not specified, replace the outer rear view mirror assembly.

(b) Check the mirror heater (w/ Mirror heater).

(1) Measure the resistance according to the value(s) in the table below.

Standard Resistance:

Tester Connection	Condition	Specified Condition
Terminal 1 (HR+) - Terminal 2 (HR-)	25°C (77°F)	7.6 to 11.4 Ω

If the result is not specified, replace the outer rear view mirror assembly.

INSTALLATION

1. INSTALL OUTER MIRROR COVER

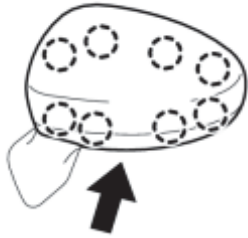

(a) Engage the 8 claws to install the outer mirror cover.

NOTICE:

Securely engage the 8 claws.

P

2. INSTALL OUTER MIRROR_ INFO

3. INSTALL OUTER REAR VIEW MIRROR ASSEMBLY

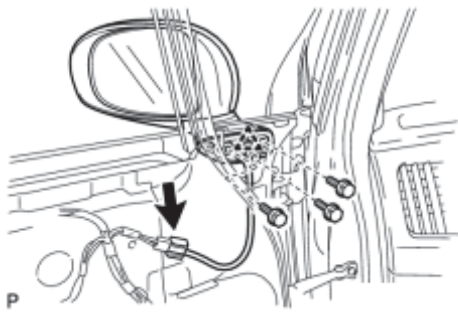

(a) Engage the clip to install the outer rear view mirror assembly.

(b) Install the outer rear view mirror assembly with the 3 bolts.

Torque: **8.0 N·m (82 kgf·cm, 71in·lbf)**

(c) Connect the connector.

4. INSTALL OUTER MIRROR INSTALL HOLE COVER

(a) Engage the guide and 2 claws to install the outer mirror install hole cover.



5. INSTALL OUTER MIRROR PROTECTOR

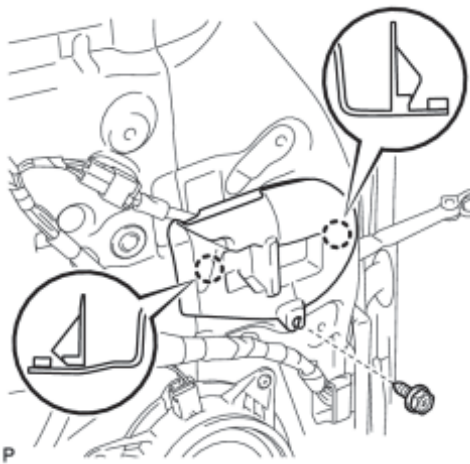

(a) Engage the 2 claws.

(b) Install the outer mirror protector with the screw.

6. INSTALL FRONT DOOR INSIDE HANDLE SUB-ASSEMBLY INFO

7. INSTALL FRONT DOOR TRIM BOARD SUB-ASSEMBLY INFO

8. INSTALL COURTESY LIGHT ASSEMBLY INFO

9. INSTALL POWER WINDOW REGULATOR MASTER SWITCH ASSEMBLY WITH FRONT DOOR ARMREST BASE PANEL (for Driver Side) INFO

10. INSTALL POWER WINDOW REGULATOR SWITCH ASSEMBLY WITH FRONT DOOR ARMREST BASE PANEL (for Front Passenger Side) INFO

11. INSTALL DOOR ARMREST COVER INFO

12. INSTALL ASSIST GRIP COVER INFO

13. INSTALL FRONT DOOR INSIDE HANDLE BEZEL PLUG_ 