



2006 Toyota Tundra 4.7L Eng SR5

Print Date: 12/10/2016

M.I.L. "ON" DTC P0335 AND/OR P1340: INTERMITTENT HOT SOAK NO-START

TECHNICAL SERVICE BULLETIN

Reference Number(s): EG052-06, Date of Issue: August 24, 2006

TOYOTA: 2005 - 2006 4Runner (2UZ-FE), Land Cruiser , Sequoia, & Tundra (2UZ-FE)

SECTION:ENGINE

Introduction

Some customers may experience a M.I.L. "ON" condition with DTCs P0335 and/or P1340 with intermittent hot soak no-start. The camshaft position sensor assembly has been improved to prevent this concern.

- P0335 (Crankshaft Position Sensor "A" Circuit)
- P1340 (Camshaft Position Sensor "A" [Bank 1 Sensor 1])

Applicable Vehicles

- **2005 - 2006** model year **4Runner** and **Tundra** vehicles equipped with the **2UZ-FE engine**.
- **2005 - 2006** model year **Land Cruiser** and **Sequoia** vehicles.

Parts Information

PARTS INFORMATION

PREVIOUS PART NUMBER	CURRENT PART NUMBER	PART NAME	QTY
19300-50010	19300-50030	Camshaft Position Sensor Assembly	1

Warranty Information

WARRANTY INFORMATION

OP CODE	DESCRIPTION	TIME	OPF	T1	T2
EG5036	R & R Camshaft Position Sensor Assembly	1.0	19300-50010	8A	99

Applicable Warranty*:

This repair is covered under the Toyota Comprehensive Warranty. This warranty is in effect for 36 months or 36,000 miles, whichever occurs first, from the vehicle's in-service date.

* Warranty application is limited to correction of a problem based upon a customer's specific complaint.

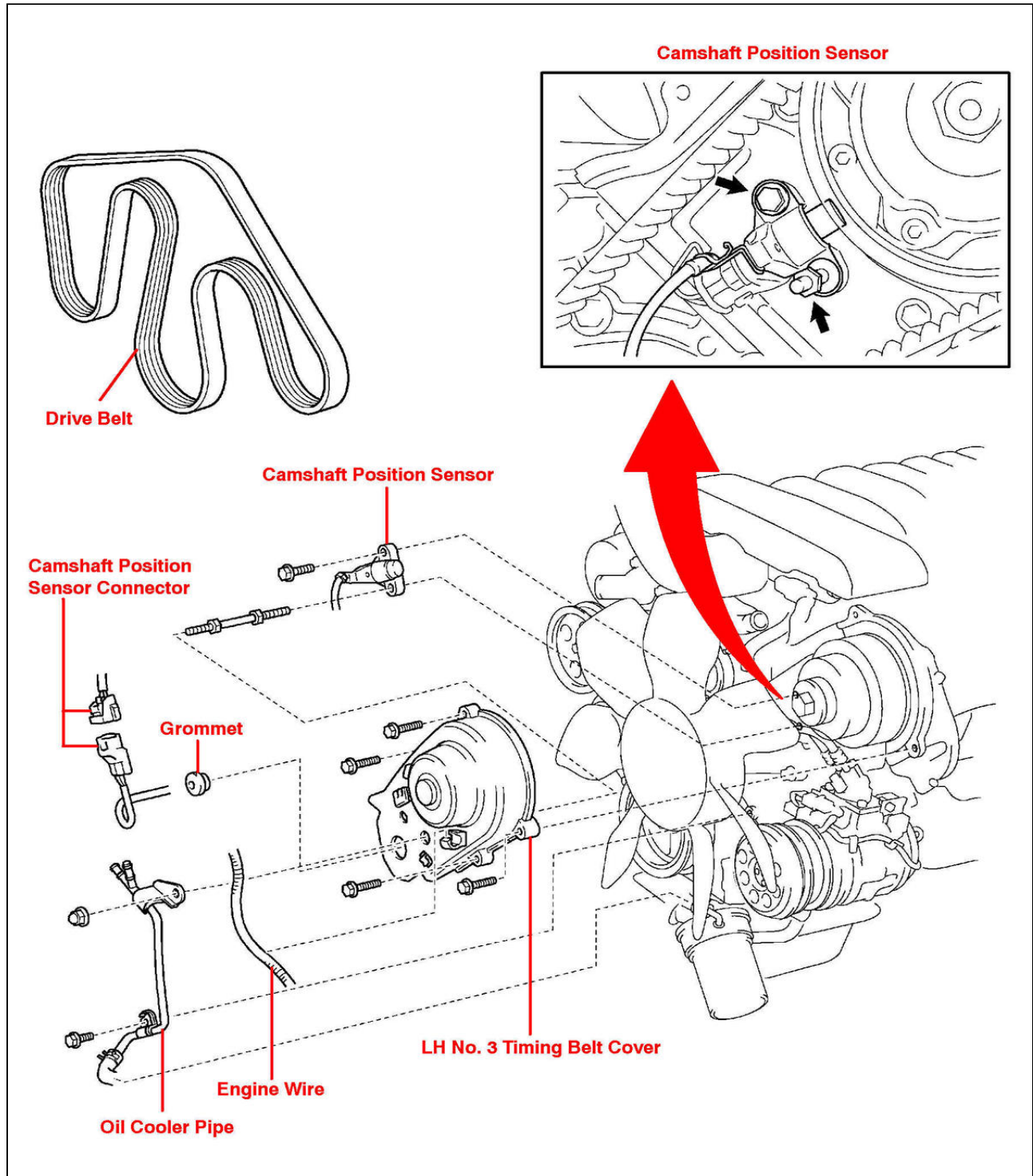

Components

Fig 1: Identifying Camshaft Position Sensor Components

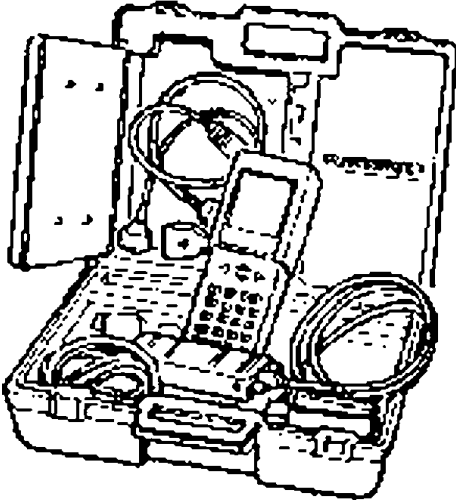

Required SSTs

SST CHART

ITEM NO.	SPECIAL SERVICE TOOLS (SSTs)	PART NUMBER	QTY	DRW ⁽²⁾
1	<p data-bbox="263 216 505 279">Toyota Diagnostic Tester Kit ⁽¹⁾</p> <div data-bbox="263 310 570 926" style="border: 1px solid black; padding: 5px;"> <p data-bbox="298 352 431 386"> NOTE:</p> <ul data-bbox="331 422 553 869" style="list-style-type: none"> <li data-bbox="331 422 553 520">• All components from this kit/set are required. <li data-bbox="331 558 553 869">• 12 Megabyte Diagnostic Tester Program Card (P/N 01002593-005) with version 13.4a Software (or later) is required. </div> <div data-bbox="599 331 1052 827" style="text-align: center;">  </div>	TOY220036	1	9
2	<p data-bbox="263 1287 448 1350">CAN Interface Module Kit ⁽¹⁾</p> <div data-bbox="263 1381 570 1650" style="border: 1px solid black; padding: 5px;"> <p data-bbox="298 1423 431 1457"> NOTE:</p> <ul data-bbox="331 1493 553 1591" style="list-style-type: none"> <li data-bbox="331 1493 553 1591">• All components from this kit/set are required. </div> <div data-bbox="599 1037 1052 1919" style="text-align: center;">  </div>	01002744	1	9

(1) Essential SSTs.

(2) Refers to drawer number in SST Storage System.



NOTE: Additional Diagnostic Tester Kits, CAN Interface Modules, Program Cards, or other SSTs may be ordered by calling SPX/OTC at 1-800-933-8335.

Repair Procedure

1. Using the Diagnostic Tester, check for Diagnostic Trouble Codes (DTCs).
2. If DTCs P0335 and/or P1340 are present and the customer reports difficulty starting the vehicle when it is hot, refer to the Technical Information System (TIS), 2005 - 2006 model year Repair Manual for applicable model: Ignition (2UZ-FE): Camshaft Position Sensor: Removal.

HINT:

Not ALL cases will include difficulty starting after a hot soak. If P0335 and/or P1340 are present and can be duplicated after clearing the DTCs with the Diagnostic Tester but the hot soak no-start condition is NOT duplicated, use the auto probe and monitor the camshaft position sensor output and compare with the illustration in the Diagnostics section of the Repair Manual for DTC P1340. If the camshaft position sensor signal waveform does NOT match, replace the camshaft position sensor .

3. Replace the camshaft position sensor .
4. Using the Diagnostic Tester, clear the DTCs.
5. Test drive the vehicle for a minimum of 10 minutes. Then use the Diagnostic Tester to verify that NO pending DTCs set.

Please Drive Safe!!!