

COMPONENTS

ILLUSTRATION

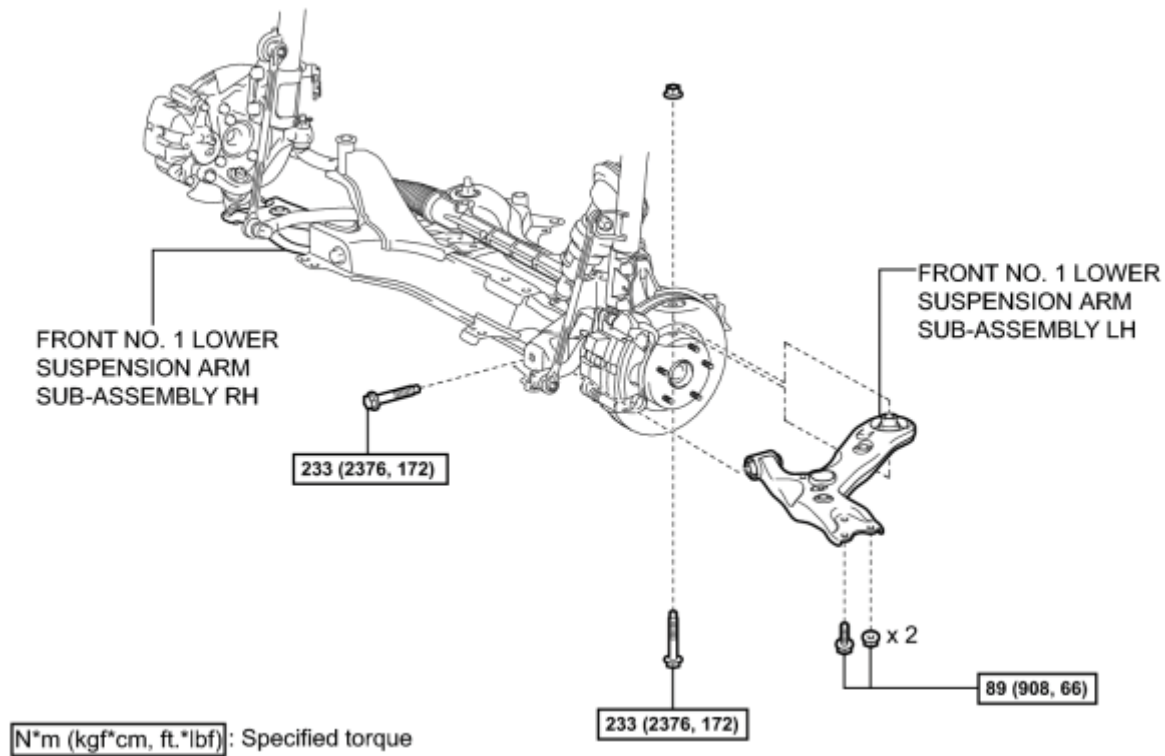

c

REMOVAL

1. REMOVE FRONT WHEELS

2. REMOVE NO. 1 ENGINE UNDER COVER

3. SEPARATE FRONT NO. 1 LOWER SUSPENSION ARM SUB-ASSEMBLY LH_ INFO

4. REMOVE FRONT NO. 1 LOWER SUSPENSION ARM SUB-ASSEMBLY LH



(a) Remove the 2 bolts, nut, and front No. 1 lower suspension arm sub-assembly LH from the front suspension member.

NOTICE:

Because the nut has its own stopper, do not turn the nut. Loosen the bolt with the nut secured.

5. REMOVE FRONT NO. 1 LOWER SUSPENSION ARM SUB-ASSEMBLY RH

HINT:

Refer to the procedure up to Remove Front No. 1 Lower Suspension Arm Sub-assembly RH INFO.

INSTALLATION

1. TEMPORARILY TIGHTEN FRONT NO. 1 LOWER SUSPENSION ARM SUB-ASSEMBLY RH

HINT:

Refer to the procedure from Temporarily Tighten Front No. 1 Lower Suspension Arm Sub-assembly RH INFO.

2. TEMPORARILY TIGHTEN FRONT NO. 1 LOWER SUSPENSION ARM SUB-ASSEMBLY LH



(a) Temporarily install the front No. 1 lower suspension arm LH to the front suspension crossmember with the 2 bolts and nut.

NOTICE:

Because the nut has its own stopper, do not turn the nut. Tighten the bolt with the nut secured.

3. CONNECT FRONT NO. 1 LOWER SUSPENSION ARM SUB-ASSEMBLY LH INFO

4. INSTALL FRONT WHEELS

Torque: **103 N·m (1050 kgf·cm, 76ft·lbf)**

5. STABILIZE SUSPENSION

(a) Lower the vehicle.

(b) Press down on the vehicle several times to stabilize the suspension.

6. FULLY TIGHTEN FRONT NO. 1 LOWER SUSPENSION ARM SUB-ASSEMBLY LH



(a) Fully tighten the bolt A and B.

Torque: **233 N·m (2376 kgf·cm, 172ft·lbf)**

NOTICE:

Because the nut has its own stopper, do not turn the nut. Tighten the bolt with the nut secured.

7. INSTALL NO. 1 ENGINE UNDER COVER

8. INSPECT AND ADJUST FRONT WHEEL ALIGNMENT

HINT:

Inspect and adjust the front wheel alignment .