

REAR AXLE BEAM

COMPONENTS

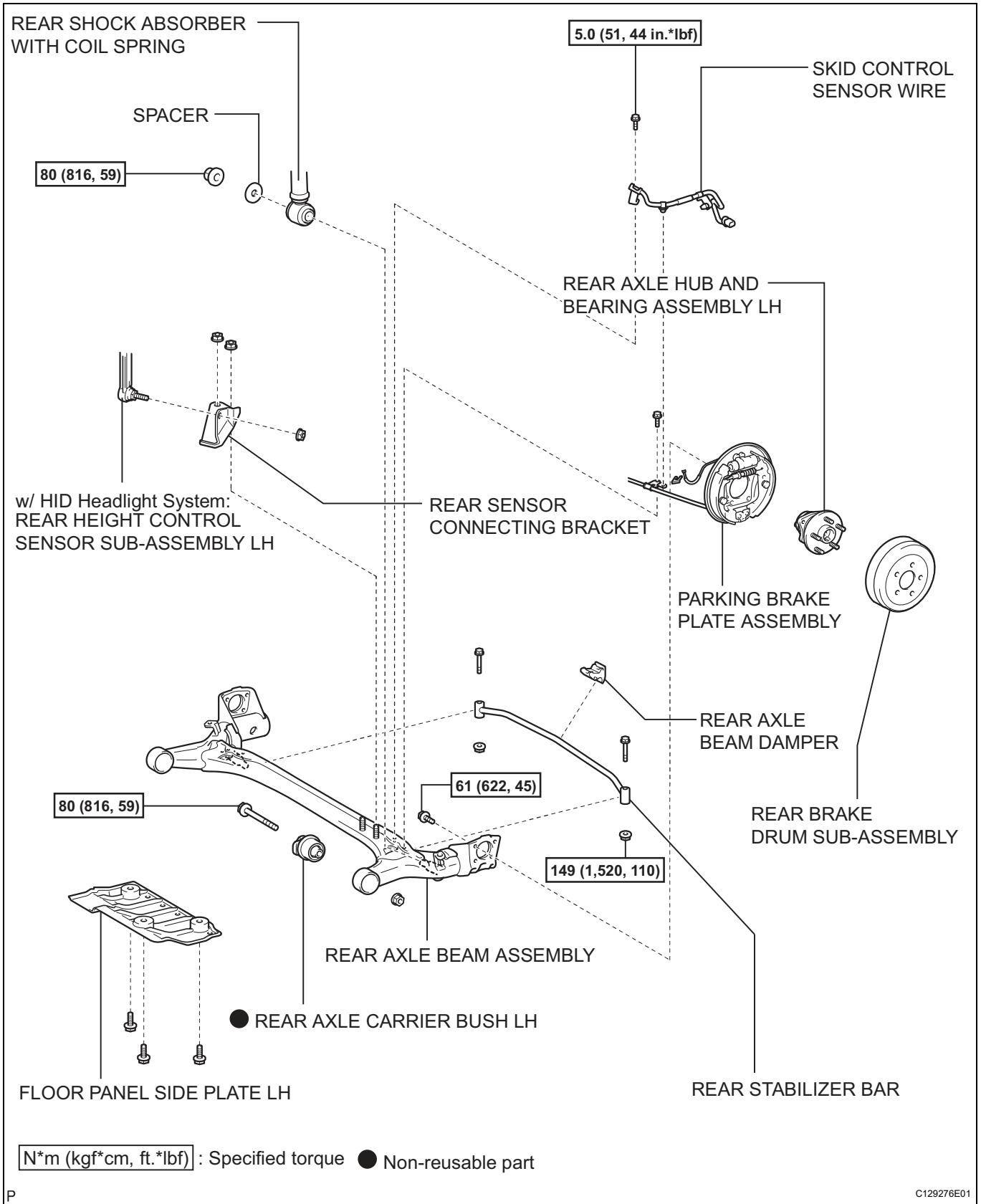

SP

REMOVAL

1. REMOVE REAR WHEEL
2. REMOVE FLOOR PANEL SIDE PLATE LH
(a) Remove the 3 bolts and floor panel side plate.
3. REMOVE FLOOR PANEL SIDE PLATE RH
(a) Remove the 3 bolts and floor panel side plate.

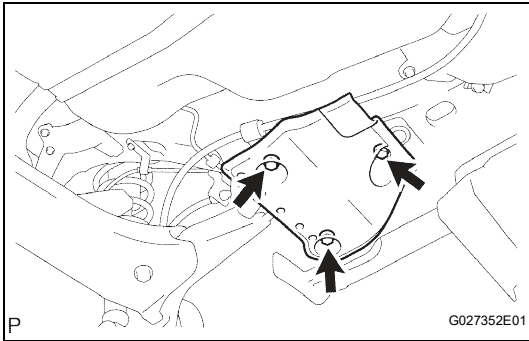

4. REMOVE REAR HEIGHT CONTROL SENSOR SUB-ASSEMBLY LH (w/ HID Headlight System)
(a) Remove the nut and height control sensor.

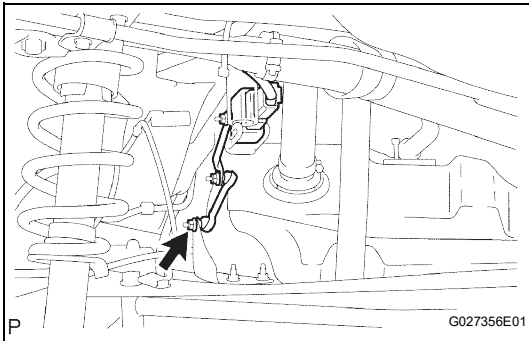

5. REMOVE REAR SENSOR CONNECTING BRACKET (w/ HID Headlight System)
(a) Remove the 2 nuts and sensor connecting bracket.

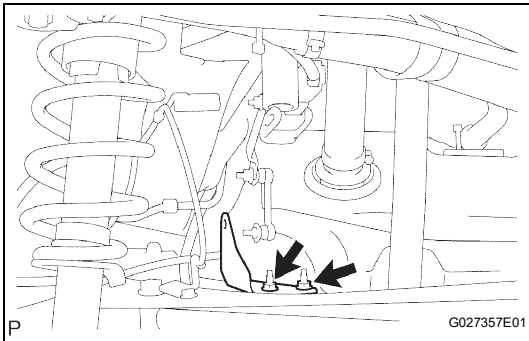

6. REMOVE REAR BRAKE DRUM SUB-ASSEMBLY (See page [BR-47](#))

7. DISCONNECT SKID CONTROL SENSOR WIRE
(a) Remove the 2 bolts and clip, and disconnect the skid control sensor wire and parking brake cable from the rear axle beam.

NOTICE:

- Ensure no foreign matter is on the end of the skid control sensor wire.
- Ensure that the skid control sensor wire is disconnected from the rear axle beam.

HINT:

Use the same procedures for the RH side and LH side.

8. REMOVE REAR AXLE BEAM DAMPER (See page [SP-44](#))
9. REMOVE REAR STABILIZER BAR (See page [SP-45](#))

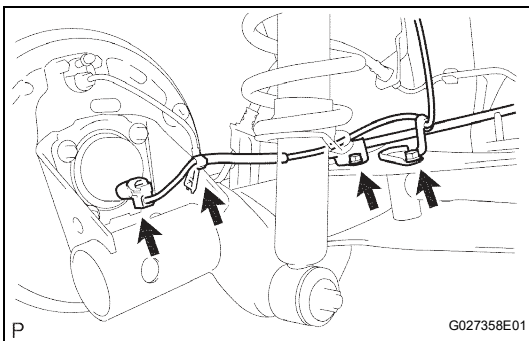

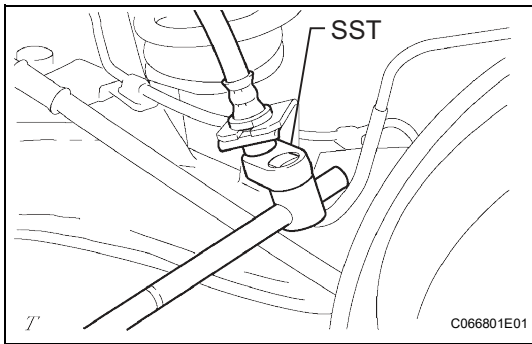
**10. DISCONNECT REAR NO. 4 BRAKE TUBE**

- (a) Using SST, disconnect the rear brake tube from the flexible hose.

SST 09023-00101

NOTICE:

Do not damage the rear brake tube or flexible hose.

- (b) Remove the clip.

11. DISCONNECT REAR NO. 3 BRAKE TUBE**HINT:**

Use the same procedures as the rear No. 4 brake tube.

12. REMOVE REAR AXLE HUB AND BEARING ASSEMBLY LH

- (a) Remove the 4 bolts. Remove the axle hub and bearing and parking brake plate from the rear axle beam.

NOTICE:

- Do not twist the parking brake cable.
- Use rope, etc. to suspend the parking brake plate.

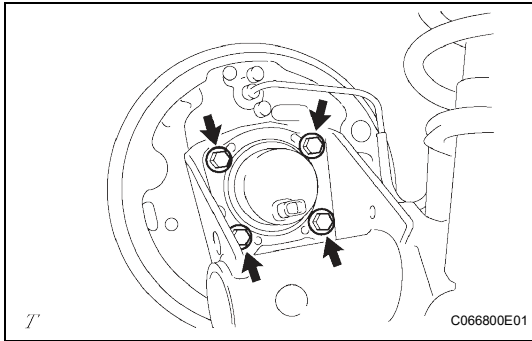
**13. REMOVE REAR AXLE HUB AND BEARING ASSEMBLY RH****HINT:**

Use the same procedures for the RH side and LH side.

14. DISCONNECT REAR SHOCK ABSORBER WITH COIL SPRING

- (a) Remove the 2 nuts from the left and right sides.
 (b) Disconnect the rear shock absorber with coil springs (lower side) from the rear axle beam.

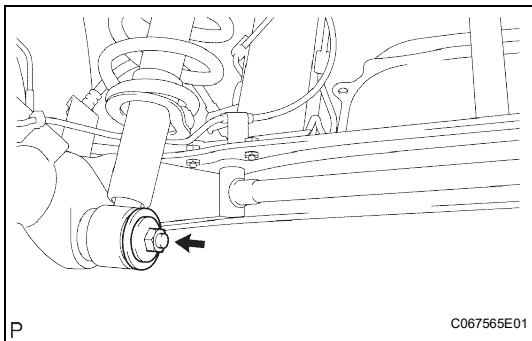
**15. REMOVE REAR AXLE BEAM ASSEMBLY**

- (a) Support the rear axle beam with a jack. Insert a wooden block between the jack and the center of the rear axle beam to prevent damage.

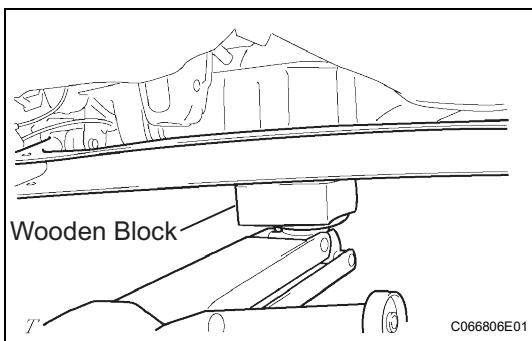

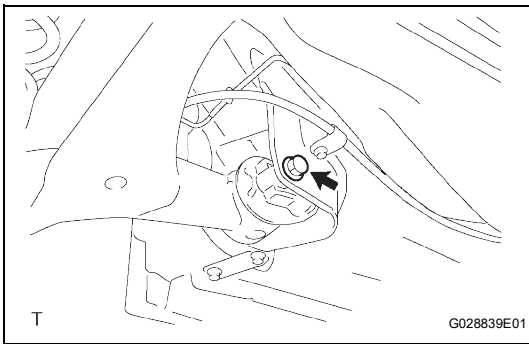

- (b) Remove the 2 bolts and 2 nuts from the left and right sides.

NOTICE:

Keep the nut from rotating when removing the bolt.

- (c) Remove the rear axle beam by slowly lowering the jack.

NOTICE:

Ensure that the skid control sensor wire is completely disconnected from the rear axle beam.

DISASSEMBLY**1. REMOVE REAR AXLE CARRIER BUSH LH**

- (a) Place a matchmark on the rear axle beam after aligning it with the bush recess.
- (b) Make 2 bends in the rim of the bush using a chisel and hammer.
- (c) Using SST, remove the bush from the rear axle beam.

SST 09950-40011 (09951-04020, 09952-04010, 09953-04030, 09954-04020, 09955-04051, 09957-04010, 09958-04011), 09950-60010 (09951-00630)

NOTICE:

- Do not erase the matchmark on the rear axle beam when removing the bush.
- Apply chassis black if the rear axle beam is scratched.

2. REMOVE REAR AXLE CARRIER BUSH RH**HINT:**

Use the same procedures for the RH side and LH side.

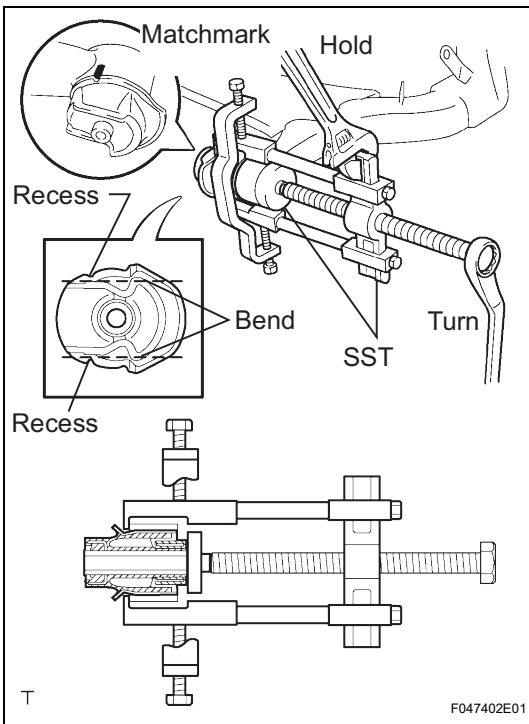

REASSEMBLY

1. INSTALL REAR AXLE CARRIER BUSH LH

- (a) When replacing only the bush:
- (1) Temporarily install a new bush recess by aligning it with the matchmark on the rear axle beam.

NOTICE:

Install the bush in the same direction as before it was removed.

- (b) When replacing the rear axle beam:
- (1) Temporarily install a new bush as shown in the illustration.

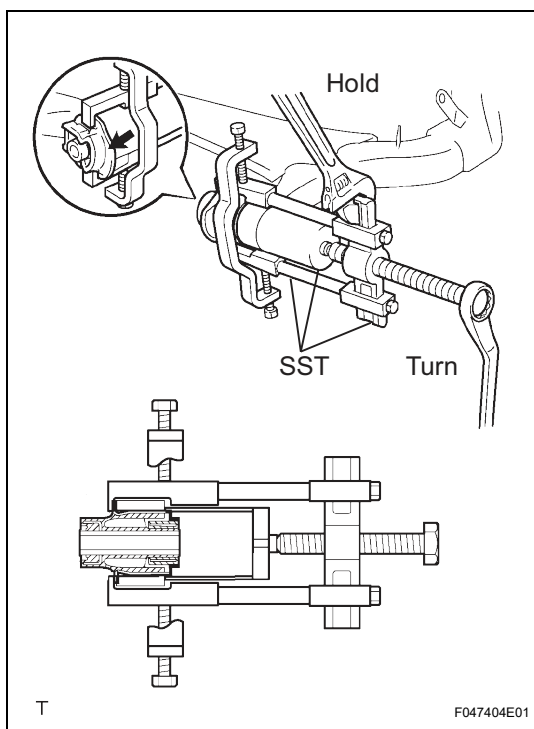
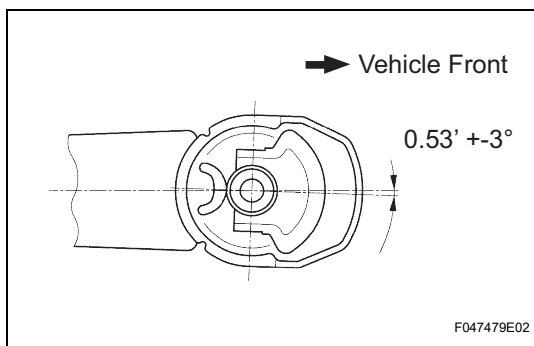

- (c) Using SST, install the bush to the rear axle beam.
SST 09950-40011 (09951-04020, 09952-04010, 09953-04030, 09954-04020, 09955-04051, 09957-04010, 09958-04011), 09950-60010 (09951-00620), 09710-04101

NOTICE:

- Hang the claw of SST to the bush firmly.
- Do not damage the rubber sections indicated by the arrow in the illustration when installing the bush.

2. INSTALL REAR AXLE CARRIER BUSH RH

HINT:

Use the same procedures for the RH side and LH side.

SP

INSTALLATION

1. TEMPORARILY TIGHTEN REAR AXLE BEAM ASSEMBLY

- (a) Support the rear axle beam with a jack. Insert a wooden block between the jack and the center of the rear axle beam to prevent damage.
- (b) Slowly raise the jack to install the rear axle beam on the vehicle. Insert the 2 bolts from the inner side of the vehicle and temporarily tighten them with the 2 nuts (1 nut and bolt each for the left and right sides).

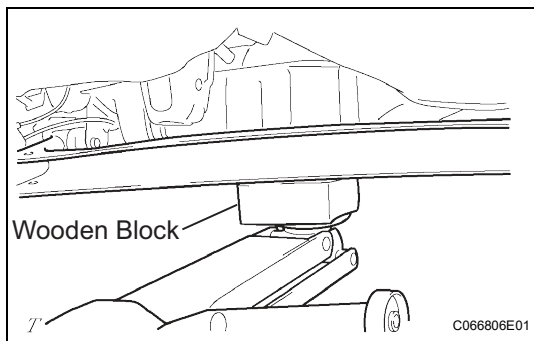

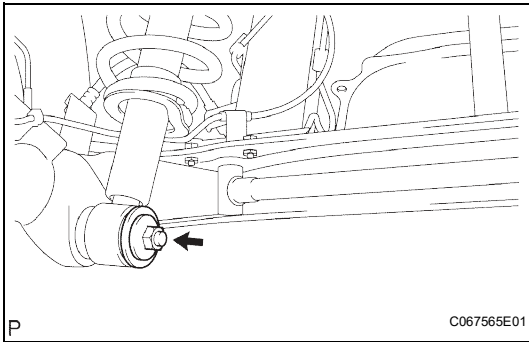

2. TEMPORARILY TIGHTEN REAR SHOCK ABSORBER WITH COIL SPRING

- (a) Install the left and right side rear shock absorber with coil spring (lower side) to the rear axle beam. Temporarily tighten the nuts.

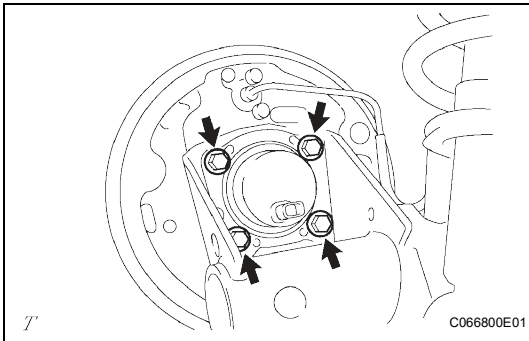

3. INSTALL REAR AXLE HUB AND BEARING ASSEMBLY LH

- (a) Install the parking brake plate and the axle hub and bearing to the rear axle beam with the 4 bolts.
Torque: 61 N*m (622 kgf*cm, 45 ft.*lbf)

4. INSTALL REAR AXLE HUB AND BEARING ASSEMBLY RH

HINT:

Use the same procedures for the RH side and LH side.

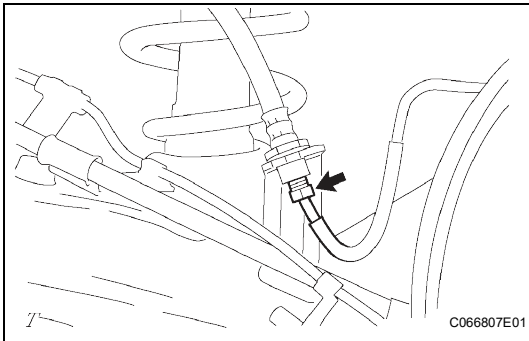

5. CONNECT REAR NO. 4 BRAKE TUBE

- (a) Temporarily tighten the rear brake tube and flexible hose.

NOTICE:

- Do not damage the rear brake tube or flexible hose.
- Replace the rear brake tube and flexible hose with new parts if they are damaged.

- (b) Install the rear brake tube to the rear axle beam and secure it with the clip.

- (c) Fully tighten the rear brake tube using SST.

SST 09023-00101

Torque: 15 N*m (155 kgf*cm, 11 ft.*lbf)

6. CONNECT REAR NO. 3 BRAKE TUBE

HINT:

Use the same procedures as the rear No. 4 brake tube.

7. INSTALL REAR STABILIZER BAR (See page SP-45)

8. INSTALL REAR AXLE BEAM DAMPER (See page SP-45)

9. CONNECT SKID CONTROL SENSOR WIRE

- (a) Install the skid control sensor wire and parking brake cable to the rear axle beam using the 2 bolts and clip.

Torque: 5.4 N*m (55 kgf*cm, 48 in.*lbf) for bolt A

5.0 N*m (51 kgf*cm, 44 in.*lbf) for bolt B

NOTICE:

Do not twist the skid control sensor wire while installing it.

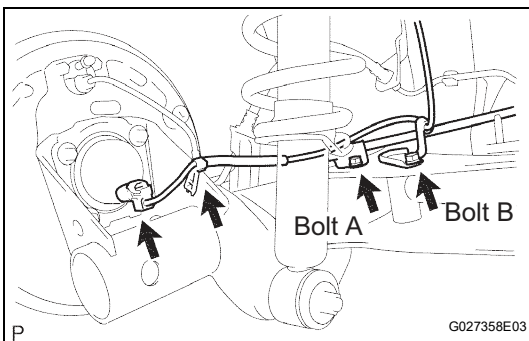
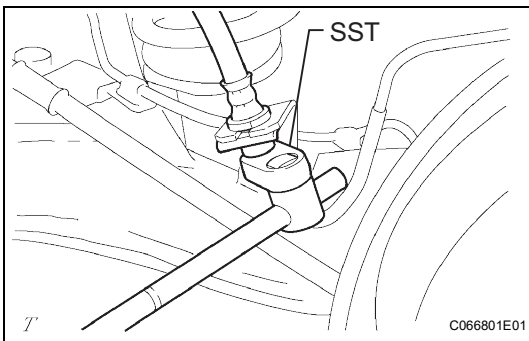

HINT:

Use the same procedures for the RH side and LH side.

10. INSTALL REAR BRAKE DRUM SUB-ASSEMBLY (See page BR-53)

11. INSTALL FRONT WHEEL

- (a) Install the rear wheel.

Torque: 103 N*m (1,050 kgf*cm, 76 ft.*lbf)

12. STABILIZE SUSPENSION

- (a) After jacking down the vehicle, bounce the vehicle up and down to stabilize the rear suspension.

13. FULLY TIGHTEN REAR AXLE BEAM ASSEMBLY

- (a) Hold the nut and rotate the bolt to fully tighten the rear axle beam on the LH side.

Torque: 85 N*m (867 kgf*cm, 63 ft.*lbf)

NOTICE:

Ensure the vehicle is lowered to the ground.

HINT:

Use the same procedures for the RH side and LH side.

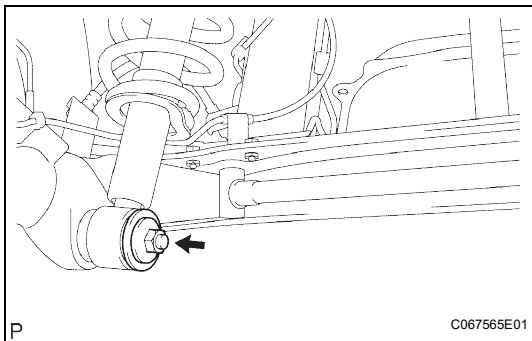
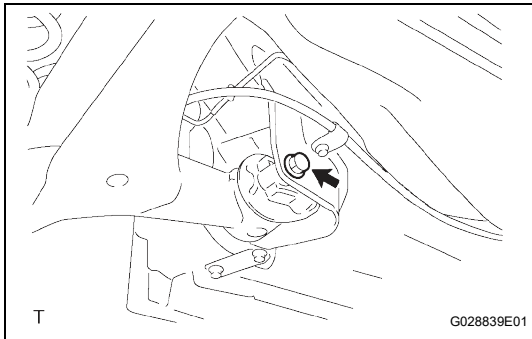

14. FULLY TIGHTEN REAR SHOCK ABSORBER WITH COIL SPRING

- (a) Install the rear shock absorber with coil spring (lower side) and tighten the nut.

Torque: 80 N*m (816 kgf*cm, 59 ft.*lbf)

NOTICE:

Ensure the vehicle is lowered to the ground.

HINT:

Use the same procedures for the RH side and LH side.

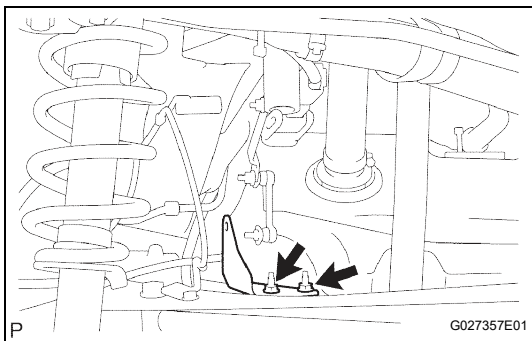

15. INSTALL REAR SENSOR CONNECTING BRACKET (w/ HID Headlight System)

- (a) Install the sensor connecting bracket with the 2 nuts.

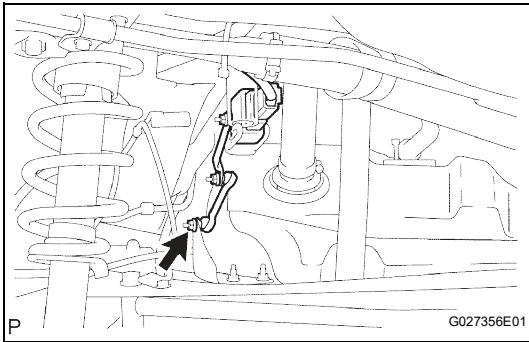

16. INSTALL REAR HEIGHT CONTROL SENSOR SUB-ASSEMBLY LH (w/ HID Headlight System)

- (a) Install the height control sensor with the nut.

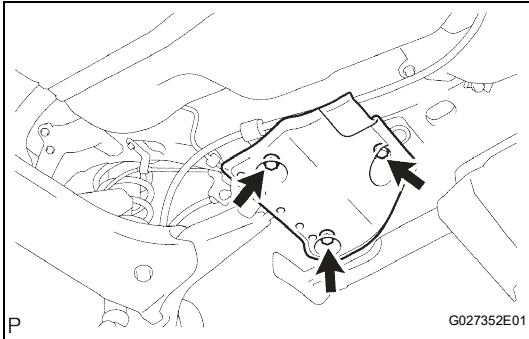

17. INSTALL FLOOR PANEL SIDE PLATE LH

- (a) Install the floor panel side plate with the 3 bolts.

18. INSTALL FLOOR PANEL SIDE PLATE RH

- (a) Install the floor panel side plate with the 3 bolts.

19. BLEED BRAKE LINE

- (a) Bleed brake line (see page [BR-3](#)).

20. INSPECT BRAKE FLUID

21. INSPECT REAR WHEEL ALIGNMENT

- (a) Inspect the rear wheel alignment (see page [SP-10](#)).

22. PERFORM INITIALIZATION

- (a) Perform the initialization (see page [IN-32](#)).

NOTICE:

Certain systems need to be initialized after disconnecting and reconnecting the cable from the negative (-) battery terminal.

23. ADJUST HEADLIGHT AIM ONLY (See page [LI-80](#))

24. CHECK SPEED SENSOR SIGNAL

- (a) Check the speed sensor signal (see page [BC-37](#)).

REAR STABILIZER BAR

COMPONENTS

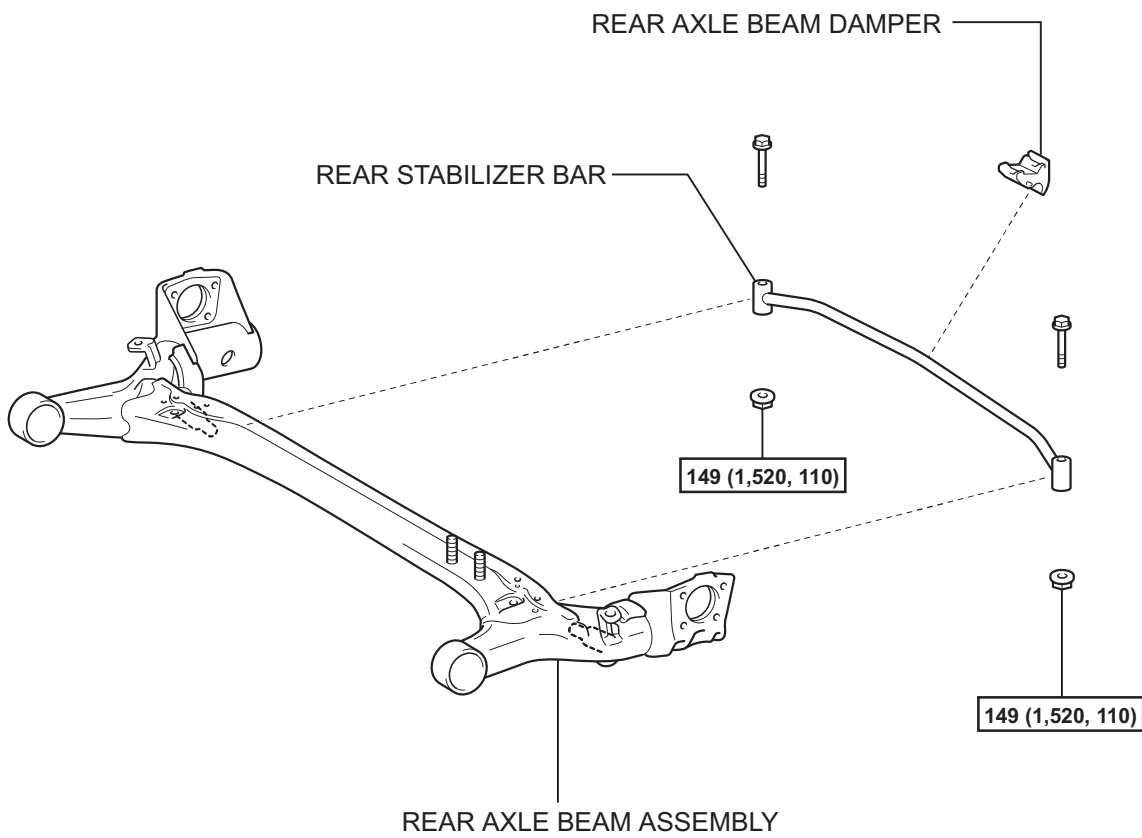

[N*m (kgf*cm, ft.*lbf)] : Specified torque

REMOVAL

1. **REMOVE REAR AXLE BEAM DAMPER**
 - (a) Remove the rear axle beam damper from the rear axle beam.
2. **REMOVE REAR STABILIZER BAR**
 - (a) Remove the 2 bolts, 2 nuts and stabilizer bar.

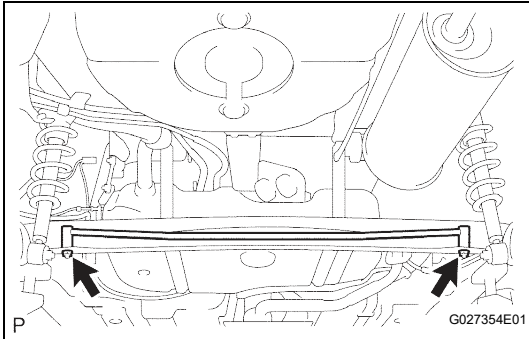

INSTALLATION

1. **INSTALL REAR STABILIZER BAR**
 - (a) Install the stabilizer bar so that the mark position faces towards the vehicle's rear right. Hold the bolts and tighten the nuts.
Torque: 149 N*m (1,520 kgf*cm, 110 ft.*lbf)

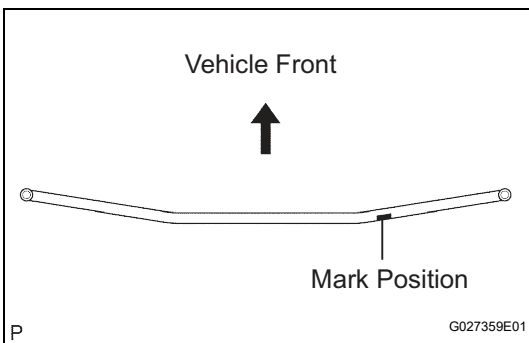

2. **INSTALL REAR AXLE BEAM DAMPER**
 - (a) Install the rear axle beam damper to the center of the rear axle beam.

