

Last Modified: 01-14-2019	6.8:8.0.48	Doc ID: RM100000000S1MP
Model Year Start: 2016	Model: Prius	Prod Date Range: [11/2015 - ]
Title: WIPER / WASHER: FRONT WIPER RUBBER: COMPONENTS; 2016 - 2019 MY Prius [11/2015 - ]		

## COMPONENTS

## ILLUSTRATION

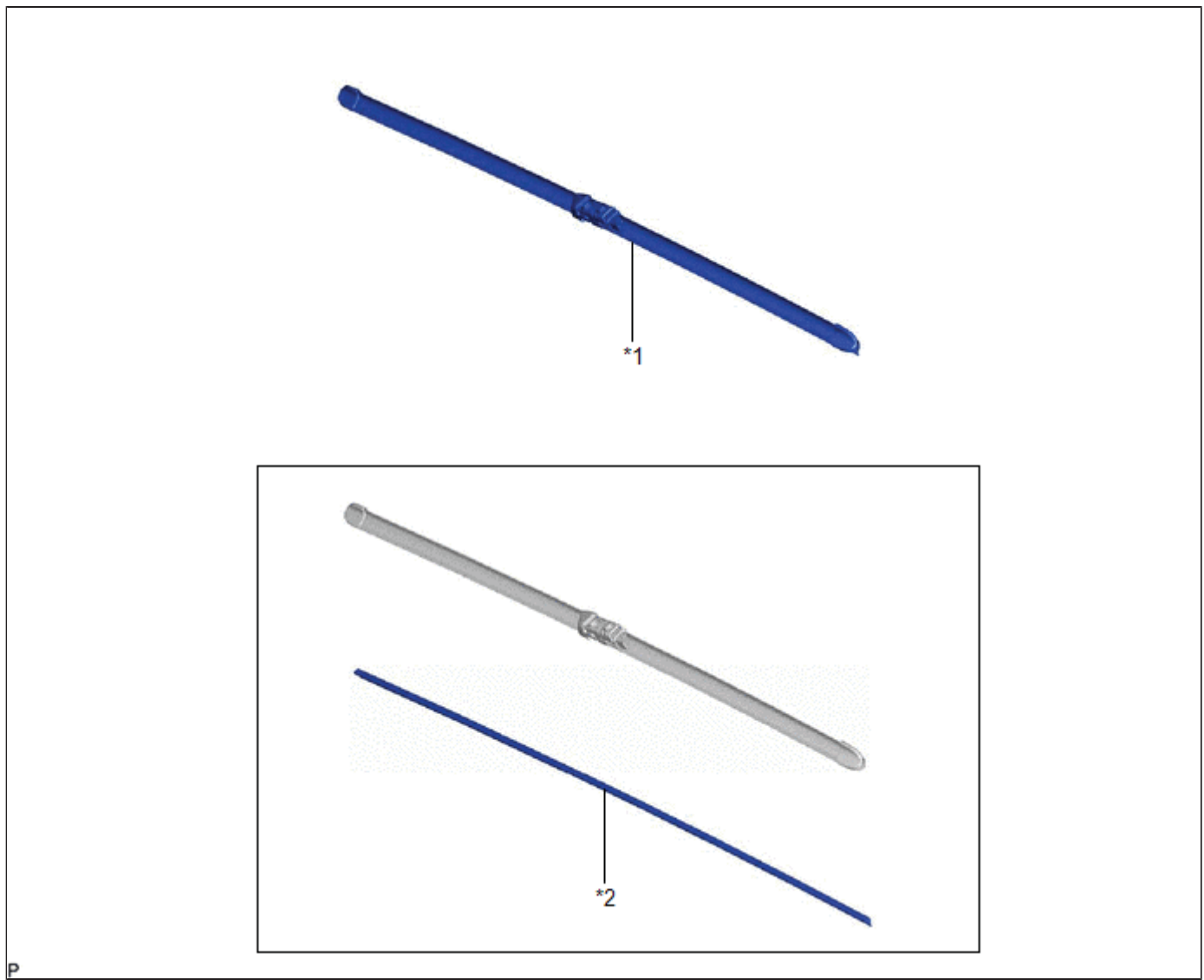

*1	FRONT WIPER BLADE	*2	WIPER RUBBER
----	-------------------	----	--------------

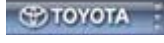

Last Modified: 01-14-2019	6.8:8.0.48	Doc ID: RM100000000S1MQ
Model Year Start: 2016	Model: Prius	Prod Date Range: [11/2015 - ]
Title: WIPER / WASHER: FRONT WIPER RUBBER: REPLACEMENT; 2016 - 2019 MY Prius [11/2015 - ]		

## REPLACEMENT

### CAUTION / NOTICE / HINT

**NOTICE:**

Make sure to hold the front wiper arm while lifting it as lifting the front wiper arm by the front wiper blade may damage or deform the front wiper blade.

**HINT:**

- Use the same procedure for the RH side and LH side.
- The following procedure is for the LH side.

## PROCEDURE

### 1. REMOVE FRONT WIPER BLADE

(a) Push the lock button of the front wiper blade to release the lock.

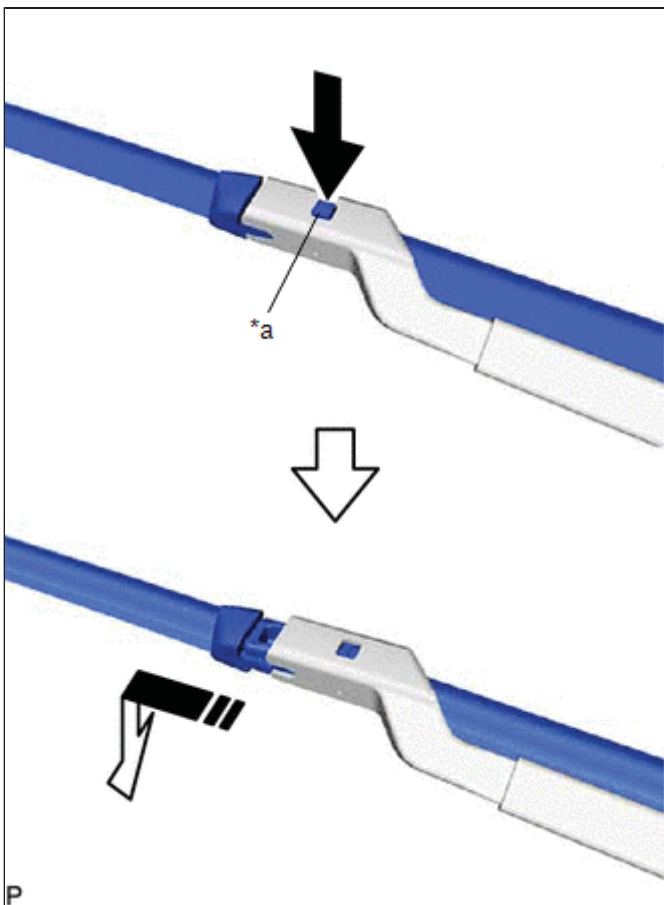

*a	Lock Button
	Push

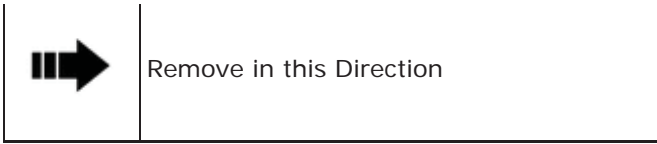

(b) Remove the front wiper blade from the front wiper arm as shown in the illustration.

**NOTICE:**

Place a piece of cloth between the front wiper arm and windshield glass to avoid damaging the windshield glass.

**2. REMOVE WIPER RUBBER**

**HINT:**

The wiper rubber can be removed from either end of the front wiper blade.

(a) Gradually slide the wiper rubber until the end of the wiper rubber is aligned with the slits in the front wiper blade as shown in the illustration.

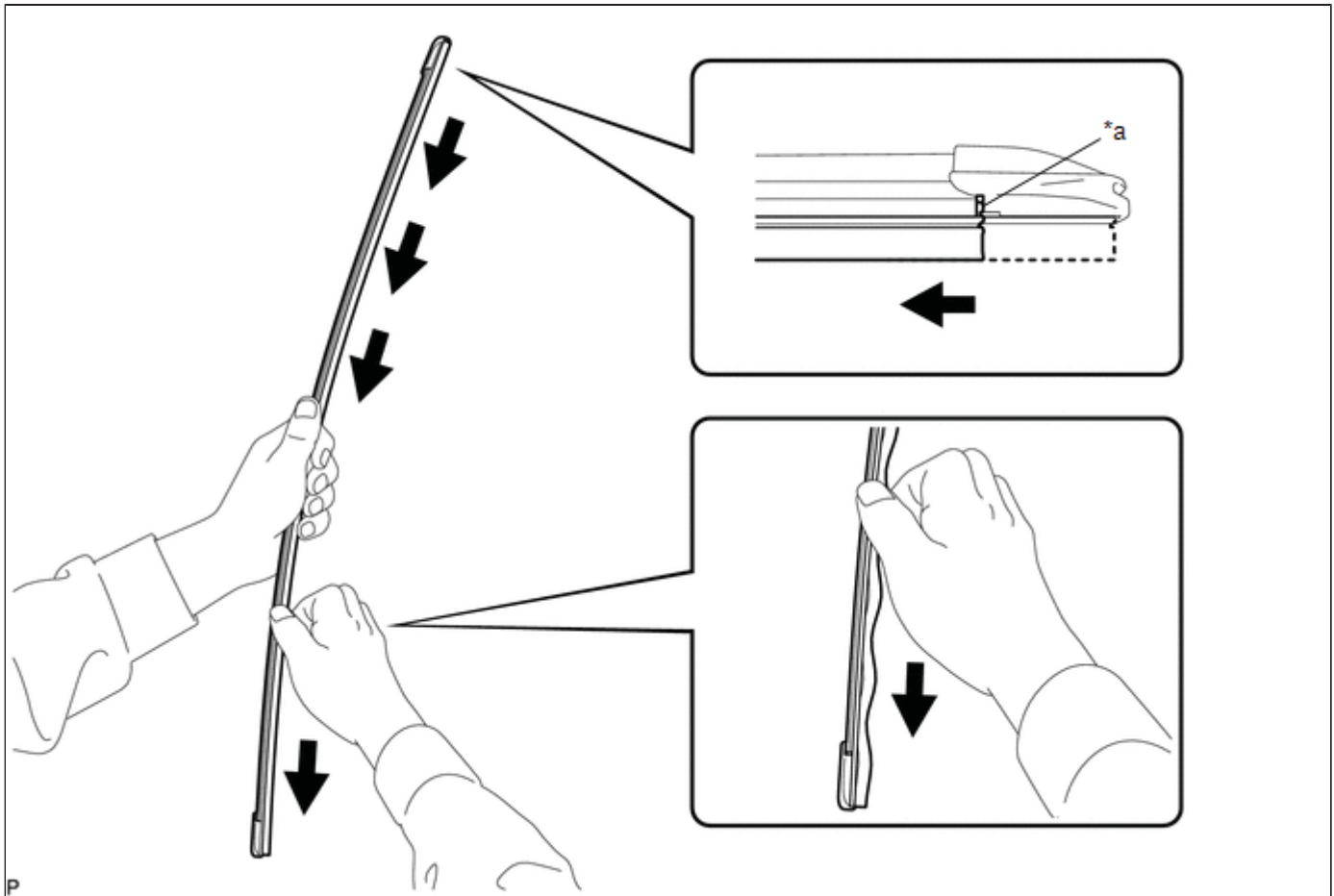

*a	Slit	-	-
----	------	---	---

(b) Pull the end of the wiper rubber through the slits in the front wiper blade in the direction indicated by the arrow shown in the illustration and remove the wiper rubber.

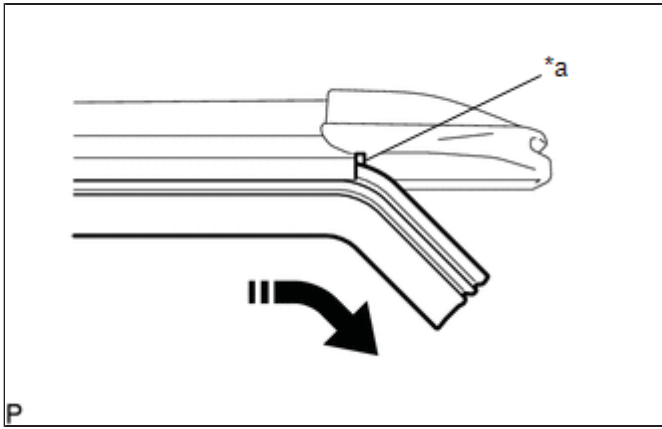

*a	Slit
	Remove in this Direction

### 3. INSTALL WIPER RUBBER

#### HINT:

The wiper rubber can be installed through either end of the front wiper blade.

(a) Insert the wiper rubber through the slit in the front wiper blade as shown in the illustration.

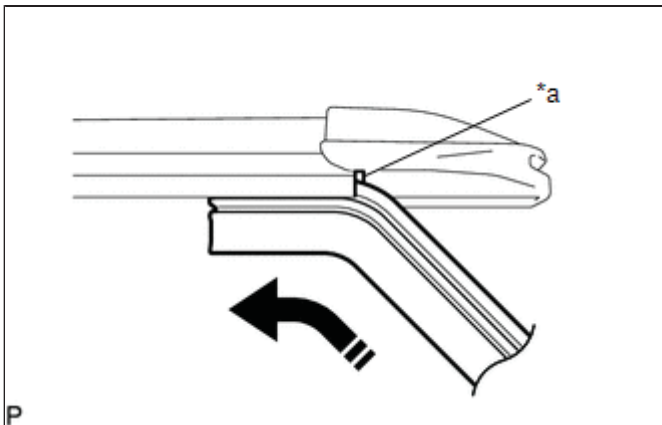

*a	Slit
	Install in this Direction

(b) Gradually slide the wiper rubber until the end of the wiper rubber is aligned with the slits in the front wiper blade as shown in the illustration.

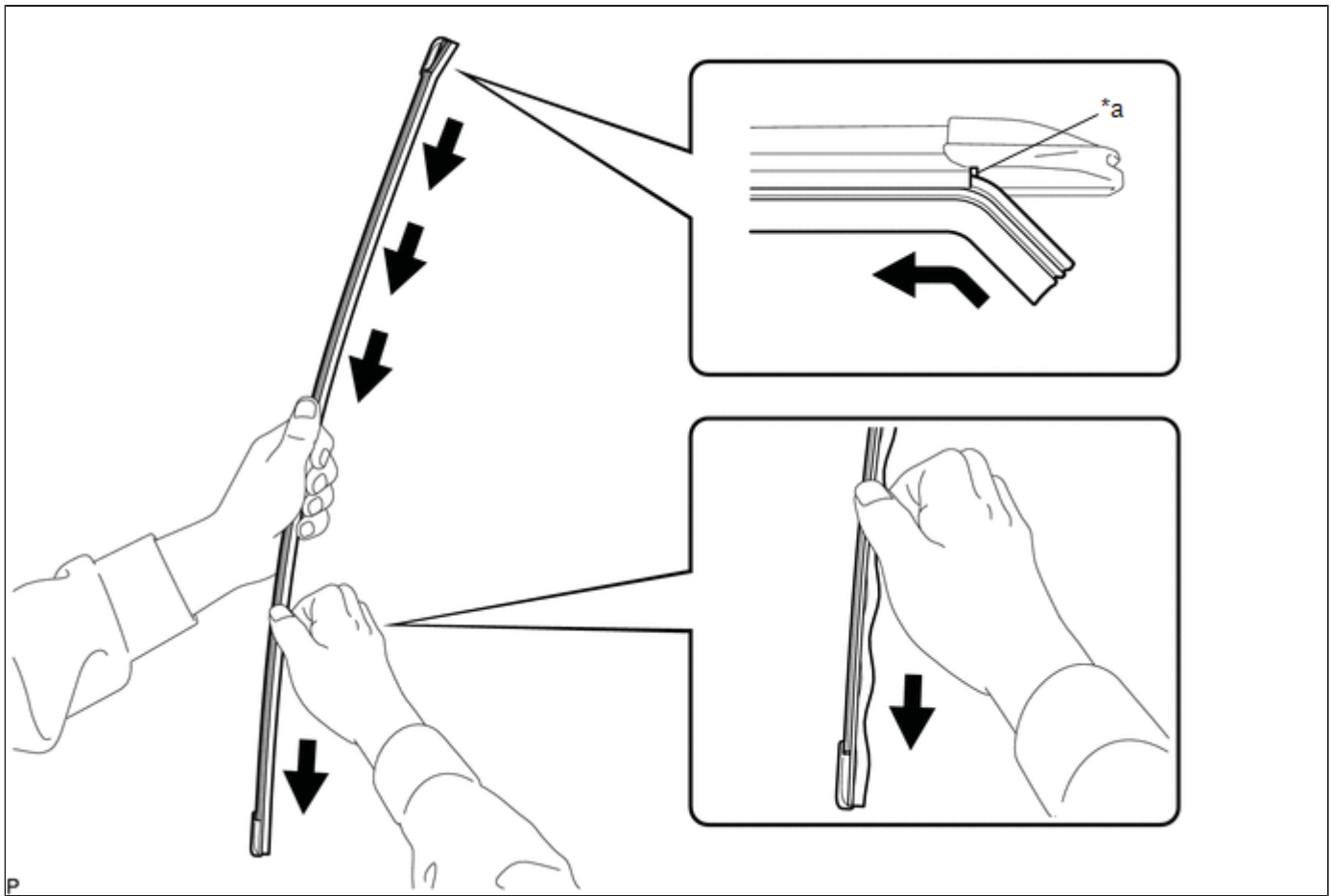

*a	Slit	-	-
----	------	---	---

(c) Slide the wiper rubber in the direction indicated by the arrow shown in the illustration to install it.

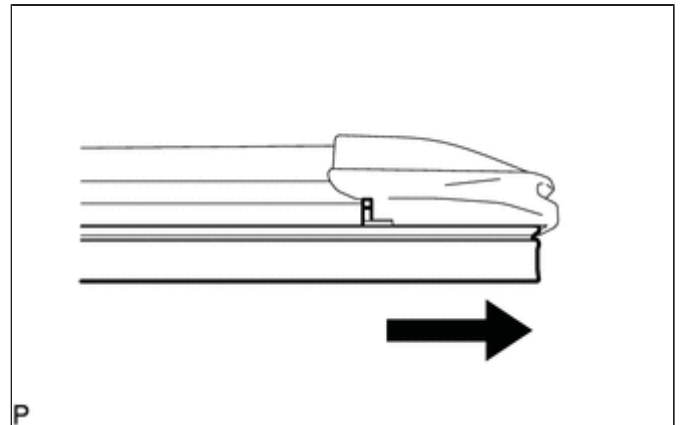

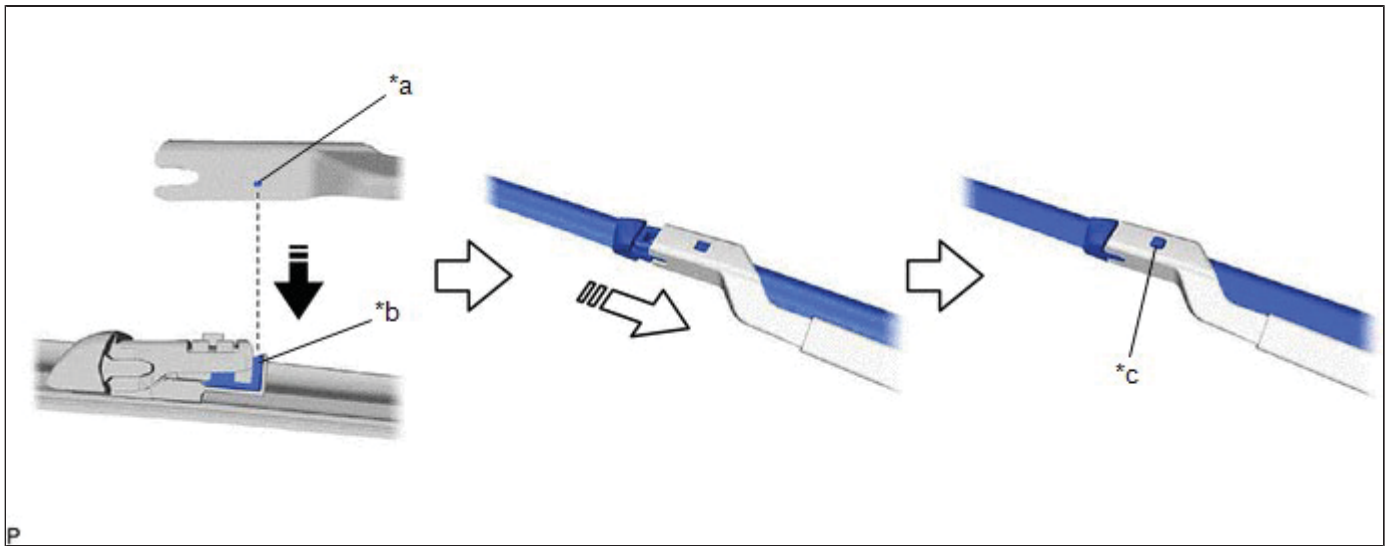

#### 4. INSTALL FRONT WIPER BLADE

(a) Insert the protrusion of the front wiper arm into the groove of the front wiper blade in the direction indicated by the arrow (1) shown in the illustration.



P

*a	Protrusion of Front Wiper Arm	*b	Groove of Front Wiper Blade
*c	Lock Button	-	-
	Install in this Direction (1)		Install in this Direction (2)

(b) Slide the front wiper blade in the direction indicated by the arrow (2) shown in the illustration until the lock button locks to install the front wiper blade.

**NOTICE:**

Make sure that the lock button locks so that it is installed securely.



Last Modified: 01-14-2019	6.8:8.0.48	Doc ID: RM100000000S1MR
Model Year Start: 2016	Model: Prius	Prod Date Range: [11/2015 - ]
Title: WIPER / WASHER: REAR WIPER RUBBER: COMPONENTS; 2016 - 2019 MY Prius [11/2015 - ]		

## COMPONENTS

## ILLUSTRATION

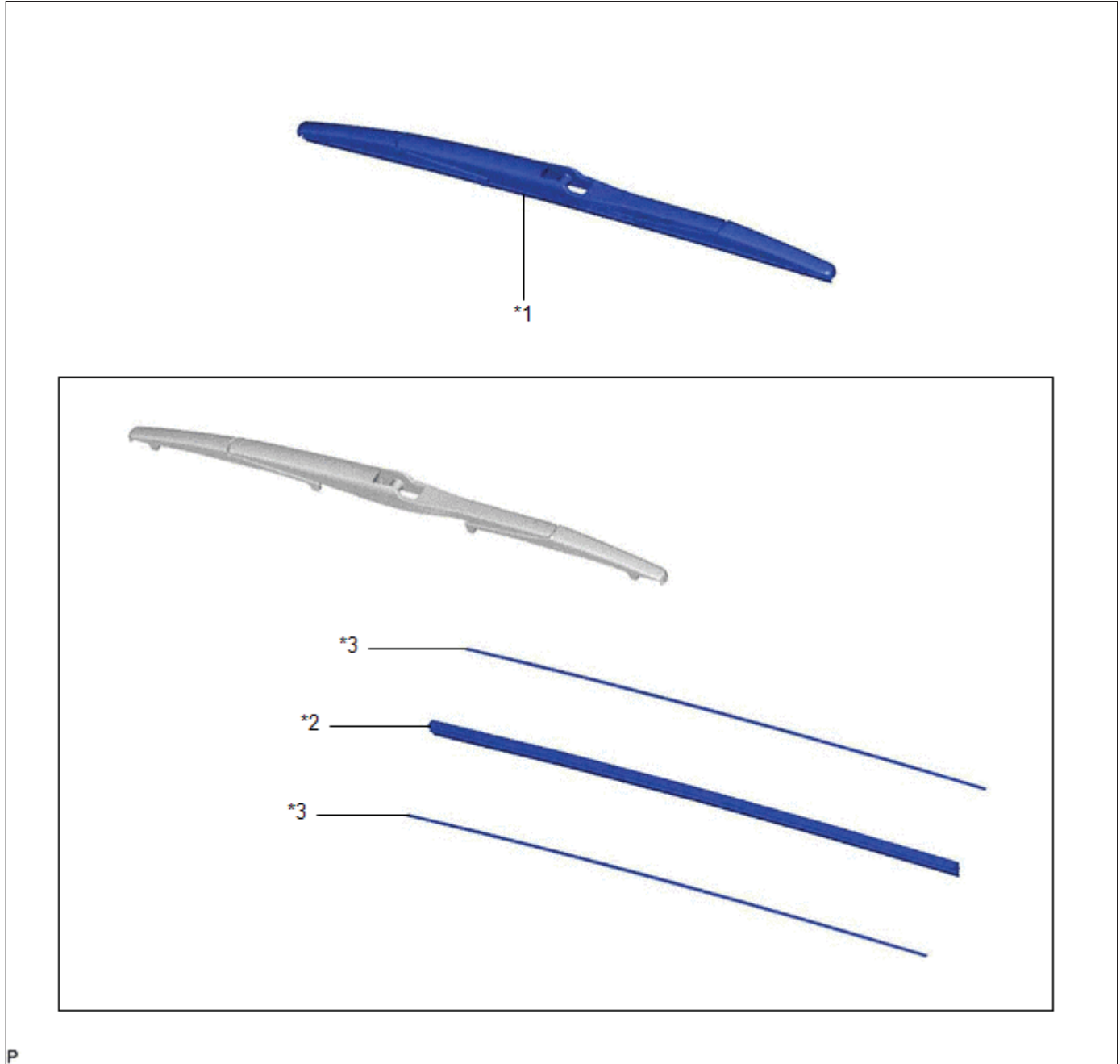

*1	REAR WIPER BLADE	*2	REAR WIPER RUBBER
*3	REAR WIPER RUBBER BACKING PLATE	-	-



Last Modified: 01-14-2019

6.8:8.0.48

Doc ID: RM100000000S1MS

Model Year Start: 2016

Model: Prius

Prod Date Range: [11/2015 - ]

Title: WIPER / WASHER: REAR WIPER RUBBER: REPLACEMENT; 2016 - 2019 MY Prius [11/2015 - ]

## REPLACEMENT

### PROCEDURE

#### 1. REMOVE REAR WIPER BLADE

- (a) Slide the rear wiper arm head cap as shown in the illustration to disengage the 2 claws.

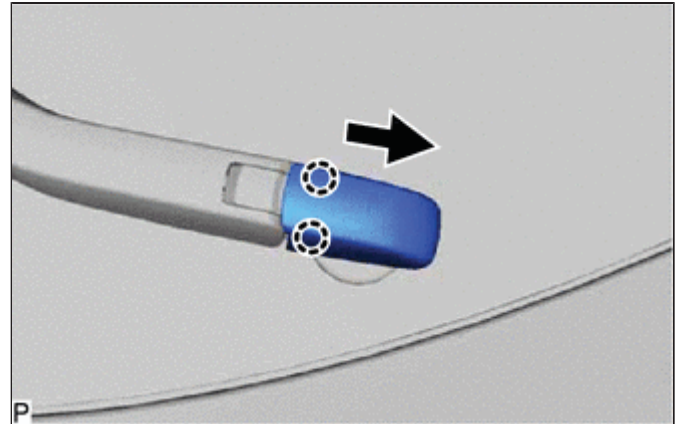

- (b) Lift the rear wiper arm and blade assembly as shown in the illustration.

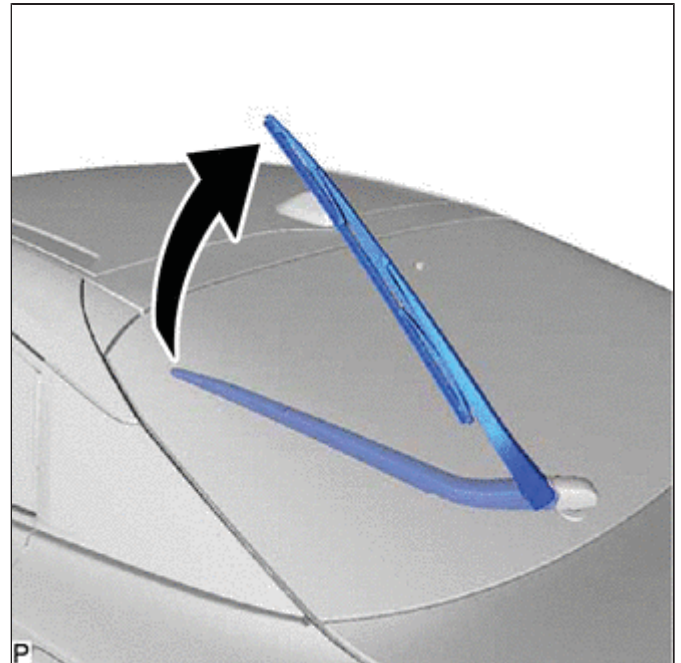



(c) Raise the rear wiper blade to the position where the claw disengages with a click sound as shown in the illustration.

**NOTICE:**

Be careful not to damage the claw.

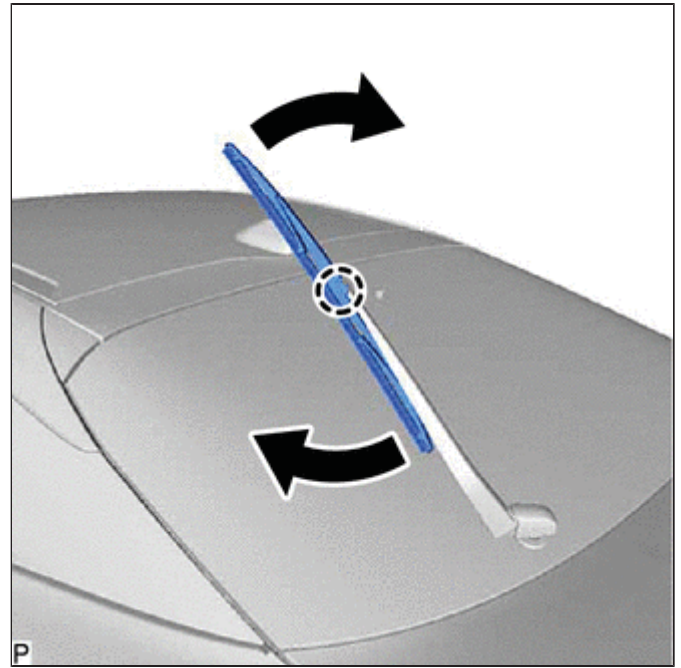

(d) Pull the rear wiper blade as shown in the illustration to remove it from the rear wiper arm.

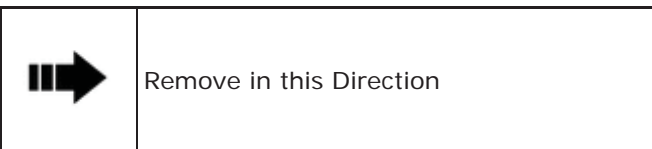
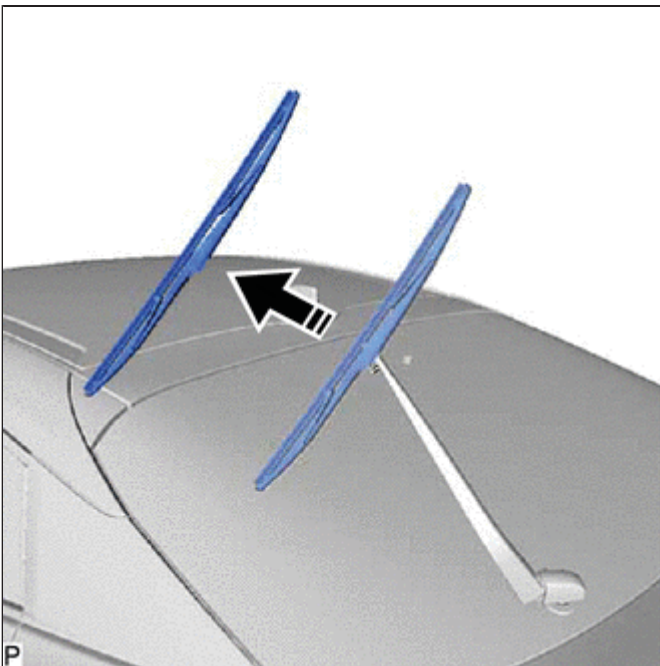

**NOTICE:**

Place a piece of cloth between the rear wiper arm and back door glass to avoid damaging the back door glass.

**2. REMOVE REAR WIPER RUBBER**

(a) Lift and pull the end of the rear wiper rubber over the blade stopper as shown in the illustration.

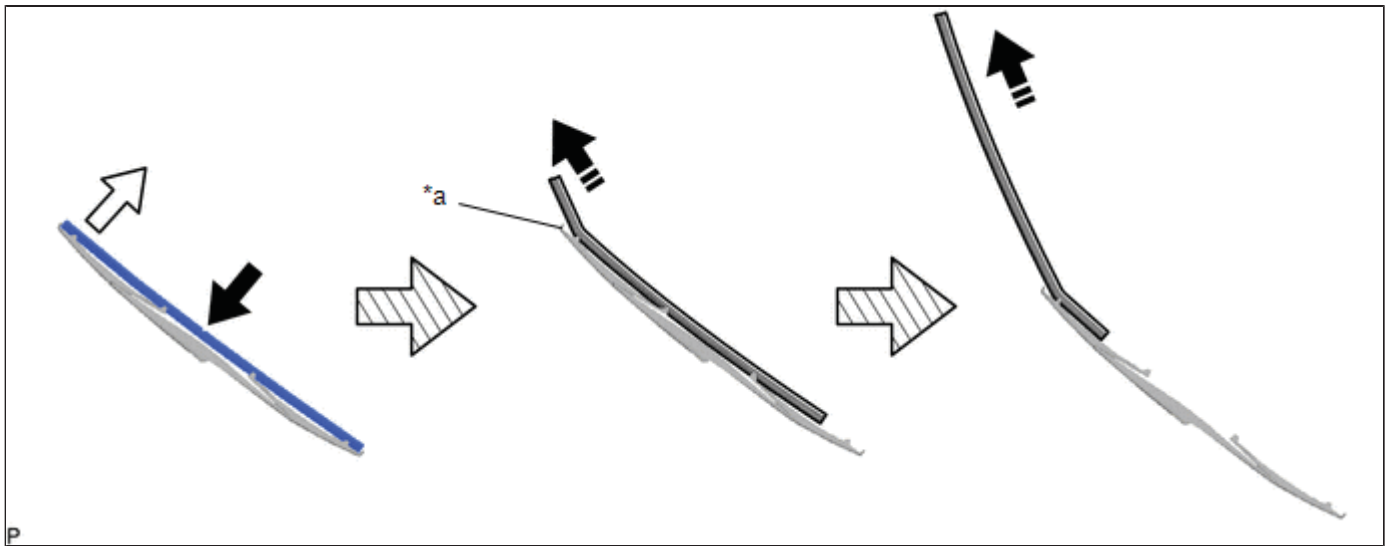

*a	Stopper	-	-
	Push		Pull Out
	Remove in this Direction	-	-

**NOTICE:**

Do not forcibly pull out the rear wiper rubber as the rear wiper rubber backing plates may be deformed or the claws of the rear wiper blade may be damaged.

**HINT:**

Lightly pushing the middle of the rear wiper rubber will allow it to be removed more easily.

- (b) Remove the rear wiper rubber with the 2 rear wiper rubber backing plates from the rear wiper blade.
- (c) Remove the 2 rear wiper rubber backing plates from the rear wiper rubber.

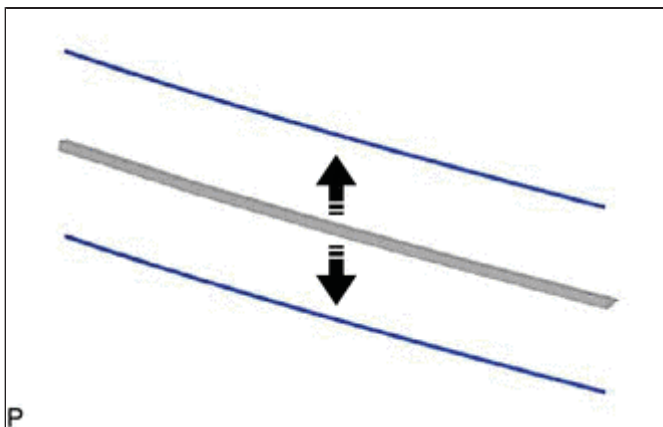

	Remove in this Direction
--	--------------------------

**3. INSTALL REAR WIPER RUBBER**

- (a) Install the 2 rear wiper rubber backing plates to the rear wiper rubber.

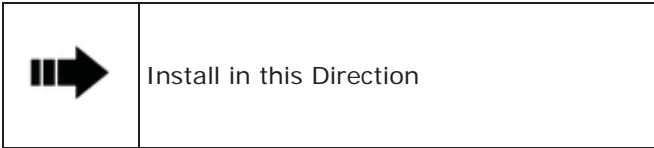
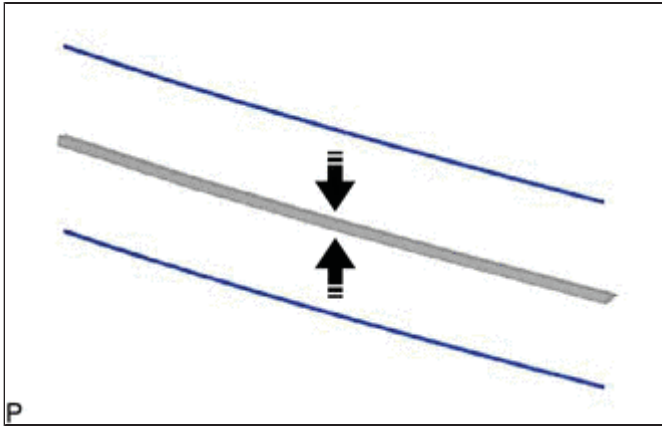

**NOTICE:**

Install the backing plates facing the correct direction.

(b) Insert the rear wiper rubber with the 2 rear wiper rubber backing plates through the second claw from the front of the rear wiper blade and then push it through each claw until the rear claw.

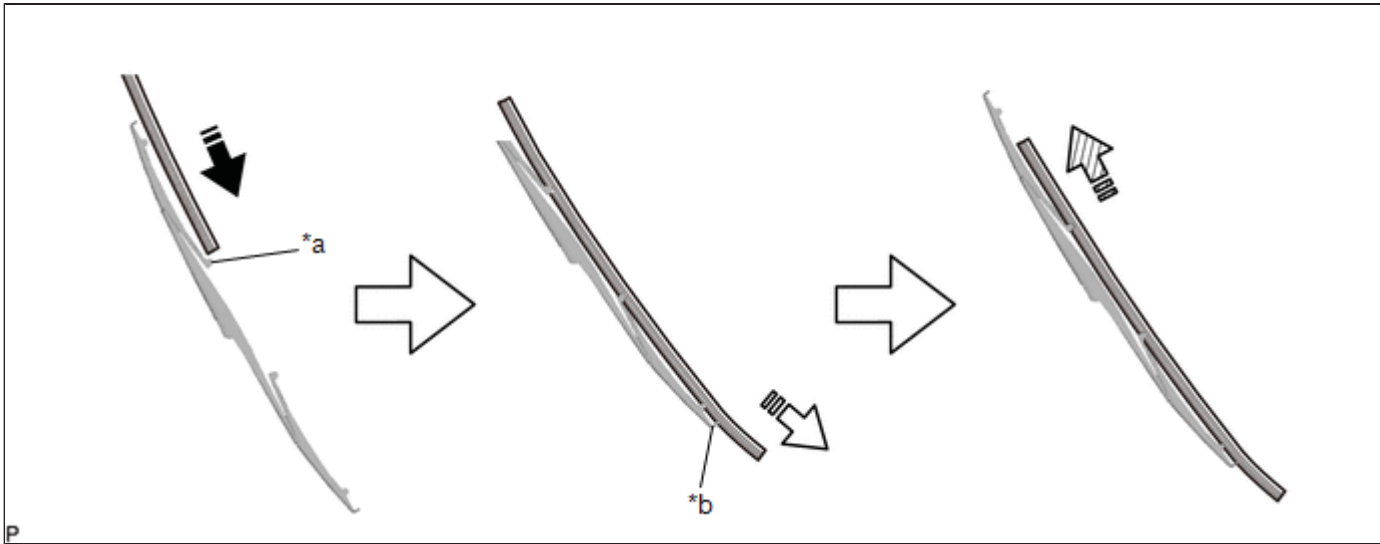

*a	Second Claw	*b	Stopper
	Install in this Direction (1)		Install in this Direction (2)
	Install in this Direction (3)	-	-

(c) After pushing the rear wiper rubber through the rear claw, pull it slightly over the rear stopper.

(d) Slide the rear wiper rubber through the front claw.

(e) Securely engage the rear wiper blade claw to the rear wiper rubber groove as shown in the illustration.

**HINT:**

- If the front claw of the rear wiper blade is not in the rear wiper rubber groove, grasp the rear wiper rubber and slide it up and down multiple times to insert the claw into the groove.
- Applying a small amount of window washer fluid to the rear wiper rubber can make it easier to insert the claw into the groove.

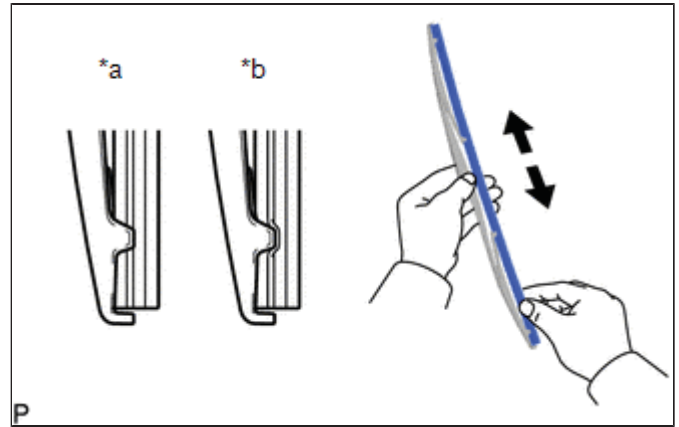

*a	Correct
*b	Incorrect

**4. INSTALL REAR WIPER BLADE**

(a) Push the rear wiper blade as shown in the illustration to install it to the rear wiper arm.

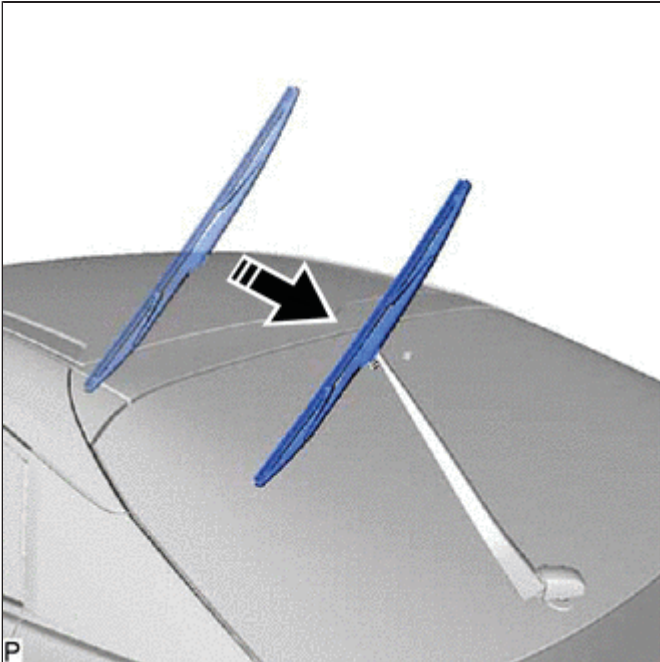

	Install in this Direction
--	---------------------------

(b) Engage the claw to install the rear wiper blade as shown in the illustration.

**NOTICE:**

Be careful not to damage the claw.

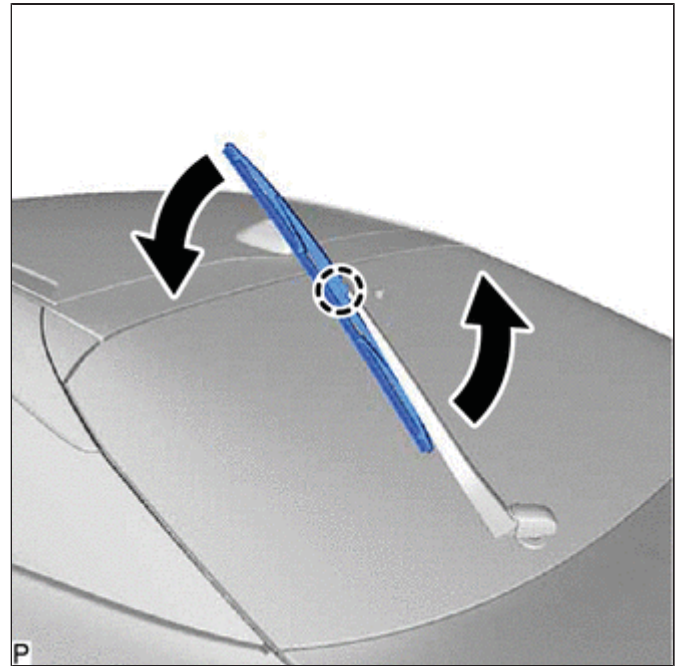

(c) Lower the rear wiper arm and blade assembly as shown in the illustration.

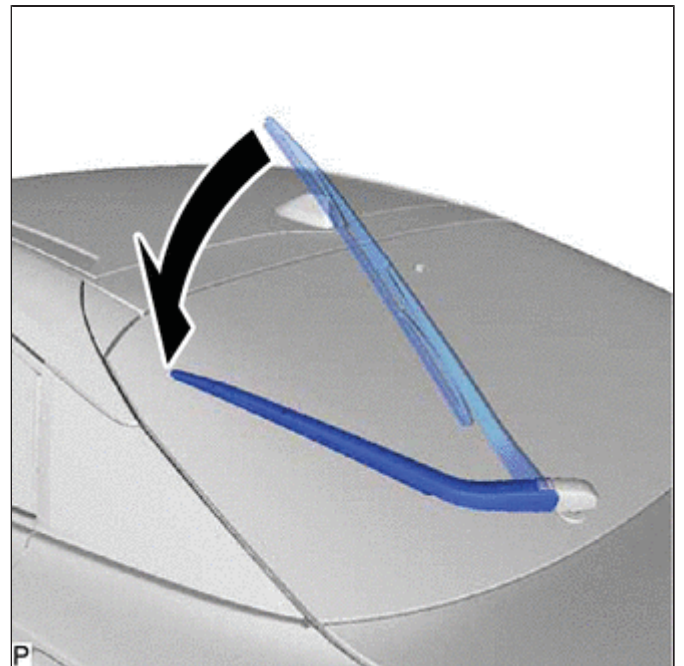

(d) Slide the rear wiper arm head cap to engage the 2 claws as shown in the illustration.

