

Last Modified: 5-3-2010	6.4 A	From: 200904
Model Year: 2010	Model: Prius	Doc ID: RM000001OUP00GX
Title: WIPER / WASHER: WIPER SWITCH: REMOVAL (2010 Prius)		

REMOVAL

1. REMOVE LOWER STEERING COLUMN COVER

NOTICE:

Removing the lower steering column cover in the incorrect order will cause the lower steering column cover to break.

- (a) Release the tilt and telescopic lever, and fully extend and lower the steering column assembly.
- (b) Lock the tilt and telescopic lever.



- (c) Push the right and left sides of the lower steering column cover to disengage the 4 claws.

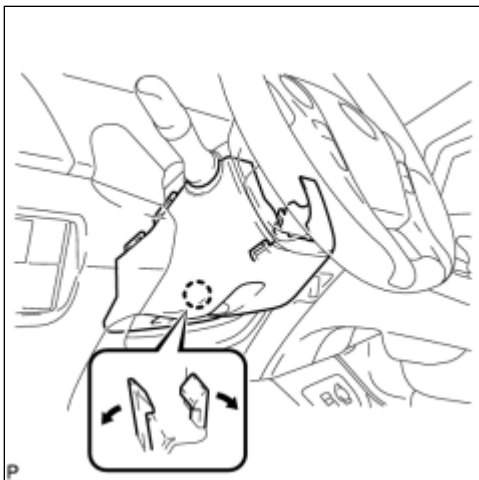

- (d) Insert fingers into the opening of the tilt lever of the lower steering column cover to disengage the claw.

HINT:

Spread the claw to disengage it.

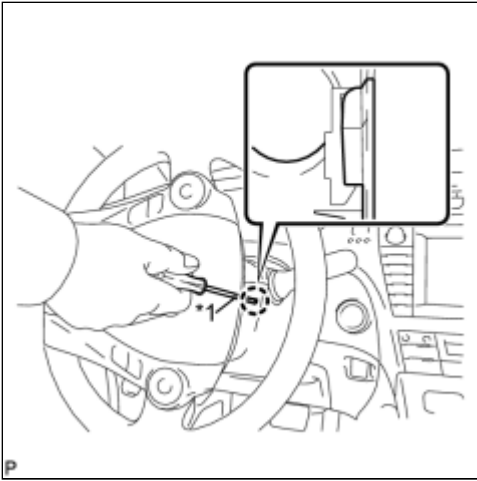

(e) Turn the steering wheel assembly to the right.

(f) Using a screwdriver, disengage the claw as shown in the illustration.

Text in Illustration

*1	Protective Tape
----	-----------------

HINT:

Tape the screwdriver tip before use.

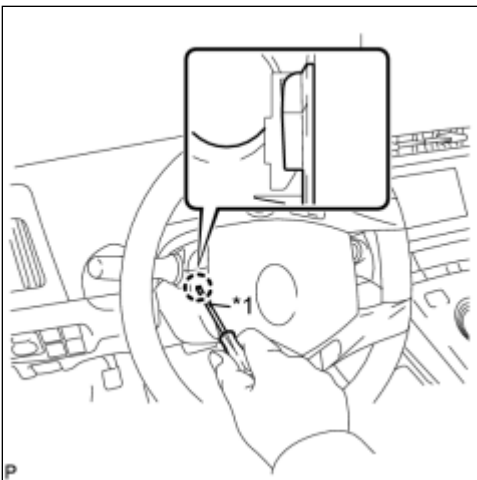

(g) Turn the steering wheel assembly to the left.

(h) Using a screwdriver, disengage the claw as shown in the illustration.

Text in Illustration

*1	Protective Tape
----	-----------------

HINT:

Tape the screwdriver tip before use.

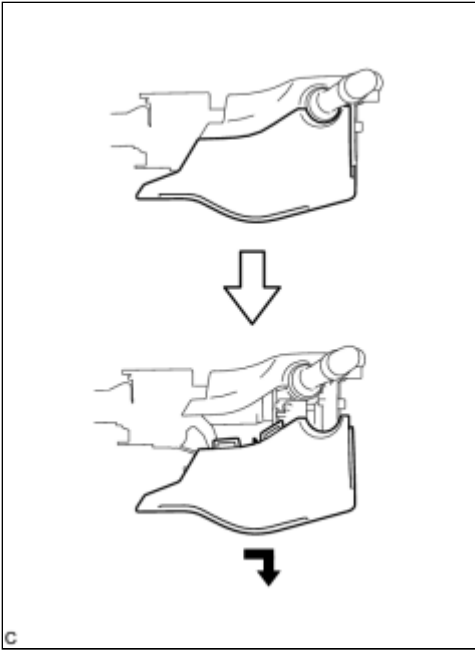

(i) Remove the lower steering column cover as shown in the illustration.

2. REMOVE UPPER STEERING COLUMN COVER

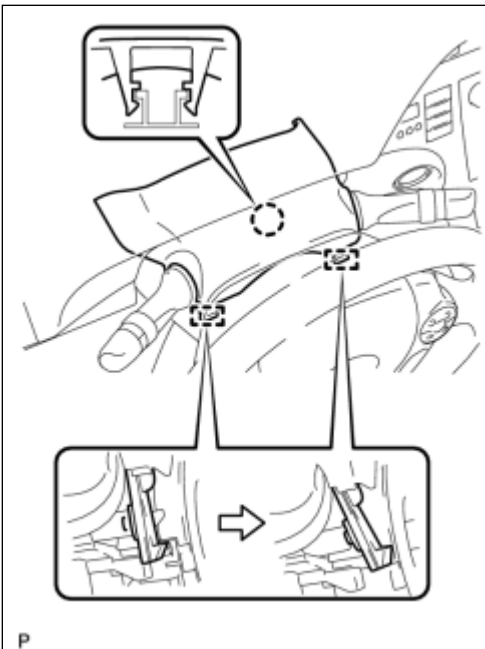

(a) Disengage the claw and 2 pins, and remove the upper steering column cover.

3. REMOVE WINDSHIELD WIPER SWITCH ASSEMBLY

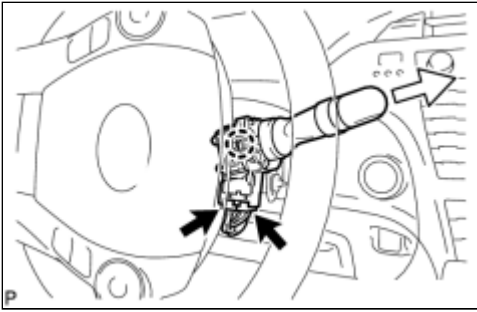

(a) Turn the steering wheel assembly to the right.

(b) Disconnect the 2 connectors.

(c) Disengage the claw and remove the windshield wiper switch assembly as shown in the illustration.

NOTICE:

If the claw is pushed with excessive force, it may break.

