

Last Modified: 5-3-2010	6.4 A	From: 200904
Model Year: 2010	Model: Prius	Doc ID: RM000000UX402XX
Title: SUPPLEMENTAL RESTRAINT SYSTEMS: KNEE AIRBAG ASSEMBLY: REMOVAL (2010 Prius)		

REMOVAL

1. PRECAUTION

CAUTION:

Be sure to read Precaution thoroughly before servicing [INFO](#) .

2. REMOVE REAR NO. 2 FLOOR BOARD (for Separate Type) [INFO](#)

3. REMOVE REAR DECK FLOOR BOX [INFO](#)

4. REMOVE REAR NO. 3 FLOOR BOARD [INFO](#)

5. DISCONNECT CABLE FROM NEGATIVE BATTERY TERMINAL

CAUTION:

Wait at least 90 seconds after disconnecting the cable from the negative (-) battery terminal to disable the SRS system.

NOTICE:

When disconnecting the cable, some systems need to be initialized after the cable is reconnected [INFO](#) .

6. REMOVE REAR CONSOLE BOX ASSEMBLY

HINT:

Refer to the procedure up to Remove Rear Console Box Assembly [INFO](#) .

7. REMOVE INTEGRATION CONTROL AND PANEL ASSEMBLY [INFO](#)

8. REMOVE LOWER CENTER INSTRUMENT CLUSTER FINISH PANEL SUB-ASSEMBLY [INFO](#)

9. REMOVE INSTRUMENT CLUSTER FINISH PANEL GARNISH [INFO](#)

10. REMOVE UPPER INSTRUMENT PANEL FINISH PANEL SUB-ASSEMBLY [INFO](#)

11. REMOVE RADIO RECEIVER WITH BRACKET (w/o Navigation System) [INFO](#)

12. REMOVE NAVIGATION RECEIVER WITH BRACKET (w/ Navigation System) [INFO](#)

13. REMOVE NO. 1 SIDE DEFROSTER NOZZLE [INFO](#)

14. REMOVE NO. 2 INSTRUMENT PANEL REGISTER [INFO](#)

15. REMOVE GLOVE COMPARTMENT DOOR [INFO](#)

16. REMOVE AIR CONDITIONING CONTROL ASSEMBLY [INFO](#)

17. REMOVE SHIFT LOCK CONTROL UNIT ASSEMBLY [INFO](#)

18. REMOVE ELECTRICAL KEY OSCILLATOR [INFO](#)

19. REMOVE NO. 2 CONSOLE BOX MOUNTING BRACKET [INFO](#)

20. REMOVE FRONT NO. 1 CONSOLE BOX INSERT [INFO](#)

21. REMOVE FRONT NO. 2 CONSOLE BOX INSERT INFO

22. REMOVE BOX BOTTOM MAT INFO

23. SEPARATE CONSOLE BOX ASSEMBLY INFO

24. REMOVE UPPER INSTRUMENT PANEL FINISH PANEL ASSEMBLY INFO

25. REMOVE CONSOLE BOX ASSEMBLY INFO

26. REMOVE NO. 1 SWITCH HOLE BASE INFO

27. REMOVE FRONT DOOR SCUFF PLATE LH INFO

28. REMOVE COWL SIDE TRIM SUB-ASSEMBLY LH INFO

29. REMOVE NO. 1 INSTRUMENT PANEL UNDER COVER SUB-ASSEMBLY INFO

30. REMOVE LOWER INSTRUMENT PANEL FINISH PANEL ASSEMBLY INFO

31. REMOVE DRIVER SIDE KNEE AIRBAG ASSEMBLY

CAUTION:

When storing the driver side knee airbag assembly, keep the airbag deployment side facing upward.

- (a) Check that the power switch is off.
- (b) Check that the cable is disconnected from the negative (-) battery terminal.

CAUTION:

Wait at least 90 seconds after disconnecting the cable from the negative (-) battery terminal to disable the SRS system.



(c) Remove the 4 bolts.

(d) Disengage the 2 claws to separate the DLC3.

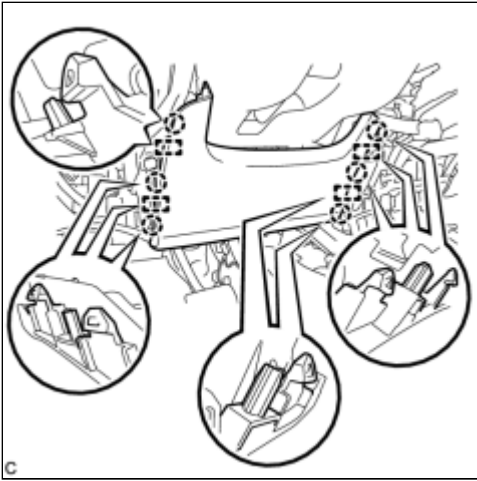

(e) Disengage the 6 claws and 4 guides to separate the driver side knee airbag assembly.

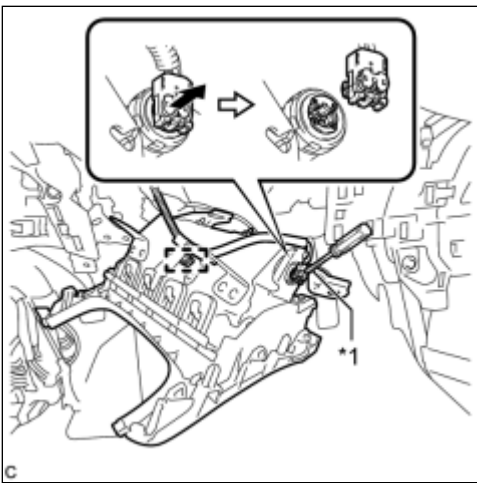

(f) Disengage the clamp to separate the wire harness.

(g) Using a screwdriver with the tip wrapped with protective tape, release the airbag connector lock.

Text in Illustration

*1	Protective Tape
----	-----------------

(h) Disconnect the airbag connector to remove the driver side knee airbag assembly.

NOTICE:

When disconnecting any airbag connector, take care not to damage the airbag wire harness.

