

Luggage compartment features

Cargo hooks

The cargo hooks are provided for securing loose items.

- ▶ Vehicles with emergency tire puncture repair kit (type A)

Raise the hook to use.

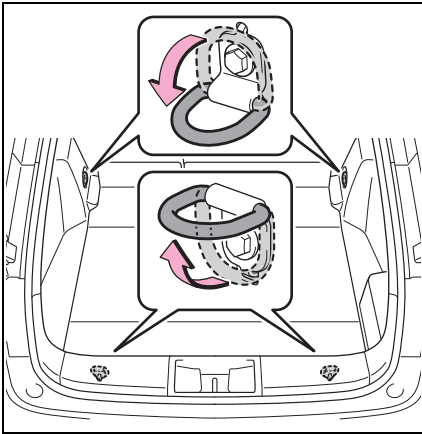

- ▶ Vehicles with emergency tire puncture repair kit (type B) or spare tire

- 1 To use the rear cargo hook, open the deck board.

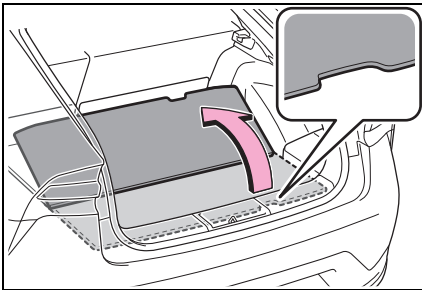

- 2 Raise the hook to use, return the deck board to its original position and close it.

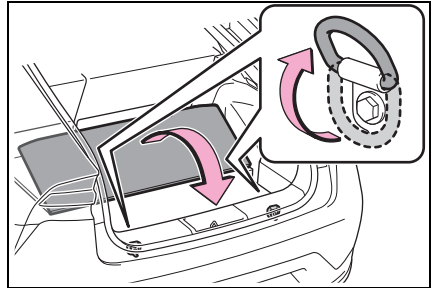

- 3 When using the front cargo hook, raise the hook without opening the deck board.

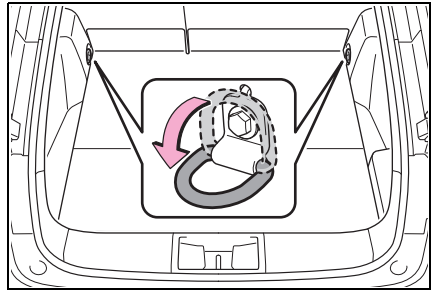

! WARNING

- **When the cargo hooks are not in use**

To avoid injury, always return the cargo hooks to their stowed positions.