

COMPONENTS

ILLUSTRATION

BACK DOOR TRIM BOARD ASSEMBLY

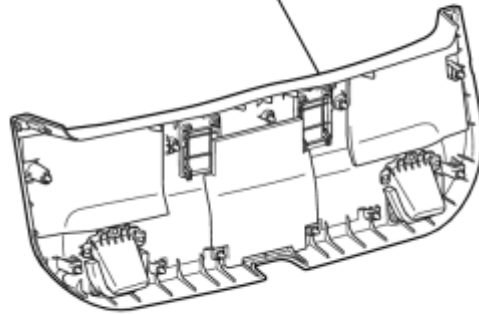

BACK DOOR OPENER SWITCH ASSEMBLY

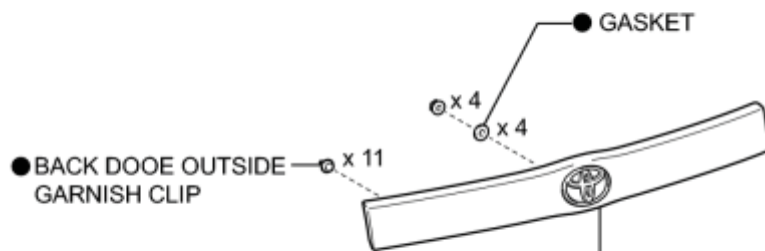

BACK DOOR OUTSIDE GARNISH SUB-ASSEMBLY

● Non-reusable part

P

REMOVAL

1. REMOVE BACK DOOR TRIM BOARD ASSEMBLY_ INFO

2. REMOVE BACK DOOR OUTSIDE GARNISH SUB-ASSEMBLY_ INFO

3. REMOVE BACK DOOR OPENER SWITCH ASSEMBLY

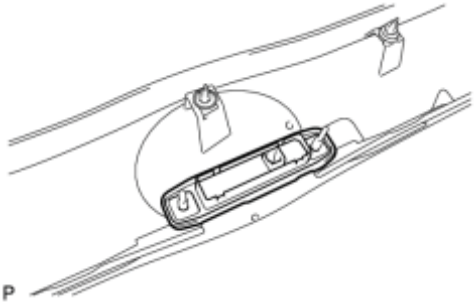

(a) Remove the back door opener switch assembly.

INSPECTION

1. INSPECT BACK DOOR OPENER SWITCH ASSEMBLY

(a) Check the operation of the opener switch.

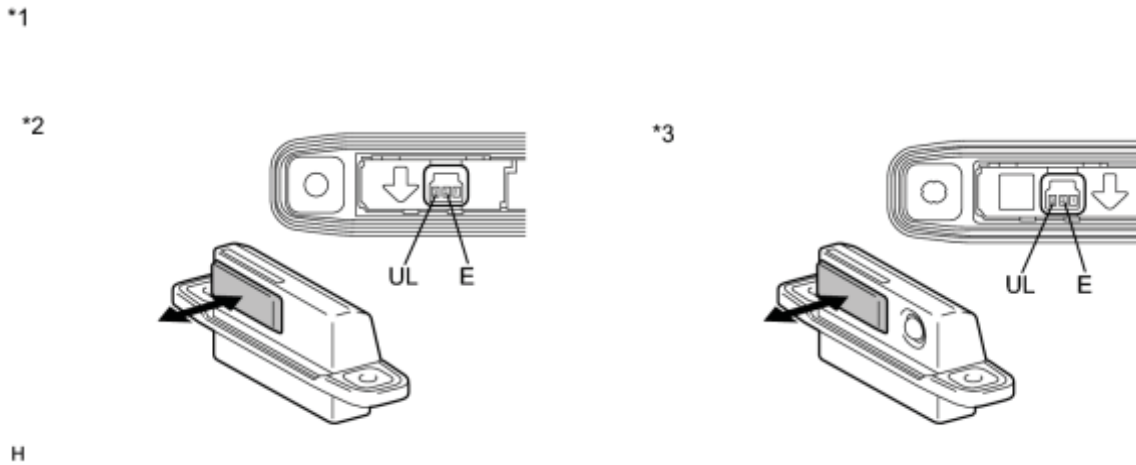

(1) Measure the resistance according to the value(s) in the table below.

Standard Resistance:

Tester Connection	Switch Condition	Specified Condition
2 (E) - 3 (UL)	Back door opener switch not pushed	10 k Ω or higher
2 (E) - 3 (UL)	Back door opener switch pushed	Below 1 Ω

Text in Illustration

*1	Component without harness connected (Back Door Opener Switch Assembly (Opener Switch))	*2	w/o Entry Back Door Open
*3	w/ Entry Back Door Open	-	-

If the result is not specified, replace the back door opener switch assembly.

(b) Check operation of the lock switch (w/ Entry Back Door Open).

(1) Measure the resistance according to the value(s) in the table below.

Standard Resistance:

Tester Connection	Switch Position	Specified Condition
1(L) - 2(E)	Back door lock switch not	10 k Ω or higher

*1

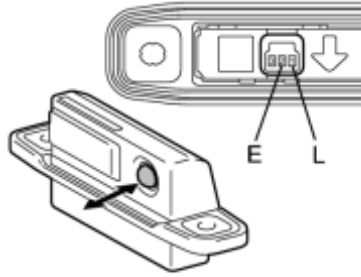

	pushed	
1(L) - 2(E)	Back door lock switch pushed	Below 1 Ω

Text in Illustration

*1	Component without harness connected (Back Door Opener Switch Assembly (Lock Switch))
----	---

H

If the result is not specified, replace the back door opener switch assembly.

INSTALLATION

1. INSTALL BACK DOOR OPENER SWITCH ASSEMBLY

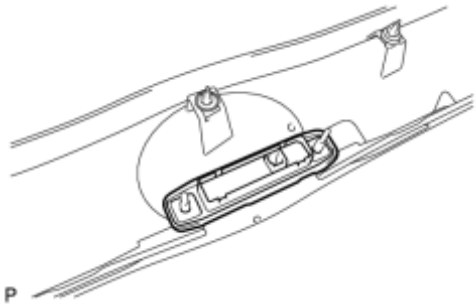

(a) Install the back door opener switch assembly.

2. INSTALL BACK DOOR OUTSIDE GARNISH SUB-ASSEMBLY_ [INFO](#)

3. INSTALL BACK DOOR TRIM BOARD ASSEMBLY_ [INFO](#)

COMPONENTS

ILLUSTRATION

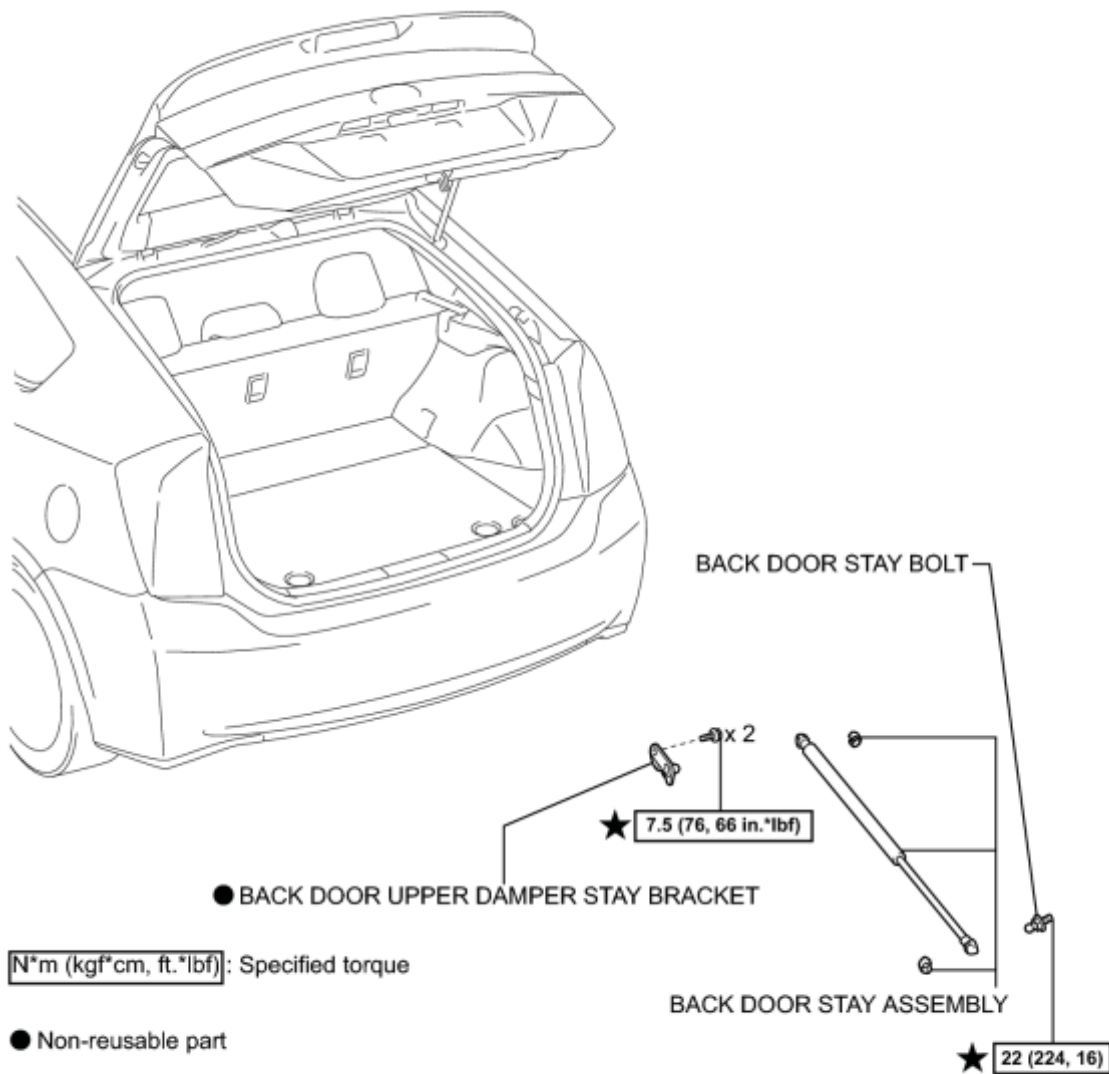

P

REMOVAL

1. REMOVE BACK DOOR STAY ASSEMBLY

NOTICE:

- Avoid touching the piston rod as much as possible to prevent foreign matter from attaching to it. Be sure to hold the cylinder while servicing.
- Do not wear cotton gloves or other similar materials when handling the piston rod. Fibers may attach to the rod and result in gas leaks.
- Do not apply any horizontal load to the door stay in order to prevent the piston rod from deforming.

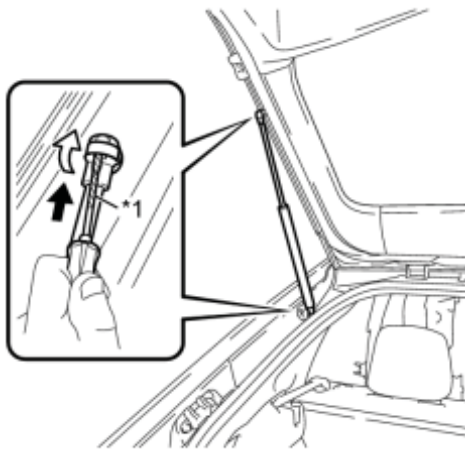

(a) Using a screwdriver, remove the stop ring along the groove.

HINT:

Tape the screwdriver tip before use.

Text in Illustration

*1	Protective Tape
----	-----------------

(b) Release the ball joint and remove the back door stay assembly.

NOTICE:

Remove the back door stay assembly while supporting the back door by hand.

2. REMOVE BACK DOOR STAY BOLT

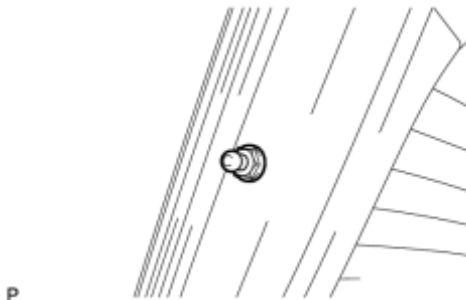

(a) Remove the back door stay bolt.

3. REMOVE BACK DOOR UPPER DAMPER STAY BRACKET

(a) Remove the 2 bolts and back door upper damper stay bracket.

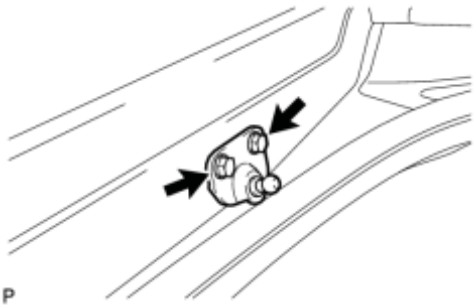

INSTALLATION

1. INSTALL BACK DOOR UPPER DAMPER STAY BRACKET

(a) Clean the threaded portion on the vehicle body with a non-residue solvent.

(b) Apply adhesive to the threads of the 2 bolts.

Adhesive:

Toyota Genuine Adhesive 1324, Three Bond 1324 or equivalent

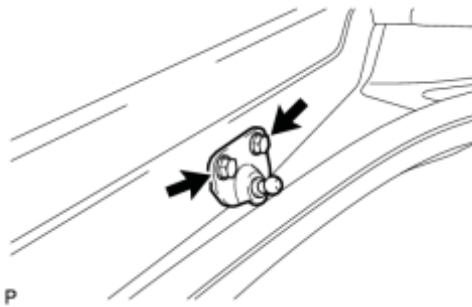

(c) Install a new back door upper damper stay bracket with the 2 bolts.

Torque: **7.5 N·m (76 kgf·cm, 66in·lbf)**

2. INSTALL BACK DOOR STAY BOLT

(a) Clean the threaded portion on the vehicle body with a non-residue solvent.

(b) Apply adhesive to the threads of the back door stay bolt.

Adhesive:

Toyota Genuine Adhesive 1324, Three Bond 1324 or equivalent

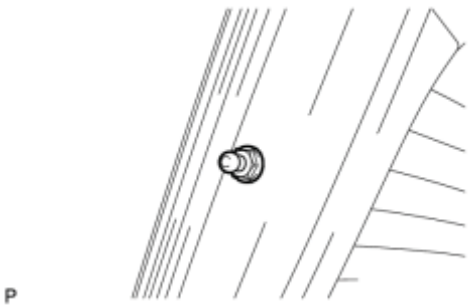

(c) Install the back door stay bolt.

Torque: **22 N·m (224 kgf·cm, 16ft·lbf)**

3. INSTALL BACK DOOR STAY ASSEMBLY

NOTICE:

- Avoid touching the piston rod as much as possible to prevent foreign matter from attaching to it. Be sure to hold the cylinder while servicing.

- Do not wear cotton gloves or other similar materials when handling the piston rod. Fibers may attach to the rod and result in gas leaks.
- Do not apply any horizontal load to the door stay in order to prevent the rod from deforming.

(a) When reusing the back door stay assembly:

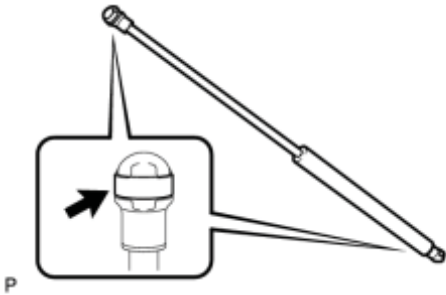

(1) Install the 2 stop rings to the back door stay assembly.

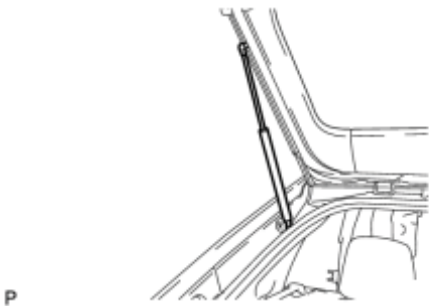

(b) Install the back door stay assembly.

NOTICE:

Install the back door stay assembly while supporting the back door by hand.

(c) Check that the back door stay assembly is engaged in the ball joint and that the back door stay assembly cannot be pulled out.

DISPOSAL

1. DISPOSE OF BACK DOOR STAY ASSEMBLY

(a) Secure the back door stay assembly horizontally in a vise with the piston rod pulled out.

(b) Wear safety glasses. Use a metal saw to slowly cut a groove between A and B shown in the illustration to release the gas.

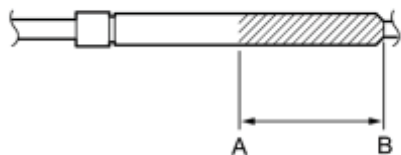

Area	Measurement
A-B	50 mm (1.97 in.)

NOTICE:

Although the gas inside the back door stay assembly is colorless, odorless and harmless, metal debris may scatter. Therefore, cover the back door stay assembly with a piece of cloth or other material.

P

COMPONENTS

ILLUSTRATION

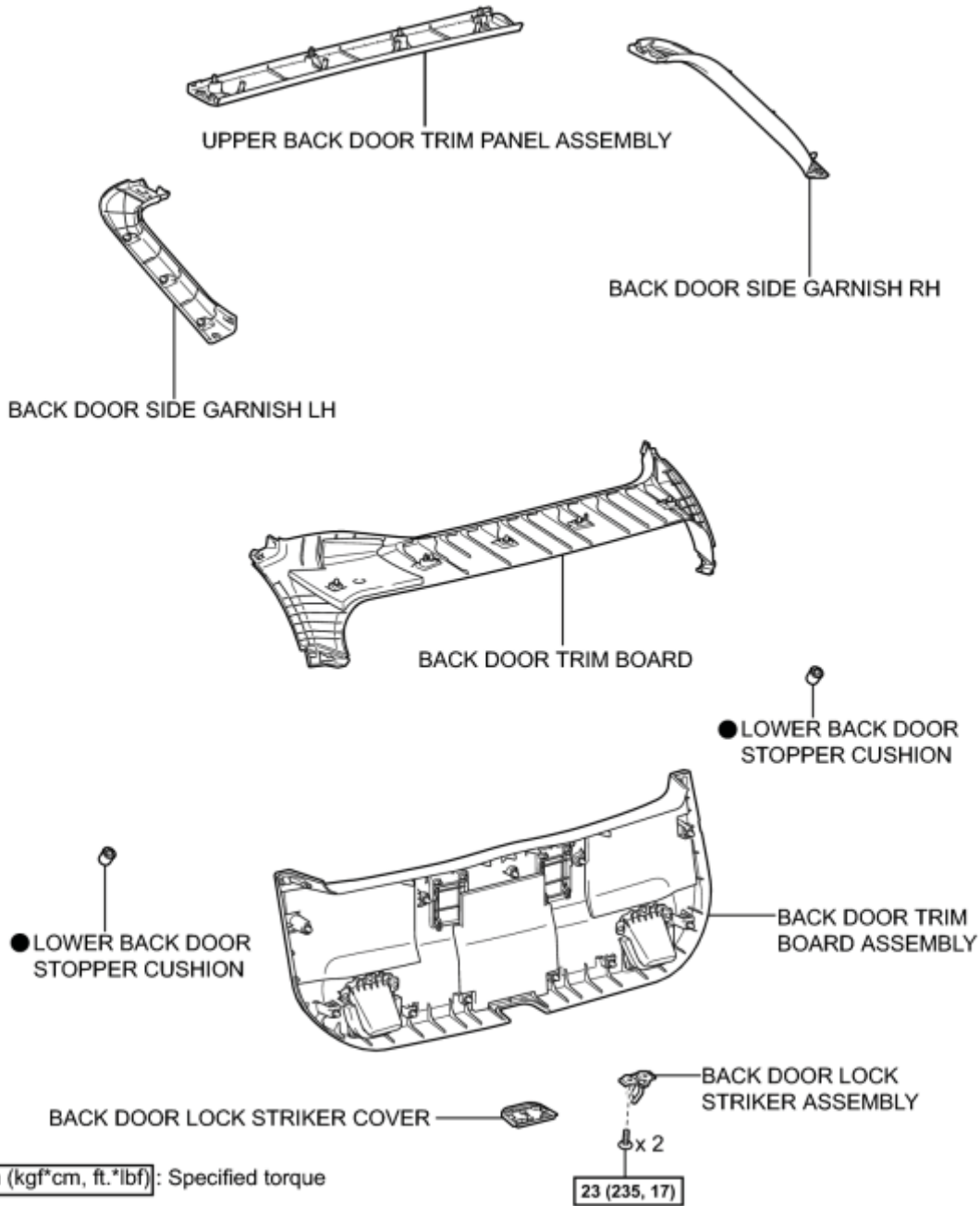

● Non-reusable part

P

ILLUSTRATION

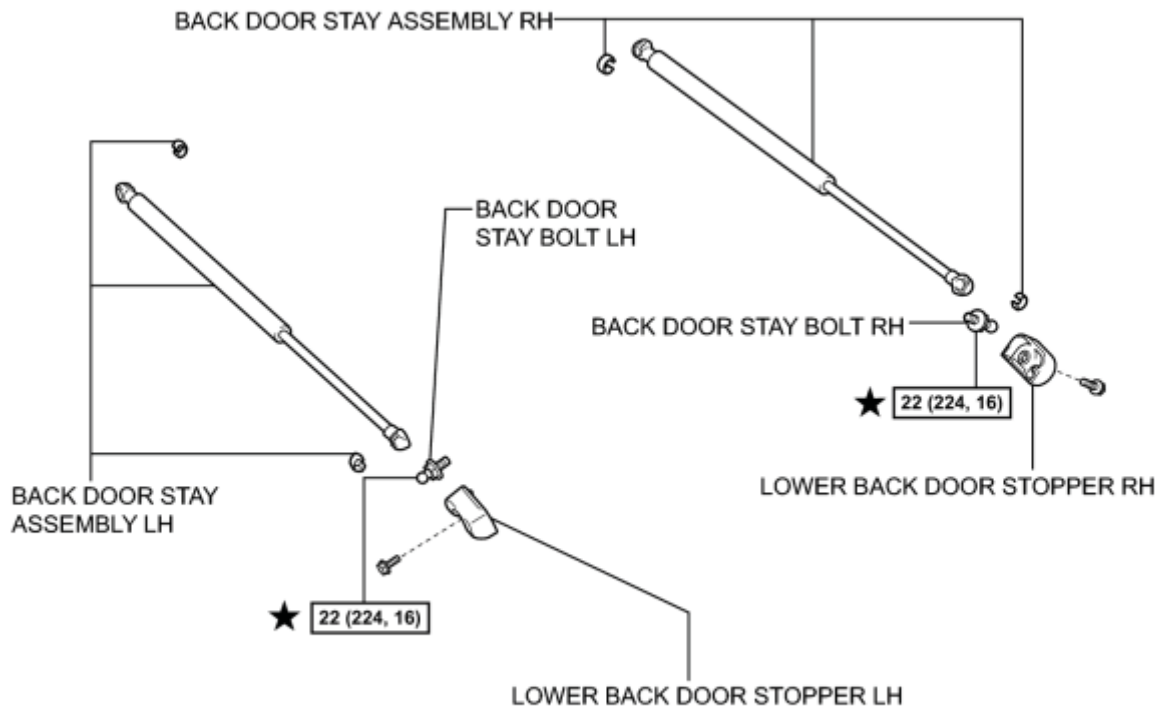

N*m (kgf*cm, ft.*lbf): Specified torque

★ Precoated part

P

ILLUSTRATION

w/ Rear Wiper:

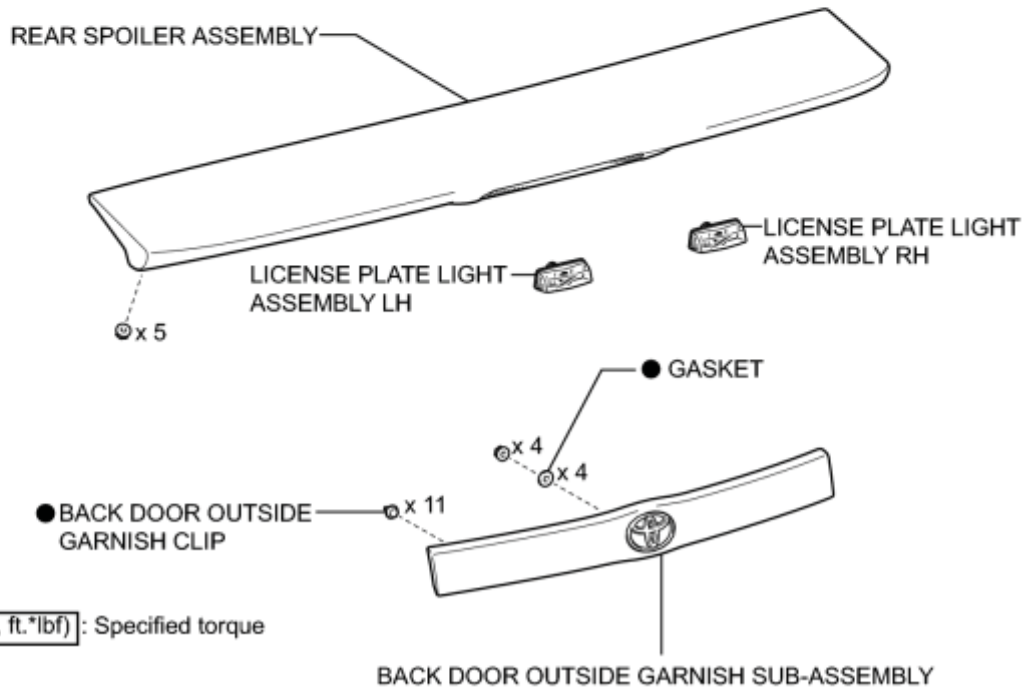
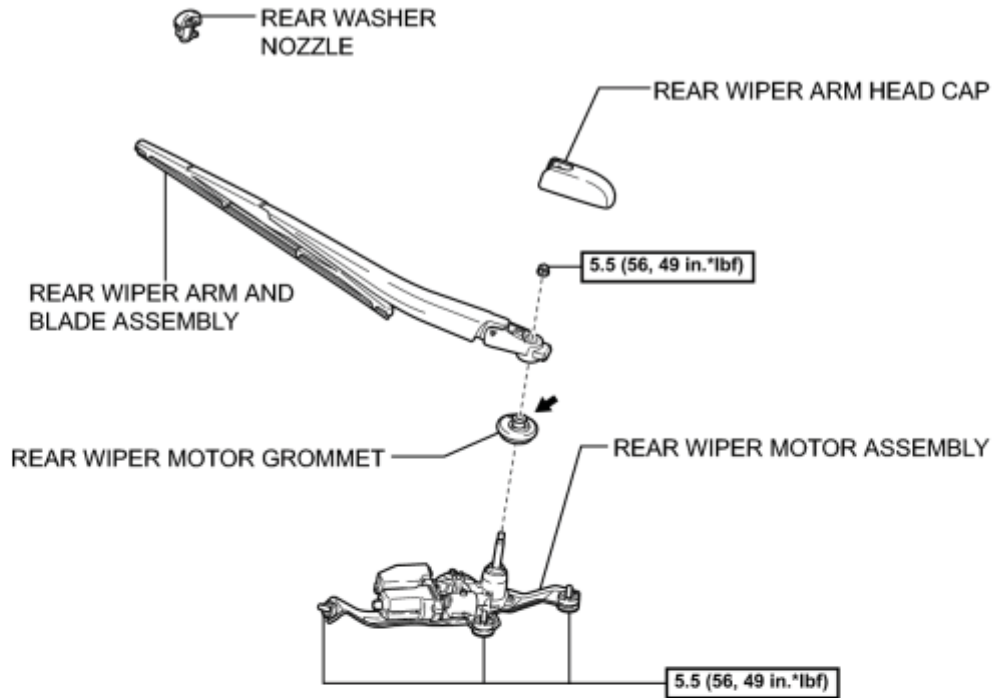

[N*m (kgf*cm, ft.*lbf)] : Specified torque

● Non-reusable part

← MP grease

P

ILLUSTRATION

w/ Rear Monitor:



REAR TELEVISION CAMERA ASSEMBLY

$\boxed{\text{N}^*\text{m (kgf}^*\text{cm, ft.}^*\text{lb)}}\text{: Specified torque}$

● Non-reusable part

P

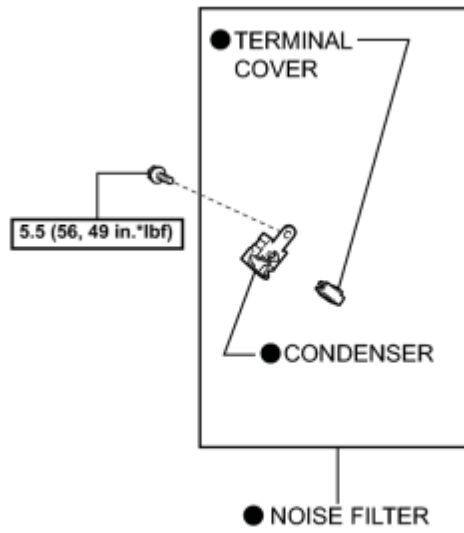

DISASSEMBLY

1. REMOVE UPPER BACK DOOR TRIM PANEL ASSEMBLY

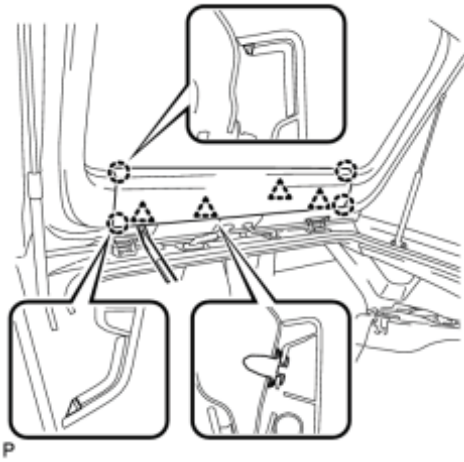

(a) Using a moulding remover, disengage the 4 clips and 4 claws, and remove the upper back door trim panel assembly.

2. REMOVE BACK DOOR SIDE GARNISH RH

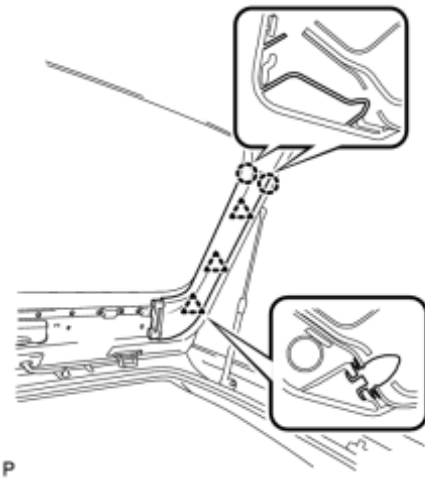

(a) Disengage the 3 clips and 2 claws, and remove the back door side garnish RH.

3. REMOVE BACK DOOR SIDE GARNISH LH

(a) Disengage the 3 clips and 2 claws, and remove the back door side garnish LH.

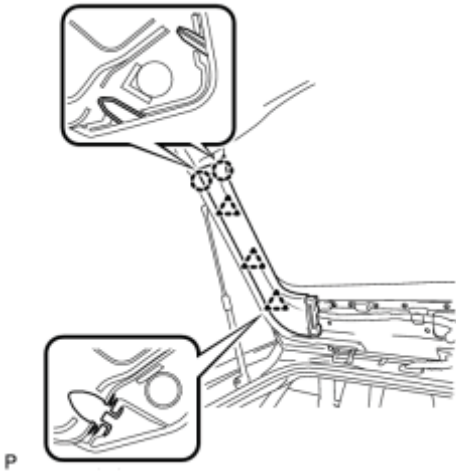

4. REMOVE BACK DOOR TRIM BOARD ASSEMBLY

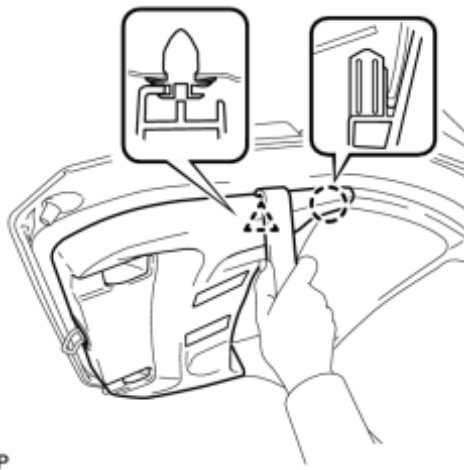

(a) Using a moulding remover, disengage the clip and claw.

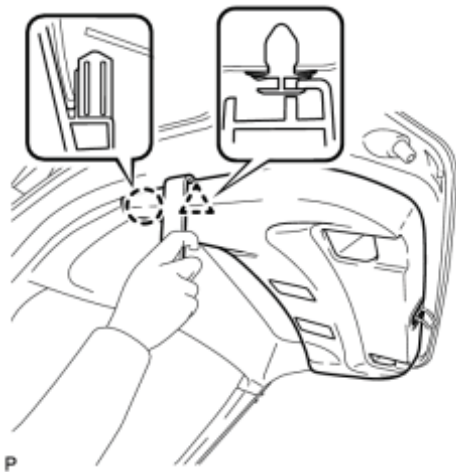

(b) Using a moulding remover, disengage the clip and claw.

(c) Disengage the 9 clips and remove the back door trim board assembly as shown in the illustration.

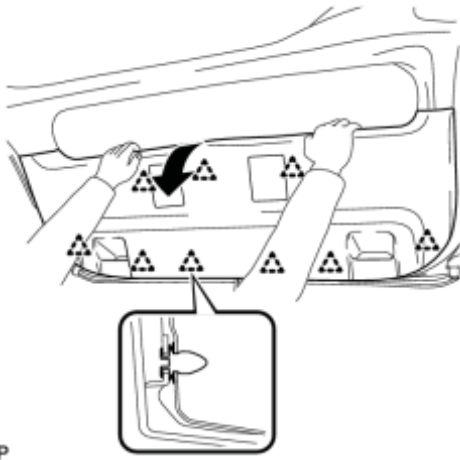

5. REMOVE BACK DOOR TRIM BOARD

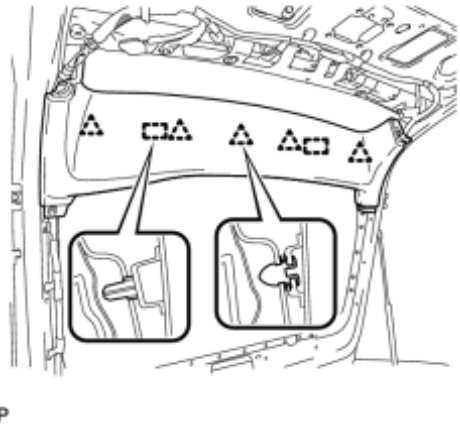

(a) Disengage the 5 clips and 2 guides, and remove the back door trim board.

6. REMOVE BACK DOOR LOCK STRIKER COVER

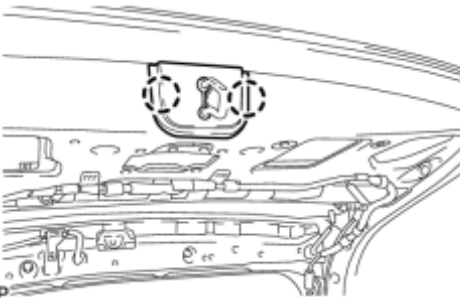

(a) Disengage the 2 claws and remove the back door lock striker cover.

7. REMOVE LOWER BACK DOOR STOPPER CUSHION

(a) Disengage the claws to remove the 2 lower back door stopper cushions.

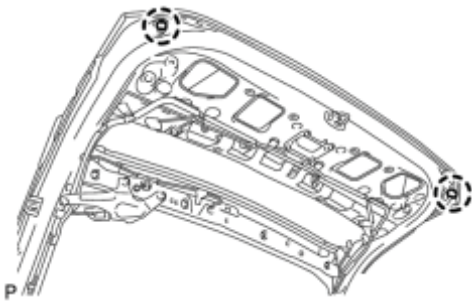

8. REMOVE BACK DOOR LOCK STRIKER ASSEMBLY

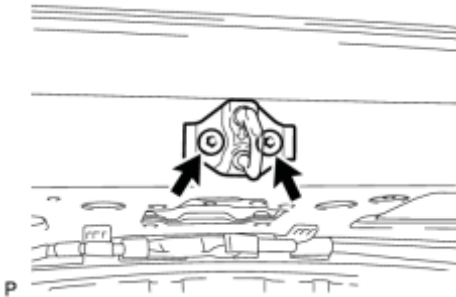

(a) Using a T40 "TORX" socket wrench, remove the 2 screws and back door lock striker assembly.

9. REMOVE LOWER BACK DOOR STOPPER LH

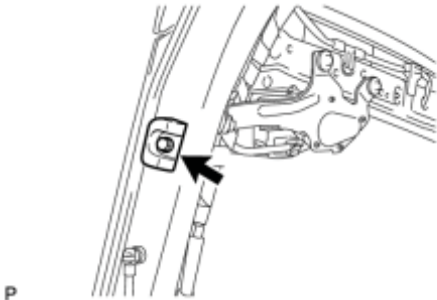

(a) Remove the bolt and lower back door stopper LH.

10. REMOVE LOWER BACK DOOR STOPPER RH

HINT:

Use the same procedure for the RH side and LH side.

11. REMOVE BACK DOOR STAY ASSEMBLY LH_ INFO

12. REMOVE BACK DOOR STAY ASSEMBLY RH

HINT:

Use the same procedure for the RH side and LH side.

13. REMOVE BACK DOOR STAY BOLT LH_ INFO

14. REMOVE BACK DOOR STAY BOLT RH

HINT:

Use the same procedure for the RH side and LH side.

15. REMOVE BACK DOOR OUTSIDE GARNISH SUB-ASSEMBLY_ INFO

16. REMOVE LICENSE PLATE LIGHT ASSEMBLY LH_ INFO

17. REMOVE LICENSE PLATE LIGHT ASSEMBLY RH

HINT:

Use the same procedure for the RH side and LH side.

18. REMOVE REAR SPOILER ASSEMBLY_ INFO

19. REMOVE REAR WASHER NOZZLE (w/ Rear Wiper)_ INFO

20. REMOVE REAR WIPER ARM HEAD CAP (w/ Rear Wiper)_ INFO

21. REMOVE REAR WIPER ARM AND BLADE ASSEMBLY (w/ Rear Wiper)_ INFO

22. REMOVE REAR WIPER MOTOR GROMMET (w/ Rear Wiper)_ INFO

23. REMOVE REAR WIPER MOTOR ASSEMBLY (w/ Rear Wiper)_ INFO

24. REMOVE REAR TELEVISION CAMERA ASSEMBLY (w/ Rear Monitor)_ INFO

25. REMOVE NOISE FILTER_ INFO

ADJUSTMENT

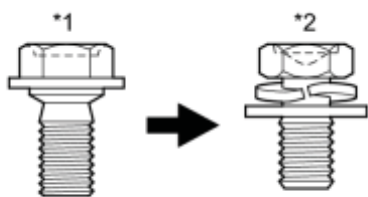

P

Text in Illustration

*1	Centering Bolt
*2	Standard Bolt

HINT:

- Use the same procedure for the RH side and LH side.
- The following procedure is for the LH side.
- Centering bolts are used to mount the door hinge to the vehicle body and door. The door cannot be adjusted with the centering bolts installed. Substitute the centering bolts with standard bolts (with washers) when making adjustments.
- Specified torque for standard bolts is shown in the standard bolt chart [NFC](#).

1. INSPECT BACK DOOR

(a) Check that the clearance measurements of areas *1 through *13 are within each standard range.

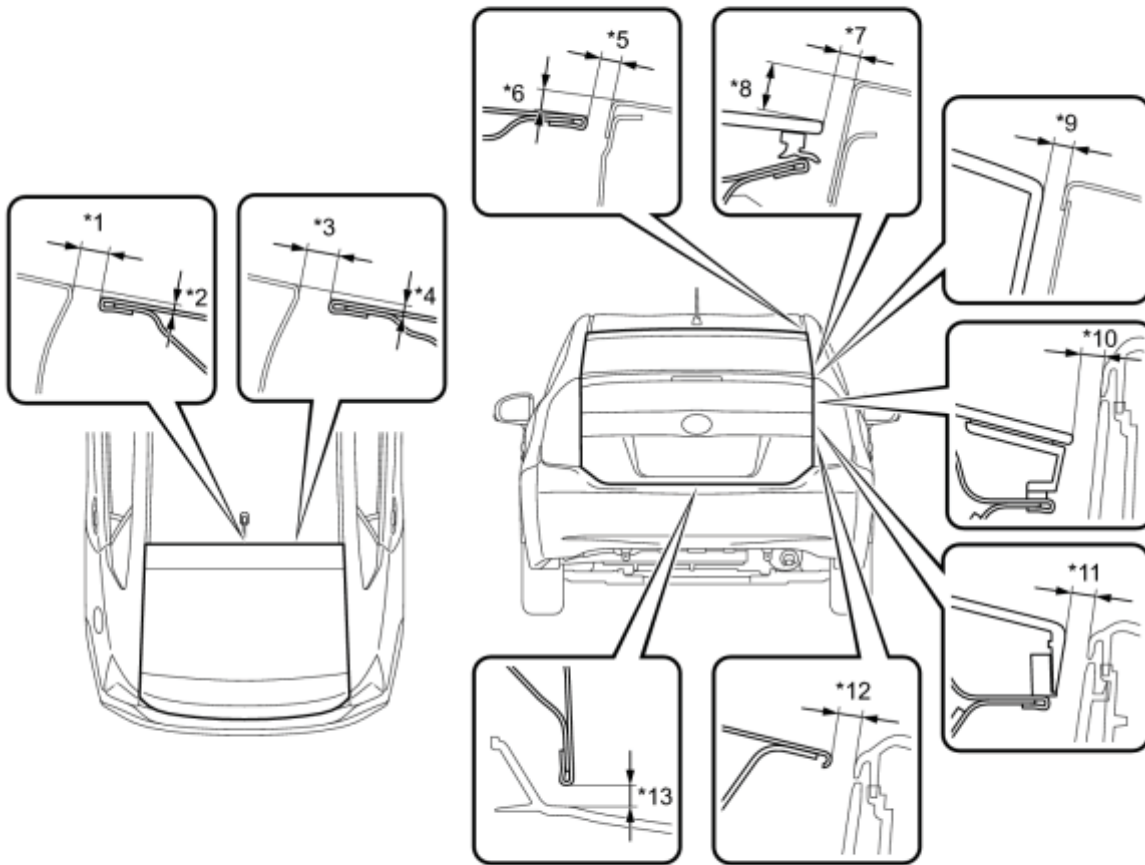

P

Standard Clearance

Area	Measurement	Area	Measurement
*1	5.7 to 8.7 mm (0.224 to 0.343 in.)	*2	0 to 3.0 mm (0 to 0.118 in.)
*3	5.7 to 8.7 mm (0.224 to 0.343 in.)	*4	0 to 3.0 mm (0 to 0.118 in.)
*5	3.2 to 6.2 mm (0.126 to 0.244 in.)	*6	3.6 to 6.6 mm (0.142 to 0.260 in.)
*7	2.85 to 6.85 mm (0.112 to 0.270 in.)	*8	9.65 to 13.65 mm (0.380 to 0.537 in.)
*9	2.85 to 6.85 mm (0.112 to 0.270 in.)	*10	4.0 to 8.0 mm (0.157 to 0.315 in.)
*11	4.5 to 8.5 mm (0.177 to 0.335 in.)	*12	3.85 to 7.85 mm (0.152 to 0.309 in.)
*13	4.35 to 7.35 mm (0.171 to 0.289 in.)	-	-

2. REMOVE REAR NO. 2 FLOOR BOARD (for Separate Type) [INFC](#)

3. REMOVE REAR DECK FLOOR BOX [INFC](#)

4. REMOVE DECK TRIM SERVICE HOLE COVER_ INFO

5. REMOVE REAR DECK TRIM COVER_ INFO

6. ADJUST BACK DOOR

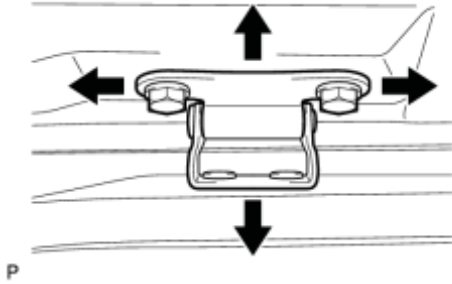

(a) Before adjusting the upper end of the back door up and down or left and right, loosen the bolts.

(b) Tighten the body side hinge after the adjustment.

Torque: **19 N·m (194 kgf·cm, 14ft·lbf)**

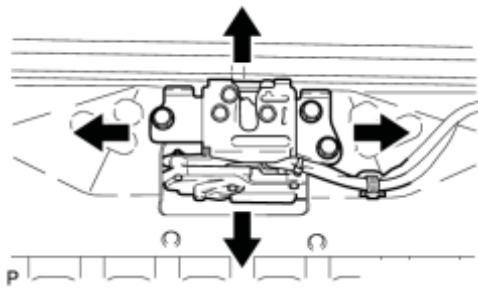

(c) Loosen the 3 bolts.

(d) Tighten the bolts after the adjustment.

Torque: **7.5 N·m (77 kgf·cm, 66in·lbf)**

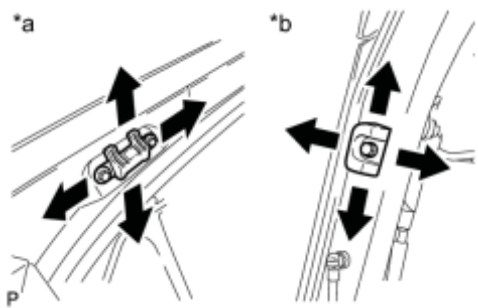

(e) After adjusting the back door position, adjust the positions of the lower back door stopper and lower back door stopper cushion.

Text in Illustration

*a	Vehicle Body Side
*b	Door Side

7. INSTALL REAR DECK TRIM COVER_ INFO

8. INSTALL DECK TRIM SERVICE HOLE COVER_ [INFO](#)

9. INSTALL REAR DECK FLOOR BOX_ [INFO](#)

10. INSTALL REAR NO. 2 FLOOR BOARD (for Separate Type)_ [INFO](#)

REASSEMBLY

1. INSTALL NOISE FILTER_ INFO
2. INSTALL REAR TELEVISION CAMERA ASSEMBLY (w/ Rear Monitor)_ INFO
3. INSTALL REAR WIPER MOTOR ASSEMBLY (w/ Rear Wiper)_ INFO
4. INSTALL REAR WIPER MOTOR GROMMET (w/ Rear Wiper)_ INFO
5. INSTALL REAR WIPER ARM AND BLADE ASSEMBLY (w/ Rear Wiper)_ INFO
6. INSTALL REAR WIPER ARM HEAD CAP (w/ Rear Wiper)_ INFO
7. INSTALL REAR WASHER NOZZLE (w/ Rear Wiper)_ INFO
8. INSPECT REAR WASHER NOZZLE (w/ Rear Wiper)_ INFO
9. ADJUST REAR WASHER NOZZLE (w/ Rear Wiper)_ INFO
10. INSTALL REAR SPOILER ASSEMBLY_ INFO
11. INSTALL LICENSE PLATE LIGHT ASSEMBLY LH_ INFO
12. INSTALL LICENSE PLATE LIGHT ASSEMBLY RH

HINT:

Use the same procedure for the RH side and LH side.

13. INSTALL BACK DOOR OUTSIDE GARNISH SUB-ASSEMBLY_ INFO
14. INSTALL BACK DOOR STAY BOLT LH_ INFO
15. INSTALL BACK DOOR STAY BOLT RH

HINT:

Use the same procedure for the RH side and LH side.

16. INSTALL BACK DOOR STAY ASSEMBLY LH_ INFO
17. INSTALL BACK DOOR STAY ASSEMBLY RH

HINT:

Use the same procedure for the RH side and LH side.

18. INSTALL LOWER BACK DOOR STOPPER LH

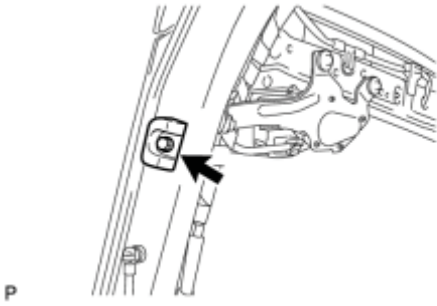

(a) Install the lower back door stopper LH with the bolt.

19. INSTALL LOWER BACK DOOR STOPPER RH

HINT:

Use the same procedure for the RH side and LH side.

20. INSTALL BACK DOOR LOCK STRIKER ASSEMBLY

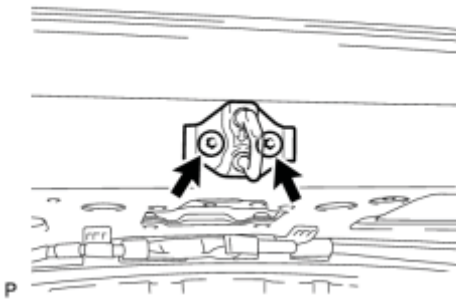

(a) Using a T40 "TORX" socket wrench, install the back door lock striker assembly with the 2 screws.

Torque: **23 N·m (235 kgf·cm, 17ft·lbf)**

21. INSTALL LOWER BACK DOOR STOPPER CUSHION

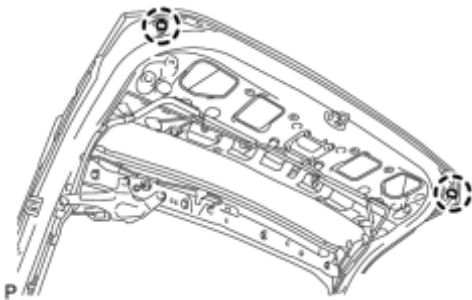

(a) Engage the claws to install the 2 new lower back door stopper cushions.

22. INSTALL BACK DOOR LOCK STRIKER COVER

(a) Engage the 2 claws to install the back door lock striker cover.

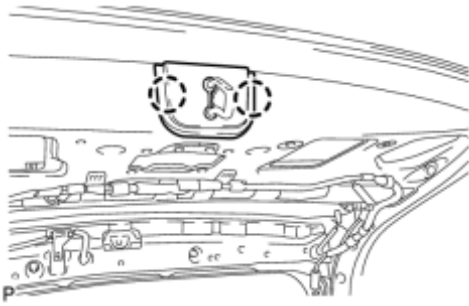

23. INSTALL BACK DOOR TRIM BOARD



(a) Engage the 5 clips and 2 guides to install the back door trim board.

P

24. INSTALL BACK DOOR TRIM BOARD ASSEMBLY

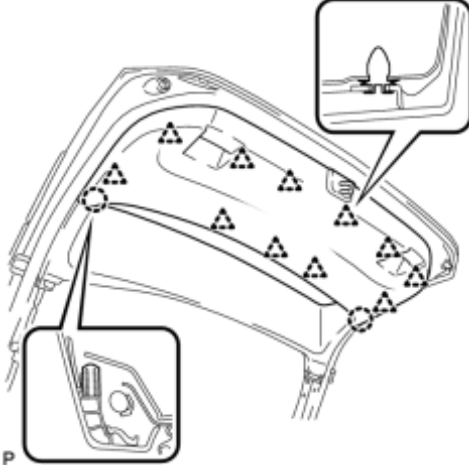

(a) Engage the 11 clips and 2 claws to install the back door panel trim assembly.

P

25. INSTALL BACK DOOR SIDE GARNISH LH

(a) Engage the 3 clips and 2 claws to install the back door side garnish LH.

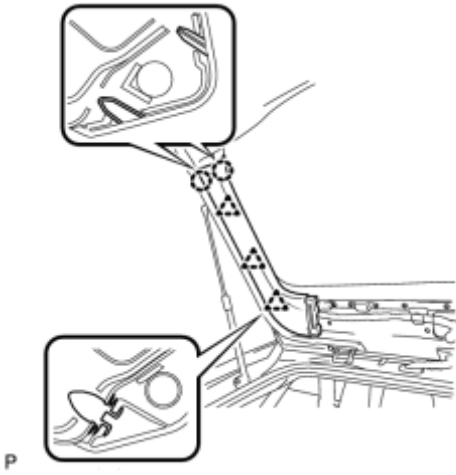

26. INSTALL BACK DOOR SIDE GARNISH RH

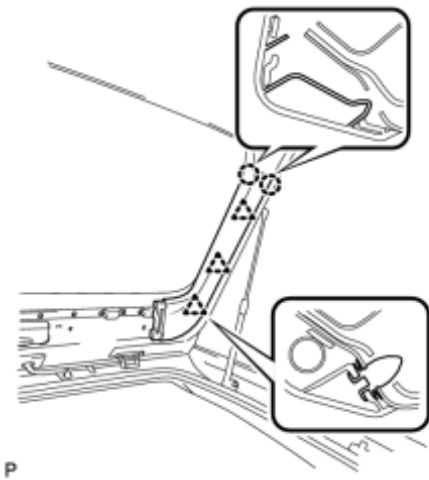

(a) Engage the 3 clips and 2 claws to install the back door side garnish RH.

27. INSTALL UPPER BACK DOOR TRIM PANEL ASSEMBLY

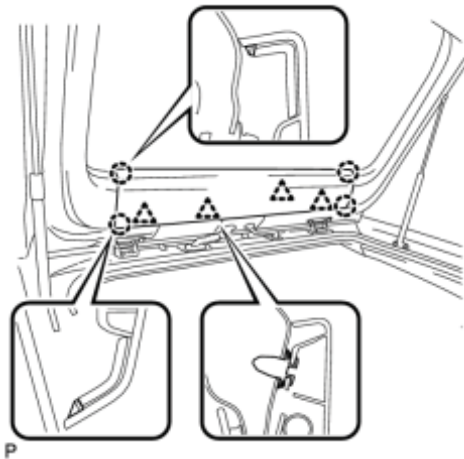

(a) Engage the 4 clips and 4 claws to install the upper back door trim panel assembly.

28. ADJUST REAR TELEVISION CAMERA OPTICAL AXIS (CAMERA POSITION SETTINGS (w/ Advanced Parking Guidance System))

INFO