

FRONT SUSPENSION LOWER NO. 1 ARM

COMPONENTS

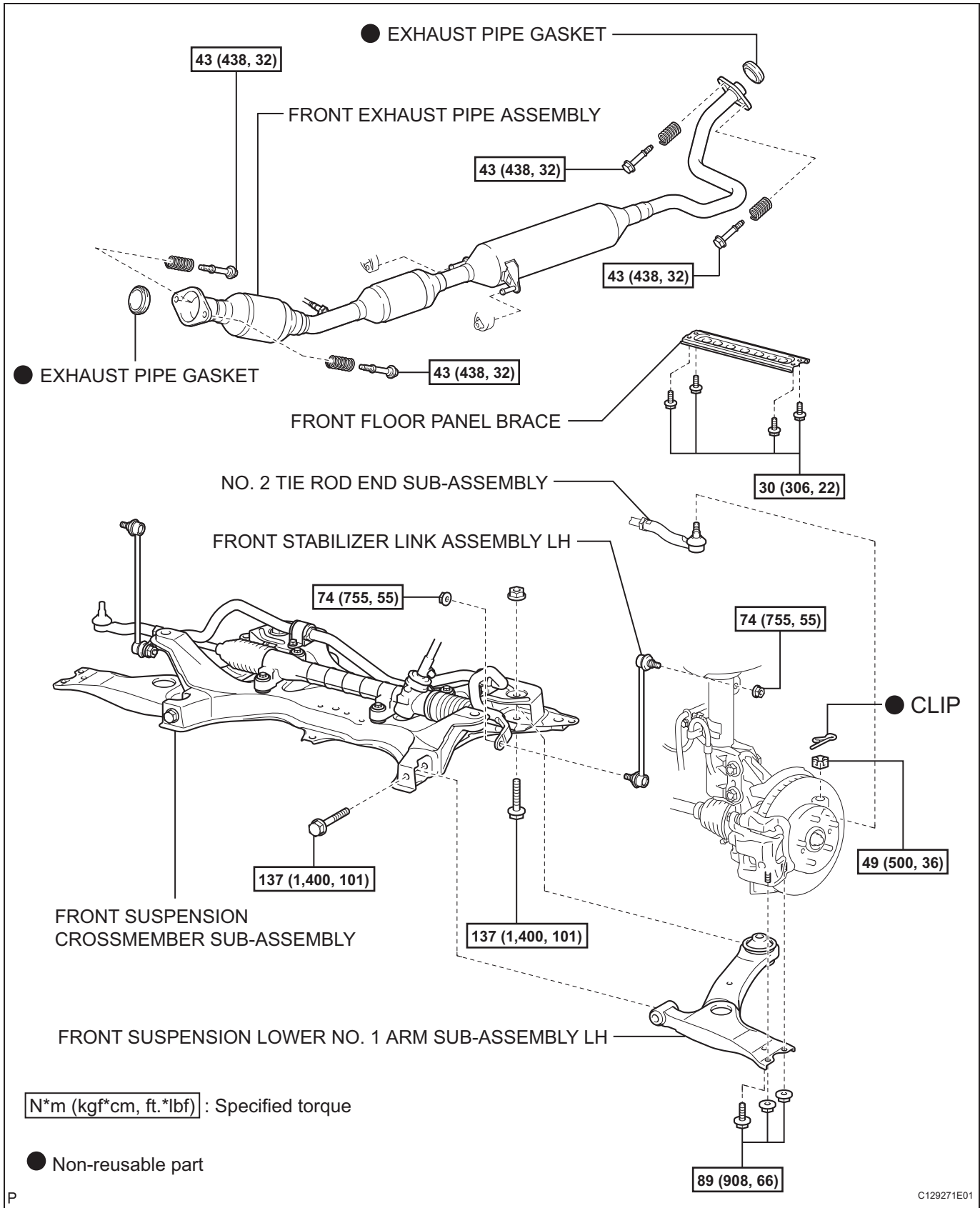

REMOVAL

HINT:

- Use the same procedures for the RH side and LH side.
- The procedures listed below are for the LH side.

1. **PLACE FRONT WHEELS FACING STRAIGHT AHEAD**
2. **REMOVE COLUMN HOLE COVER SILENCER SHEET**
(See page [SR-10](#))
3. **DISCONNECT STEERING SLIDING YOKE SUB-ASSEMBLY** (See page [PS-50](#))
4. **REMOVE FRONT WHEEL**
5. **REMOVE FRONT EXHAUST PIPE ASSEMBLY** (See page [EX-2](#))
6. **REMOVE FRONT AXLE HUB NUT LH** (See page [DS-5](#))

7. **REMOVE FRONT AXLE HUB NUT RH**

HINT:

Use the same procedures described for the LH side.

8. **DISCONNECT NO. 2 TIE ROD END SUB-ASSEMBLY**
(See page [DS-6](#))
9. **DISCONNECT NO. 1 TIE ROD END SUB-ASSEMBLY**
(See page [PS-50](#))
10. **DISCONNECT FRONT SUSPENSION LOWER NO. 1 ARM SUB-ASSEMBLY LH**
 - (a) Remove the bolt and 2 nuts.
 - (b) Lower the front suspension lower No. 1 arm and disconnect it from the front lower ball joint.

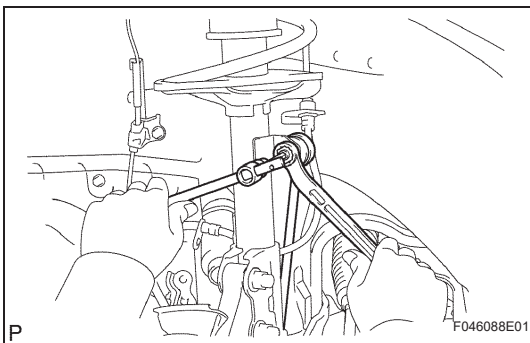
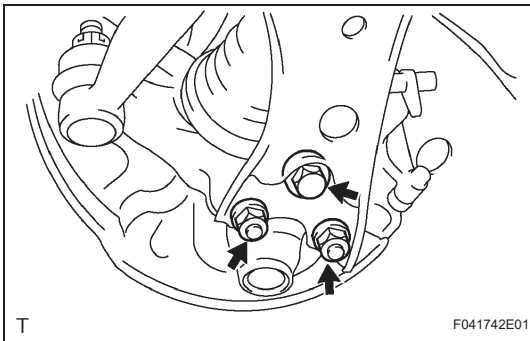

11. **REMOVE FRONT STABILIZER LINK ASSEMBLY**
 - (a) Remove the nuts and disconnect the stabilizer link LH and RH from the front shock absorber with coil spring.

HINT:

Use a 6 mm hexagon wrench to hold the stud if the ball joint turns together with the nut.

12. **DISCONNECT FRONT SUSPENSION LOWER NO. 1 ARM SUB-ASSEMBLY RH**

HINT:

Remove the RH side following the same procedures as the LH side.

13. **REMOVE FRONT AXLE ASSEMBLY LH** (See page [AH-6](#))

14. REMOVE FRONT AXLE ASSEMBLY RH

HINT:

Remove the RH side following the same procedures as the LH side.

15. REMOVE FRONT DRIVE SHAFT ASSEMBLY LH (See page DS-7)**16. REMOVE FRONT DRIVE SHAFT ASSEMBLY RH (See page DS-7)****17. DISCONNECT FRONT SUSPENSION CROSSMEMBER SUB-ASSEMBLY****18. REMOVE FRONT SUSPENSION LOWER NO. 1 ARM SUB-ASSEMBLY LH**

- (a) Remove the 2 bolts, nut and front suspension lower No. 1 arm.

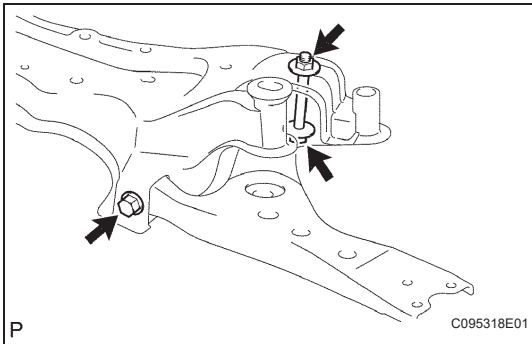
NOTICE:**Keep the nut from rotating and loosen the bolt.**

INSTALLATION

HINT:

- Use the same procedures for the RH side and LH side.
- The procedures listed below are for the LH side.

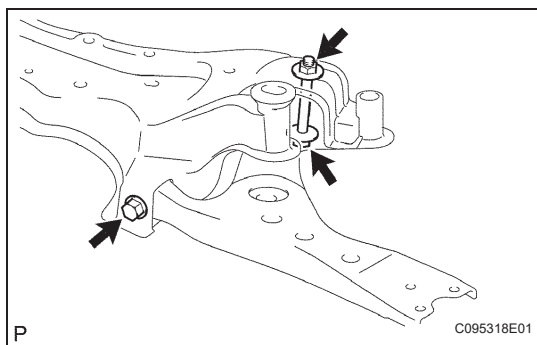

1. TEMPORARILY TIGHTEN FRONT SUSPENSION LOWER NO. 1 ARM SUB-ASSEMBLY LH

- (a) Install the front suspension lower No. 1 arm to the suspension crossmember and temporarily tighten the front suspension lower No. 1 arm with the 2 bolts and nut.

2. CONNECT FRONT SUSPENSION CROSSMEMBER SUB-ASSEMBLY

3. INSTALL FRONT DRIVE SHAFT ASSEMBLY LH (See page DS-15)

4. INSTALL FRONT DRIVE SHAFT ASSEMBLY RH (See page DS-15)

5. INSTALL FRONT AXLE ASSEMBLY LH (See page AH-6)

6. INSTALL FRONT AXLE ASSEMBLY RH

HINT:

Install the RH side following the same procedures as the LH side.

7. INSTALL FRONT SUSPENSION LOWER NO. 1 ARM SUB-ASSEMBLY LH

- (a) Install the front suspension lower No. 1 arm to the front lower ball joint with the bolt and 2 nuts.
Torque: 89 N*m (908 kgf*cm, 66 ft.*lbf)

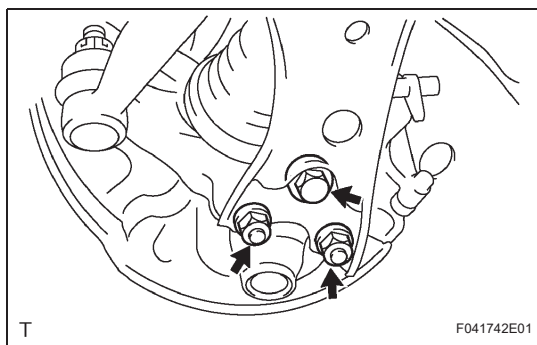

8. INSTALL FRONT SUSPENSION LOWER NO. 1 ARM SUB-ASSEMBLY RH

HINT:

Install the RH side following the same procedures as the LH side.

9. INSTALL FRONT STABILIZER LINK ASSEMBLY

- (a) Connect the front stabilizer link LH and RH to the front shock absorber with coil spring with the nuts.
Torque: 74 N*m (755 kgf*cm, 55 ft.*lbf)

HINT:

Use a 6 mm hexagon wrench to hold the stud if the ball joint turns together with the nut.

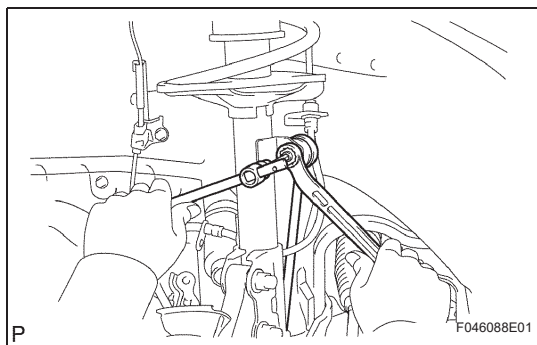

10. INSTALL NO. 2 TIE ROD END SUB-ASSEMBLY (See page PS-55)

11. INSTALL NO. 1 TIE ROD END SUB-ASSEMBLY (See page PS-50)

12. INSTALL FRONT AXLE HUB NUT LH (See page AH-7)

13. INSTALL FRONT AXLE HUB NUT RH

HINT:

Install the RH side following the same procedures as the LH side.

14. INSTALL FRONT WHEEL

Torque: 103 N*m (1,050 kgf*cm, 76 ft.*lbf)

15. INSTALL FRONT EXHAUST PIPE ASSEMBLY (See page EX-3)**16. STABILIZE SUSPENSION**

- (a) Lower the vehicle and bounce it up and down several times to stabilize the front suspension.

17. CONNECT STEERING SLIDING YOKE SUB-ASSEMBLY (See page PS-56)**18. INSTALL COLUMN HOLE COVER SILENCER SHEET****19. FULLY TIGHTEN FRONT SUSPENSION LOWER NO. 1 ARM SUB-ASSEMBLY LH**

- (a) Fully tighten the 2 bolts.

Torque: 137 N*m (1,400 kgf*cm, 101 ft.*lbf)

NOTICE:

- Keep the nut from rotating while tightening the rear-side bolt.
- Lower the tires to the ground using a 4-post lift.

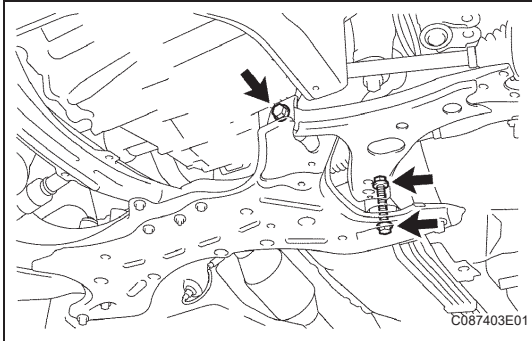
**20. INSPECT AND ADJUST FRONT WHEEL ALIGNMENT**

- (a) Inspect and adjust the front wheel alignment (see page SP-2).

FRONT LOWER BALL JOINT

COMPONENTS

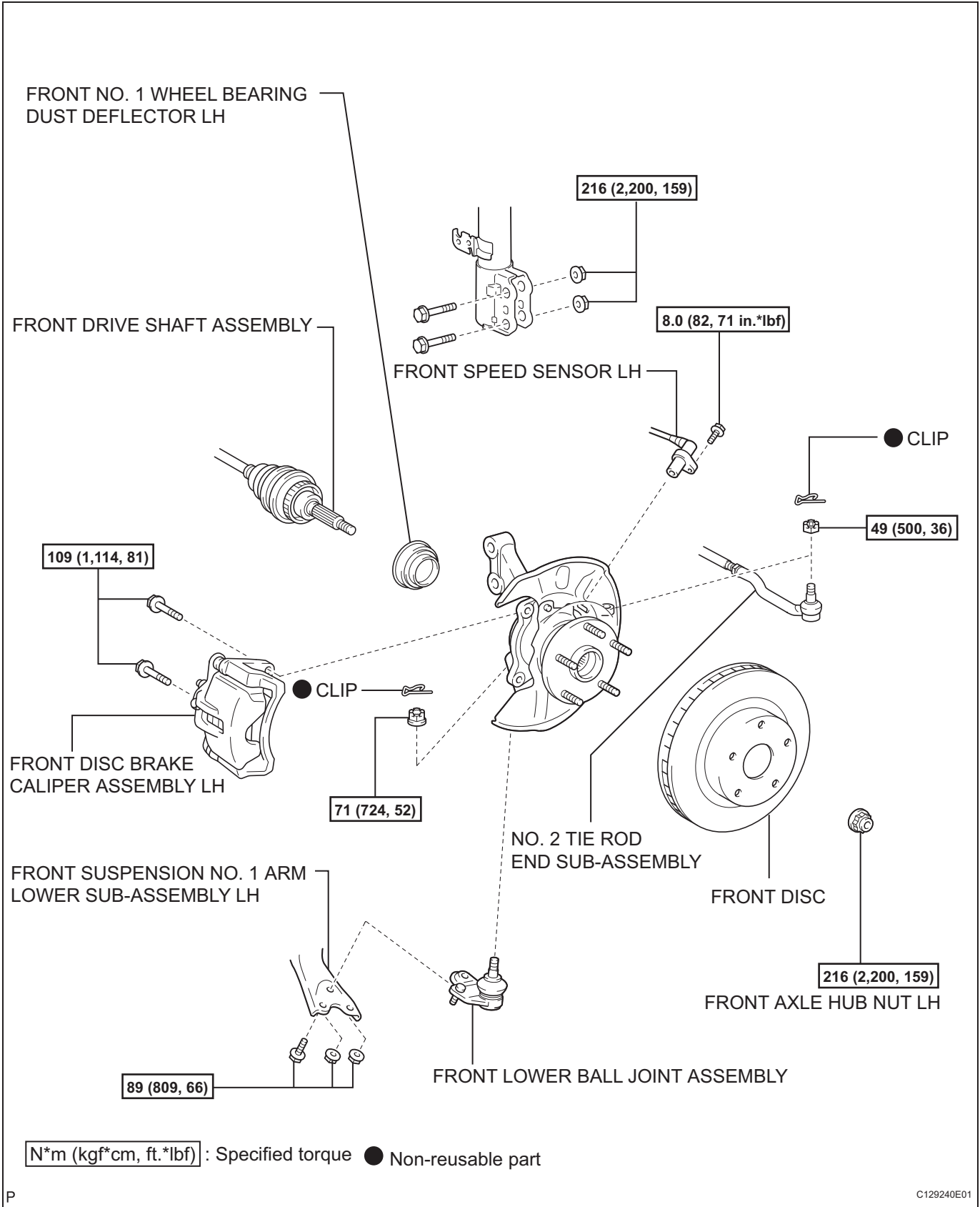

SP

REMOVAL

HINT:

- Use the same procedures for the RH side and LH side.
- The procedures listed below are for the LH side.

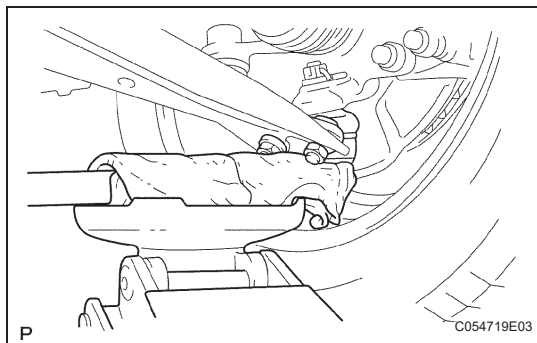

1. INSPECT FRONT LOWER BALL JOINT ASSEMBLY LH

- Jack up the front part of the vehicle.
- Move the front suspension lower No. 1 arm up and down to check vertical looseness of the lower ball joint front.

HINT:

Wrap a cloth around the wooden block to prevent damage to the bolt and nuts.

2. REMOVE FRONT WHEEL

3. REMOVE FRONT AXLE HUB NUT LH (See page DS-5)

4. DISCONNECT FRONT SPEED SENSOR LH (See page BC-218)

5. DISCONNECT FRONT DISC BRAKE CALIPER ASSEMBLY LH (See page BR-40)

6. REMOVE FRONT DISC (See page BR-42)

7. DISCONNECT NO. 2 TIE ROD END SUB-ASSEMBLY (See page DS-6)

8. DISCONNECT FRONT SUSPENSION LOWER NO. 1 ARM SUB-ASSEMBLY LH

- Remove the bolt and 2 nuts.
- Lower the front suspension lower No. 1 arm and disconnect it from the front lower ball joint.

9. REMOVE FRONT AXLE ASSEMBLY LH (See page AH-6)

10. REMOVE FRONT NO. 1 WHEEL BEARING DUST DEFLECTOR LH (See page AH-5)

11. REMOVE FRONT LOWER BALL JOINT ASSEMBLY LH

- Remove the clip and the castle nuts.
- Using SST, remove the lower ball joint front.

SST 09611-36020

NOTICE:

- Do not damage the steering knuckle.
- Securely hang SST to the spacer of the steering knuckle.
- Replace the steering knuckle with a new one if the spacer comes off the steering knuckle.

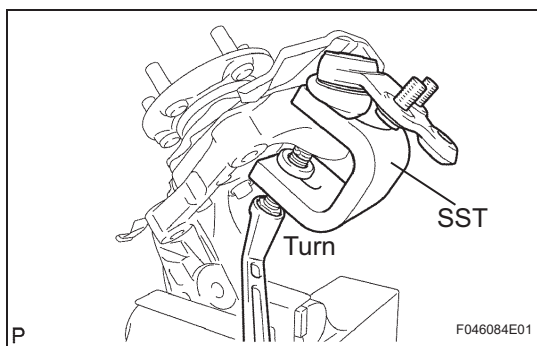
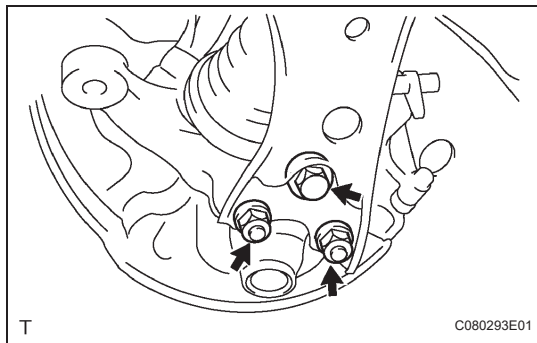

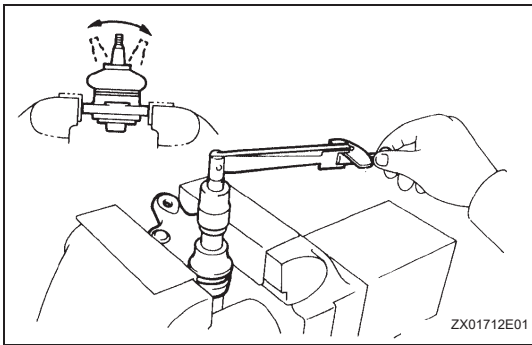

INSPECTION

1. INSPECT FRONT LOWER BALL JOINT ASSEMBLY LH

- (a) Flip the ball joint stud back and forth 5 times as shown in the illustration before installing the nut.
- (b) Use a torque wrench to turn the nut continuously at a rate of 3 to 5 seconds per turn. Take the torque reading on the fifth turn.
Torque: 0.98 to 4.90 N*m (10 to 50 kgf*cm, 8.7 to 43 in.*lbf)
- (c) Check the dust boots for cracks or grease leakage. If the value is not within the specified range, replace the lower ball joint with a new one.

INSTALLATION

HINT:

- Use the same procedures for the RH side and LH side.
- The procedures listed below are for the LH side.

1. INSTALL FRONT LOWER BALL JOINT ASSEMBLY

- (a) Install the lower ball joint front LH to the steering knuckle with the castle nuts.

NOTICE:

Ensure that the thread and taper are free of oil, etc.

Torque: 71 N*m (724 kgf*cm, 52 ft.*lbf)

NOTICE:

Further tighten the nut up to 60° if the holes for the cotter pin are not aligned.

- (b) Install a new clip to the steering knuckle.

2. INSTALL FRONT NO. 1 WHEEL BEARING DUST DEFLECTOR LH (See page [AH-6](#))

3. INSTALL FRONT AXLE ASSEMBLY LH (See page [AH-6](#))

4. CONNECT FRONT SUSPENSION LOWER NO. 1 ARM SUB-ASSEMBLY LH

- (a) Lower the front suspension lower No. 1 arm and install the lower ball joint front to the front suspension lower No. 1 arm with the bolt and 2 nuts.

Torque: 89 N*m (908 kgf*cm, 66 ft.*lbf)

5. CONNECT NO. 2 TIE ROD END SUB-ASSEMBLY (See page [PS-55](#))

6. INSTALL FRONT DISC (See page [BR-43](#))

7. CONNECT FRONT DISC BRAKE CALIPER ASSEMBLY LH (See page [BR-45](#))

8. INSTALL FRONT SPEED SENSOR LH (See page [BC-218](#))

9. INSTALL FRONT AXLE HUB NUT LH (See page [AH-7](#))

10. INSTALL FRONT WHEEL

Torque: 103 N*m (1,050 kgf*cm, 76 ft.*lbf)

11. INSPECT AND ADJUST FRONT WHEEL ALIGNMENT

- (a) Inspect and adjust the front wheel alignment (see page [SP-2](#)).

12. CHECK SPEED SENSOR SIGNAL

- (a) Check the speed sensor signal (see page [BC-37](#)).

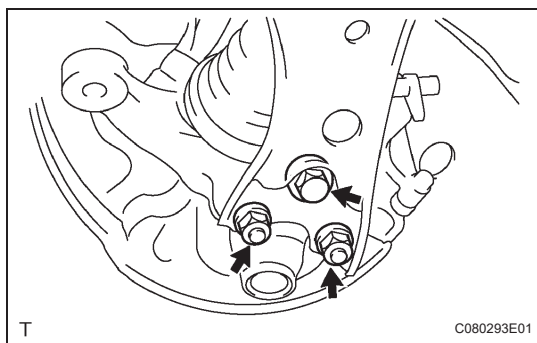

FRONT STABILIZER BAR

COMPONENTS

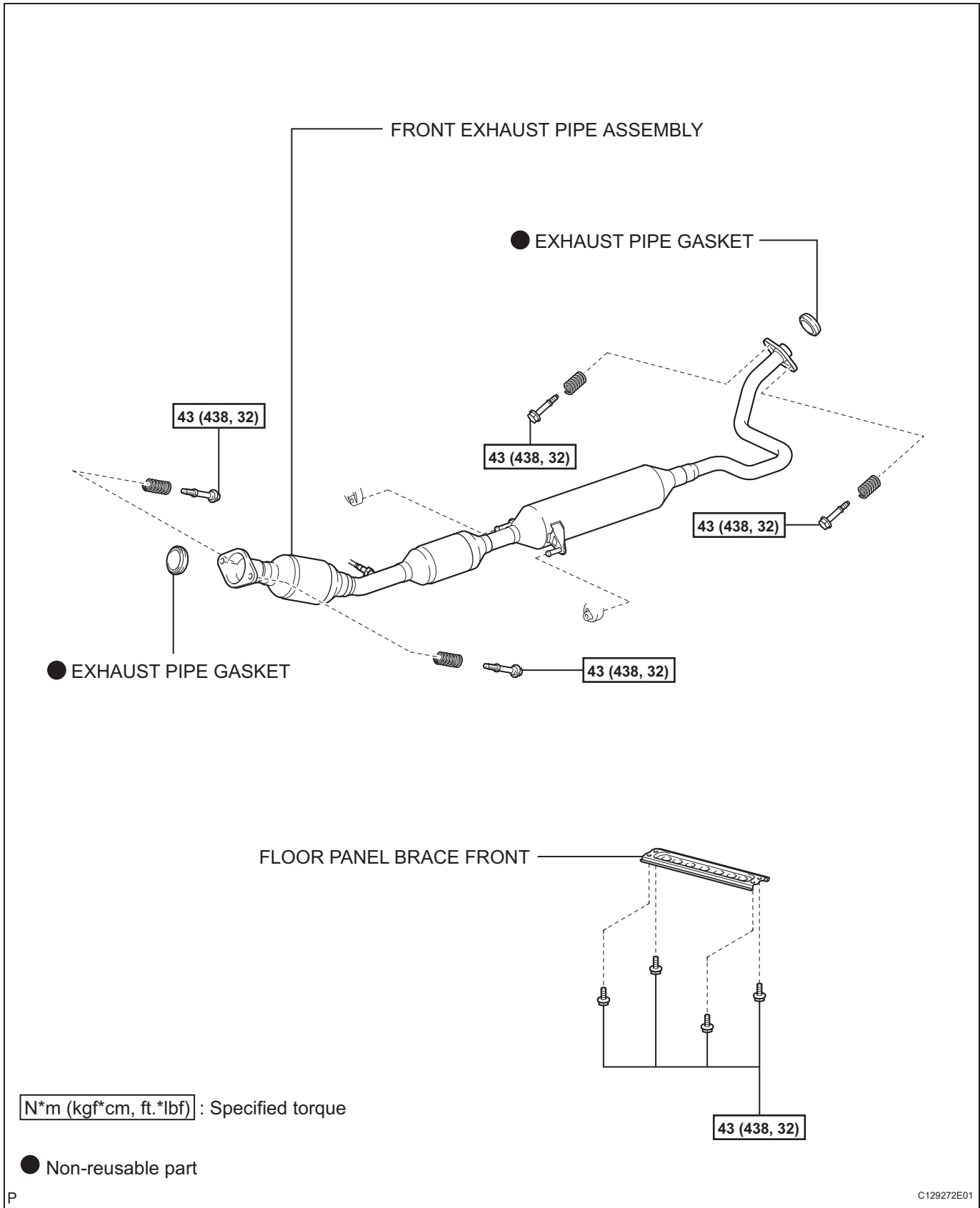

SP

$N \cdot m$ (kgf \cdot cm, ft. \cdot lbf) : Specified torque

● Non-reusable part

P

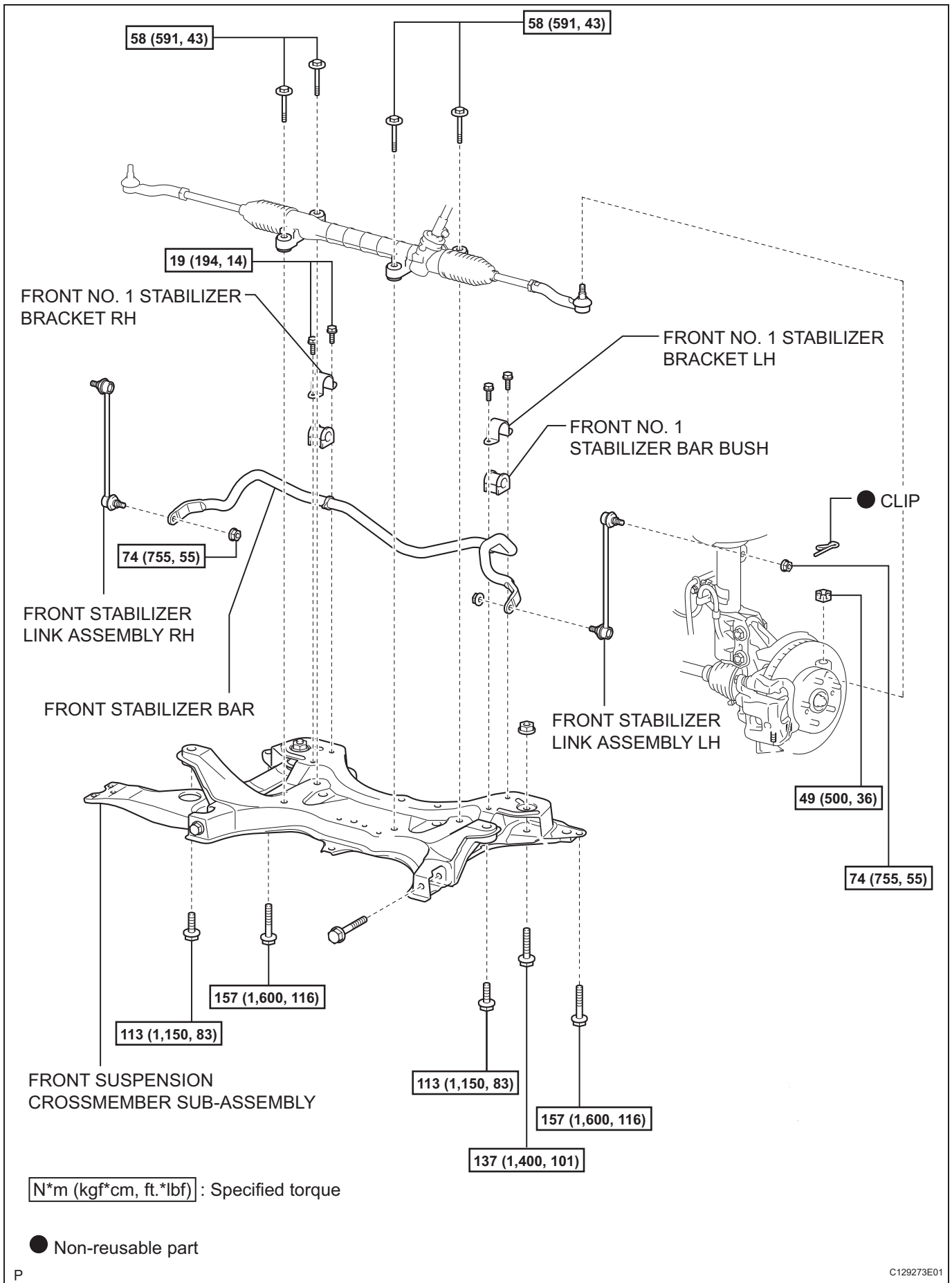

SP

REMOVAL

1. PLACE FRONT WHEELS FACING STRAIGHT AHEAD
2. REMOVE COLUMN HOLE COVER SILENCER SHEET (See page [SR-10](#))
3. DISCONNECT STEERING SLIDING YOKE SUB-ASSEMBLY (See page [PS-50](#))
4. DISCONNECT NO. 1 STEERING COLUMN HOLE COVER SUB-ASSEMBLY (See page [PS-50](#))
5. REMOVE FRONT WHEEL
6. REMOVE FRONT STABILIZER LINK ASSEMBLY LH
 - (a) Remove the 2 nuts and front stabilizer link LH.
HINT:
Use a 6 mm hexagon wrench to hold the stud if the ball joint turns together with the nut.
7. DISCONNECT NO. 2 TIE ROD END SUB-ASSEMBLY (See page [DS-6](#))
8. DISCONNECT NO. 1 TIE ROD END SUB-ASSEMBLY (See page [PS-50](#))
9. REMOVE FLOOR PANEL BRACE FRONT (See page [EX-2](#))
10. REMOVE FRONT EXHAUST PIPE ASSEMBLY (See page [EX-2](#))
11. DISCONNECT FRONT NO. 1 STABILIZER BRACKET LH
 - (a) Remove the 2 bolts and the No. 1 stabilizer bracket from the front suspension crossmember.
12. DISCONNECT FRONT NO. 1 STABILIZER BRACKET RH

HINT:
Remove the RH side following the same procedures as the LH side.
13. REMOVE STEERING INTERMEDIATE SHAFT (See page [PS-51](#))
14. REMOVE NO. 1 STEERING COLUMN HOLE COVER SUB-ASSEMBLY
15. REMOVE STEERING GEAR ASSEMBLY (See page [PS-51](#))
16. REMOVE FRONT NO. 1 STABILIZER BAR BUSH
 - (a) Remove the 2 front No. 1 stabilizer bar bushes from the stabilizer bar.
17. REMOVE FRONT STABILIZER BAR
 - (a) Remove the front stabilizer bar from the right side of the vehicle.

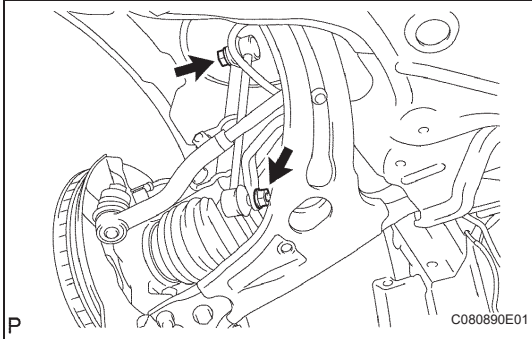

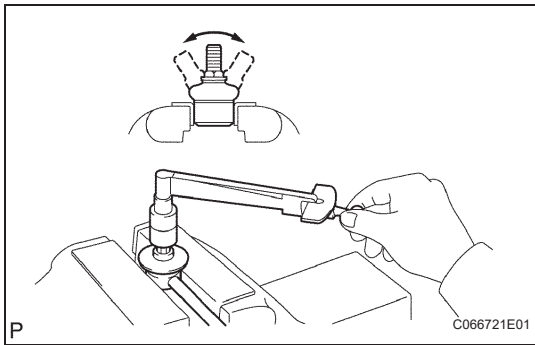

INSPECTION

1. INSPECT FRONT STABILIZER LINK ASSEMBLY

- Flip the ball joint stud back and forth 5 times as shown in the illustration before installing the nut.
- Use a torque wrench to turn the nut continuously at a rate of 2 to 4 seconds per turn. Take the torque reading on the fifth turn.

Torque: 0.05 to 1.96 N*m (0.5 to 20 kgf*cm, 0.4 to 17.4 in.*lbf)

- Check the dust cover for cracks or grease leakage. If the value is not within the specified range, replace the front stabilizer link with a new one.

INSTALLATION

1. INSTALL FRONT STABILIZER BAR

- (a) Insert the front stabilizer bar from the right side of the vehicle.

2. INSTALL FRONT NO. 1 STABILIZER BAR BUSH

- (a) Install the bush to the outer side of the bush stopper on the stabilizer bar.

NOTICE:

- Place the cutout of the stabilizer bush facing the rear side.
- Ensure the right and left deviation of the stabilizer bar is 5 mm (0.20 in.) or less.

3. INSTALL STEERING GEAR ASSEMBLY (See page PS-54)

4. INSTALL NO. 1 STEERING COLUMN HOLE COVER SUB-ASSEMBLY (See page PS-55)

5. INSTALL STEERING INTERMEDIATE SHAFT (See page PS-55)

6. CONNECT FRONT NO. 1 STABILIZER BRACKET LH

- (a) Install the No. 1 stabilizer bracket the front suspension crossmember with the 2 bolts.

Torque: 19 N*m (194 kgf*cm, 14 ft.*lbf)

7. CONNECT FRONT NO. 1 STABILIZER BRACKET RH

HINT:

Install the RH side following the same procedures as the LH side.

8. INSTALL FRONT EXHAUST PIPE ASSEMBLY (See page EX-3)

9. INSTALL FLOOR PANEL BRACE FRONT (See page EX-4)

10. INSTALL FRONT STABILIZER LINK ASSEMBLY LH

- (a) Install the front stabilizer link LH with the 2 nuts.

Torque: 74 N*m (755 kgf*cm, 55 ft.*lbf)

HINT:

Use a 6 mm hexagon wrench to hold the stud if the ball joint turns together with the nut.

11. INSTALL NO. 2 TIE ROD END SUB-ASSEMBLY (See page PS-55)

12. INSTALL NO. 1 TIE ROD END SUB-ASSEMBLY (See page DS-16)

13. INSTALL FRONT WHEEL

Torque: 103 N*m (1,050 kgf*cm, 76 ft.*lbf)

14. INSPECT AND ADJUST FRONT WHEEL ALIGNMENT

- (a) Inspect and adjust the front wheel alignment (see page SP-2).

